



Radnor Township Cemetery Directory

4156 Radnor Road, Radnor Township, Delaware County, Ohio, 43066

Index: [Page 2](#) ~ Cemetery Map layout and Cemetery Lot layout

[Page 3](#) ~ Begins Alphabetical Directory by last name. Each letter has it's own TAB of pages found at the bottom of the page. Click on the TAB for the letter you are searching

Reading the Directory found on [page 2](#):

Lot # is for cemetery use only, all lots are color coded with different colors, see the Cemetery Map Layout

Section names are abbreviated, for example E=East, H=Hilltop as noted on the Cemetery Map [Key](#)

Lot layout found on [page 2](#):

ALL section **ROWS** run West to East and start with R1 (row 1), R2, etc.

ALL section **GRAVES** run North to South and start with G1 (grave 1), G2 etc.

(Example: Letter A Tab for Ackley, Lot #334, Section (HE Hilltop East, Row-Grave, Row 8, Grave 15,

Last name: Ackley First: Bernice Date of birth death: 1902-1986 Military Service if any)

Military Service Key: Rev War=Revolutionary War, 812=War of 1812, Sp-Am=Spanish American
Mex-Am=Mexican American, CW=Civil War, WWI=World War 1, WWII=World War 2, K=Korea V=Vietnam, I=Iraq

With permission from the Radnor Township Trustees
Cemetery read and transcribed by the Radnor Heritage Society and Radnor community volunteers

Questions or to report errors, corrections or omissions contact: RadnorHeritageSocietyInc@gmail.com

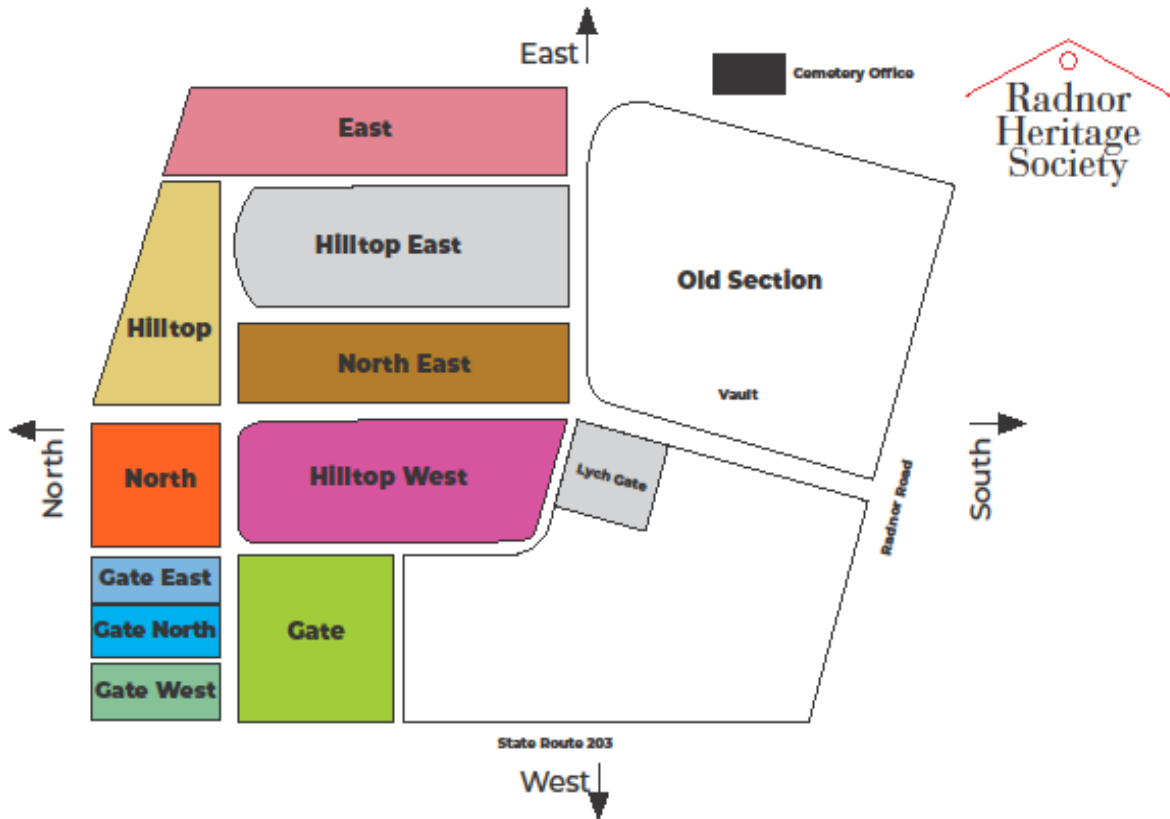

Cemetery Map Key

- East
- Hilltop East
- Hilltop
- North East
- North
- Hilltop West
- Gate East
- Gate North
- Gate West
- Gate
- Old Section
- Lych Gate

Lot Layout

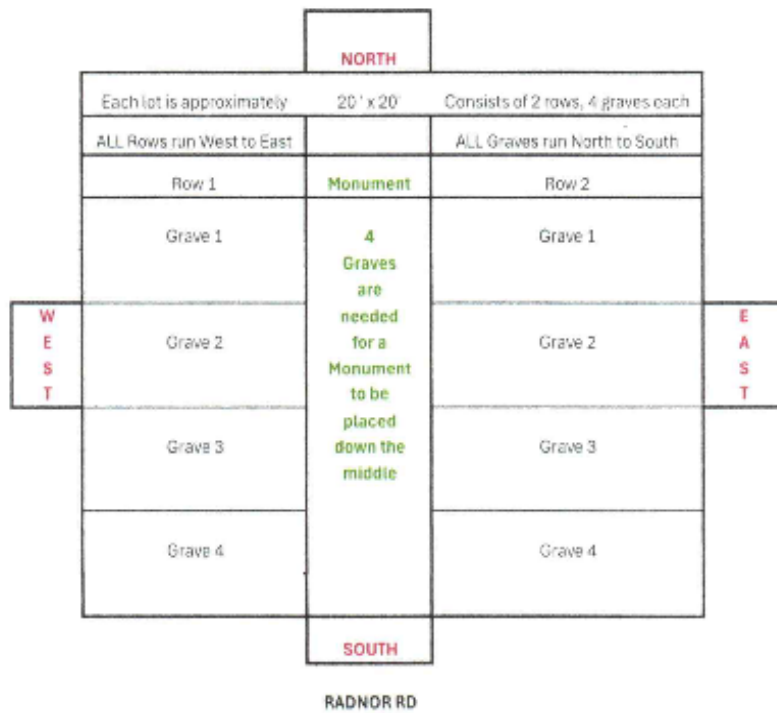

LOT #	SECTION, ROW, GRAVE	LAST	FIRST	DATES	MILITARY
334	HW R8 G15	Ackley	Bernice	1902-1986	
334	HW R8 G16	Ackley	Huston	1903-1981	
65	HE R1 G39	Adams	Frank L (CR)	1865-1945	
65	HE R1 G40	Adams	Mary Thurness (CR)	1902-1995	
65	HE R1 G39	Adams	Nellie M(CR)	1867-1930	
65	HE R1 G40	Adams	Robert Simion (CR)	1897-1950	
432	N R6 G14	Aldridge	Melody	1905 - 1991	
17	GN R20 G29	Aleshire	Deborah Chaffin	1956-2023	
182	NE R1 G12	Aleshire	Helen Chaney	1905-1988	
17	GN R7 G30	Aleshire	Richard		
156	HE R12 G54	Alexander	Hilda Prichard	1891-1970	
156	HE R12 G53	Alexander	Orba Charles	1893-1973	
372	HW R11 G6	Allen	Chester O	1867-1915	
372	HW R11 G5	Allen	Kathryn Meals	1877-unknown	
283	HW R4 G4	Allen	Paul (infant)		
296	HW R2 G32	Allison	Nellie P	1909-1969	
296	HW R2 G31	Allison	Thomas A	1899-1980	
39	H R5 G15	Anderson	Daisy Griffiths	1881-1956	
39	H R6 G14	Anderson	Edith S Dodds (CR)	1893-1974	
39	H R6 G13	Anderson	Forest Lee	1884-1959	
403	LG R11 G5	Anderson	Gladys W Troutman	1908-1996	

39	H R5 G16	Anderson	John David	1879-1943	
39	H R5 G13	ANDERSON	LARGE	MONUMENT	
403	LG R11 G6	Anderson	Lawrence D	1906-1981	
39	H R6 G15	Anderson	Mary A Henderlong	1849-1924	
39	H R5 G14	Anderson	Samuel J	1881-19901	
39	H R6 G16	Anderson	William Henry	1848-1909	SP AM - grave marker ordered
425	N R2 G26	Arnold	Donald D	11 Apr 1968 -	
425	N R1 G26	Arnold	Harold	1931-2008	K
425	N R2 G25	Arnold	Helen Estille	1903-1987	
425	N R1 G25	Arnold	Nancy K	1938-2011	
318	LG R6 G5	Atkins	Margaret Humphreys	1900 - 1939	
290	HW R1 G19	Atkinson	Jane	1988-1961	
58B	G R20 G1	Avey	Caroline Morris	1923-2021	
58B	G R19 G1	Avey	Daniel	1949-2010	
330	HW R7 G6	Avey	Ervin J	1906-1964	
330	HW R7 G5	Avey	Grace	1904-1986	
330	HW R8 G1	Avey	Mary Swearingen	1935-2025	
330	HW R8 G6	Avey	Norman	1934-1986	Firefighter
58B	G R20 G2	Avey	Richard Jonas	1923-2008	WWII

LOT #	SECTION, ROW, GRAVE	LAST	FIRST	DATES	MILITARY
429	N R9 G4	Bailey	Claude S	Died 15 Sep 1985	
34B	G R23 G11	Bailey	Nancy J	1955-2020	
429	N R8 G4	Bailey	Stephen E (CR)	1954-2011	
429	N R9 G3	Bailey	Viola L	Died 23 Jan 2018	
44	H R8 G21	Baird	Esther Harmon	1916-1970	
299	HW R4 G34	Baker	Abraham D	1876-1948	
39B	G R13 G9	Baker	Alvin "Bill"	1934-2002	K
293	HW R4 G58	Baker	Bessie	1909-1968	
130	GW R2 G3	Baker	Brian Lee	1953-2000	V
451	N R11 G22	Baker	Charles D	1961-1990	USAF
122	HE R8 G54	Baker	Frank G (F G)	1856-1900	SP-AM
355	HW R6 G57	Baker	Frank J	1861-1936	
122	HE R8 G52	Baker	infant		
293	HW R4 G24	Baker	Irvin P	1898-1958	
299	HW R4 G33	Baker	Katherine	1880-1961	
122	HE R8 G55	Baker	Lura Fay	1894-1914	
355	HW R5 G60	Baker	Margaret	1862-1935	
355	HW R5 G59	Baker	Miles	1856-1935	
451	N R12 G21	Baker	Patricia M	1936-1997	

451	N R12 G22	Baker	Ralph H	1932-1984	K
227	E R2 G14	Balderson	Dorothy E Spain	1912-1983	
227	E R1 G13	Balderson	Ernest O	1893-1915	
227	E R1 G15	Balderson	John Morgan	1864-1952	
227	E R1 G14	Balderson	Nancy A Mays	1872-1956	
227	E R2 G15	Balderson	William Harold	1908-2000	WWII
446	N R11 G15	Barger	Gladys Gray	1917-1980	
446	N R11 G14	Barger	James Robert	1917-1984	WWII
129	GW R1 G7	Bargo	Claudine	1944-2014	
129	GW R1 G8	Bargo	Haston	1944-2006	
334	HW R7 G16	Barnes	Harold	1923-1995	
54B	G R22 G5	Barnes	Helen Boehm	1925-2022	
54B	G R21 G6	Barnes	Herbert A	1953-2016	
54B	G R22 G6	Barnes	Paul Everett	1923-2005	WWII
334	HW R7 G15	Barnes	Wahneta	1926-2011	
224	E R2 G12	Barrett	Beatrice E Hylton	1908-1990	
224	E R1 G12	Barrett	Earl Thomas	1910-1984	
327	HW R6 G4	Bass	Amy E	1882-1972	
327	HW R5 G3	Bass	Effie	1921-1999	
327	HW R6 G3	Bass	Jesse	1888-1960	
327	HW R5 G4	Bass	William C	1912-1998	

41B	G R9 G12	Bauerle	Don (CR)	1919-1991	WWII
41B	G R9 G11	Bauerle	Helen	1932-2022	K
7B	G R15 G21	Bauman	Arthur M (CR)	1920-2007	
7B	G R15 G22	Bauman	Mary Lou (CR)	1921-2002	
7B	G R16 G24	Bauman	Pamela Sue (CR)	1947-008	
7B	G R16 G23	Bauman	Patricia (CR)	1941-2010	
420	N R3 G13	Baxter	Betty	1924-2016	
249	E R3 G42	Baxter	Bryan A	1933-2023	K
206	NE R7 G17	Baxter	Everett	1907-1993	
252	E R3 G46	Baxter	Irma L	1938 - 1979	
206	NE R7 G15	Baxter	Jeanette J	1930 - 1930	
252	E R3 G45	Baxter	Jimmie Lee	1939-2020	
206	NE R7 G16	Baxter	Leona	1911-1992	
249	E R3 G41	Baxter	Luretta A Patrick	1938-2017	
206	NE R8 G14	Baxter	Mary E	1873-1969	
206	NE R8 G16	Baxter	Mary Roberta	1912-1912	
420	N R3 G14	Baxter	Odus C	1921-1995	WWII
96A	GW R3 G20	Baxter	Terrance "Terry"	1956-2025	
24B	G R6 G13	Beck	Mildred	21 Sep 1917-7 Sep 2003	
381	HW R10 G26	Beech	Carrie	1882-1955	
381	HW R10 G25	Beech	Edwin	1882-1954	

6B	G R13 G22	Bell	Darwin	12 Feb 1915-25 Jun 1985	
6B	G R13 G21	Bell	Esther	21 Apr 1916-9 Dec 1998	
407	LG R12 G16	Belt	Barbara E Morrison	1915-2003	
409	LG R11 G17	Belt	Barney Earl	1938-2009	
409	LG R12 G17	Belt	Ralph Malone	1914-2006	
137	HE R9 G22	Berry	Elizabeth Osborn	1857 - 1932	
137	HE R9 G21	Berry	Wm H	1854 - 1913	
6	H R4 G11	Bevan	Mary	1838 - 1925	
416	N R3 G5	Biddle	Cleo F James	1907-2003	
263	E R1 G61	Biggerstaff	Charles	1892-1855	
263	E R1 G63	Biggerstaff	George M	1858-1953	
263	E R1 G62	Biggerstaff	Margaret E "Nellie" Hughes	1892-1929	
263	E R1 G64	Biggerstaff	Ray	1896-1955	
331	HW R5 G9	Biggerstaff	Sarah	1907-1996	
210	NE R8 G18	Biles	Addie Tribbett	1863 - 1917	
210	NE R8 G19	Biles	Fleming G	1860 - 1914	
421	N R2 G17	Bill	Edith	1920-1983	
237	E R4 G23	Bill	Florence V Standley	1869-1956	
421	N R2 G18	Bill	Wilbert Stanley	1928-1973	
237	E R4 G24	Bill	William Henry	1858-1937	
15B	G R18 G7	Birchfield	Barbara	1940-2013	

339	HW R6 G26	Birchfield	Charles Robert	1941-1971	
8B	G R18 G1	Birchfield	Joe D	1958-1985	
15B	G R18 G8	Birchfield	Richard N	2 Jun 1942 -	
236	E R2 G26	Bishop	Della J Penry	1888-1981	
236	E R2 G27	Bishop	Jesse R	1891-1966	
421	N R1 G18	Bishop	Loyd	1914-1971	
36	GE R8 G21	Bishop	Martha "Kay" Bumgartner	1946-2017	
421	N R1 G17	Bishop	Mary	1917-2014	
36	GE R8 G22	Bishop	Tim	1943 -	
18B	G R11 G17	Blackburn	Phyllis	1956 - 2012	
118	GW R2 G14	Blanton	Keith	1959-2017	
408	LG R13 G13	Boatman	Cheryl L	1948 - 2015	
408	LG R13 G14	Boatman	Howard	1940 -	
27B	G R11 G15	Boehm	Geneva M	1935-2025	
27B	G R11 G16	Boehm	Harold F	26 Aug 1929-15 Jan 2016	K
297	HW R4 G29	Boggess	Eunice Stiffler	1909-1951	
392	HW R11 G47	Bonnette	Ethel Gertrude Timm	1891-1962	
392	HW R11 G48	Bonnette	Everard Earl	1882-1956	
37B	G R18 G9	Borden	Jean Marie Knapp	1952-2024	
23B	G R3 G14	Boring	Dorothy E	22 Jun 1914-17 Oct 2004	
23B	G R3 G13	Boring	Virgil	23 Feb 1910-26 Dec 1998	

352	HW R8 G49	Bosh	C Viola	1907-1988	
169	HE R4 G1	Bosh	Carrie	1880 - 1910	
446	N R12 G12	Bosh	Connie (CR)		
170	HE R5 G2	Bosh Sr	Frederick H	1916 - 1994	WWII
446	N R12 G13	Bosh	James D	1932-2009	US Army Veteran
169	HE R3 G3	Bosh	Leon Reading	1899 - 1902	
352	HW R8 G50	Bosh	Lloyd	1902-1960	
169	HE R3 G2	Bosh	Marion Virgil	1909-1909	No grave marker
325	LG R4 G21	Bosh	Mary Faye (CR)	1916-2004	
446	N R12 G12	Bosh	Marylou	1930-2013	
352	HW R7 G49	Bosh	Michael A	1961-2003	IRAQ
170	HE R5 G1	Bosh	Minnie A	1874-1907	
170	HE R6 G3	Bosh	Robert J	1911 - 1940	
170	HE R6 G2	Bosh	William Victor	1913-1972	
325	LG R4 G22	Bosh Jr	Frederick H	1916 - 1994	WWII
4	H R3 G5	Bovey	Ethel M	1899-1928	
4	H R3 G6	Bovey	Pearl	1885-1960	
22	H R3 G44	Bowman	Myron William	1944-2017	
332	HW R7 G9	Boyer	David	1943-1978	
332	HW R8 G10	Boyer	Dorothea	1914-1993	
65	HE R1 G17	Boyer	infant		

213	NE R13 G9	Boyer	Mary E	1883-1925	
332	HW R7 G10	Boyer	Ronald	1948-2011	
332	HW R8 G9	Boyer	Walter	1913-1964	
292	HW R1 G24	Bradbury	Faye Neal Thomas	1882-1961	
292	HW R1 G23	Bradbury	Rev John Harvey	1880-1968	
23B	G R4 G13	Bradford	Helen G	1 May 1939-3 July 2013	
23B	G R4 G14	Bradford	Norman C	16 Sep 1937-1 Jun 2014	WWII
287	HW R4 G9	Bradley	Culver	1902-1968	
287	HW R4 G10	Bradley	Eva Wright	1906-1998	
93	GW R10 G17	Brady	Barbara	1968-2019	
93	GW R10 G18	Brady	Jeffrey	1961 -	
92	GW R12 G14	Bree	Charles	1933-2023	K
92	GW R12 G13	Bree	Regina	1936-2025	
266	E R1 G66	Brocklesby	Frank	1886-1939	
266	E R1 G68	Brocklesby	Lee Roy	1916-1978	WW II
266	E R1 G65	Brocklesby	M Elizabeth	1891-1927	
266	E R2 G66	Brocklesby	Peggy Rena	1941-1941	
266	E R1 G67	Brocklesby	Raymond D	1922-1949	WW II
127	HE R5 G65	Brown	Arthur N	1845 - 1888	
29B	G R16 G14	Brown	John Robert	1912-1990	
29B	G R16 G13	Brown	Lillian Andrews	1916-2000	

244	E R6 G31	Brown	Virginia L Crowe	1925-1993	
227	E R1 G16	Browning	Murley J Balderson	1900-1969	
207	NE R1 G22	Buchanan	Bessie M Staley	1892 - 1962	
411	LG R11 G21	Buchanan	Catherine Lorene	1943-1943	
130	GW R2 G4	Buchanan	Dorothy Fay	1929-2014	
207	NE R1 G21	Buchanan	Fred	1882 - 1965	
207	NE R2 G21	Buchanan	Homer	1905-1986	WWII
411	LG R11 G22	Buchanan	Lewis	1891-1965	
207	NE R2 G22	Buchanan	Lydia		
47B	G R8 G5	Buckingham	George J	6 Jul 1945 -	
47B	G R8 G6	Buckingham	Peggy A	29 May 1940-29 Sep 2016	
142	HE R11 G27	Bumgarner	Bessie M Durfey	1897 - 1974	
142	HE R11 G28	Bumgarner	Emma Jean Morris	1921 - 2010	
142	HE R11 G26	Bumgarner	Okey Lawrence	1894 - 1948	
142	HE R12 G28	Bumgarner	Otis Earl	1918-2000	WWI
142	HE R12 G25	Bumgarner	Ruth Delight	1920-1920	
142	HE R12 G25	Bumgarner	Rose Marie	died 1925	
431	N R8 G7	Burch	Esther L	1908-2006	
431	N R8 G8	Burch	Robert A	1916-1998	
440	N R11 G4	Burdette	Brian C	1960-1991	Veteran
440	N R11 G3	Burdette	Mary M	1932-2006	

440	N R11 G2	Burdette	Rex C	1931-2000	
440	N R13 G4	Burgess	A Michael	1962-2017	
440	N R13 G3	Burgess	Barbara L	26 Sep 1964-	
373	HW R10 G10	Burgess	Beverly K Taylor	27 May 1937-	
373	HW R10 G9	Burgess	Frederick S	1931-2000	
374	HW R11 G9	Burgess	Gregory	1959-1959	
26	H R3 G49	Burgner	Elizabeth A	1851 - 1884	
26	H R4 G49	Burgner	Margaret A Griffiths	1840-1905	
26	H R3 G52	Burgner	Mary A Griffiths	died 28 Feb 1880	
26	H R3 G51	Burgner	Mary Ann Needles	1821-1856	
26	H R3 G50	Burgner	Mary E	1855-1856	
26	H R4 G51	BURGNER	MONUMENT	IN THE CENTER	
26	H R4 G50	Burgner	William	1826-1900	
94	HE R3 G63	Burke	Elton Austin	1870 - 1948	
94	HE R3 G62	Burke	Mildred J	1876 - 1943	
27B	G R11 G13	Busbey	Karen Mossberger	16 Mar 1954-20 Apr 2002	
27B	G R11 G14	Busbey	Rev Frank J	1951 -	
231	E R3 G15	Busch	Genevieve Lethog	1923-2009	
231	E R3 G16	Busch	Willard Grant	1919-1982	WWII
292	HW R1 G21	Bush	Florence	1902-	
292	HW R1 G22	Bush	George	1901-1969	

37B	G R17 G13	Butts	Charles E	1925-2015	WWII
193	NE R6 13	Butts	Elward F	1907-1976	
193	NE R6 14	Butts	Joanne	1932-1933	
37B	G R17 G14	Butts	Nancy A	1937-1991	
248	E R1 G41	Byerly	Elsie J	1906-1976	
248	E R1 G42	Byerly	Harold D	1891-1962	
390	HW R11 G44	Byus	Doris M	1917-1996	
390	HW R11 G43	Byus	Theodore B	1917-1993	

LOT #	SECTION, ROW, GRAVE	LAST	FIRST	DATES	MILITARY
201	NE R21 G2	Caffee	Della E Looker	1873-1950	
201	NE R21 G3	Caffee	William J	1866-1931	
262	E R6 G54	Cain	Harold Richard	died in infancy	
262	E R6 G54	Cain	Louise Caswell	died in infance	
234	E R3 G19	Caldwell	Anna Mae	1921-2007	
234	E R3 G20	Caldwell	Joe 'Junior'	1923-1998	WWII
301	HW R3 G37	Camp	Alice C	1989-1962	
343	HW R6 G35	Camp	Ethel	1900-1996	
343	HW R6 G36	Camp	Howard	1889-1976	WWII
301	HW R3 G38	Camp	Raymond O	1887-1962	
122	HE R7 G53	Campbell	Mary E McDonald	1837-1904	
122	HE R7 G54	Campbell	Rev Andrew Jackson	1835 - 1905	
377	HW R10 G19	Carnes	Bessie Marilda Barber	1885-1970	
377	HW R10 G20	Carnes	Flavis Randolph	1885-1962	
331	HW R5 G12	Carpenter	Anna	1905-1988	
42B	G R8 G9	Carroll	Eleanor Jane	1924-1996	
42B	G R8 G10	Carroll	Stanton E	1925-1993	K
7B	G R15 G24	Carter	Eula Ritchie	1931-2004	
295	HW R3 G27	Carter	Landon	1883-1962	
7B	G R15 G23	Carter	Paul Edgar	1926-1992	WWII

36B	G R19 G12	Carver	Wilmer R	1917-1994	
139	HE R9 G26	Case	Eva Darst	1858 - 1920	
139	HE R9 G27	Case	Sylvester C	1859 - 1905	
235	E R6 G19	Casey	Bessie	1927-2014	
235	E R6 G20	Casey	Robert	1920-2001	
446	N R12 G15	Casto	Allen Edward (CR)	1939-1999	
53B	G R20 G8	Casto	Belva June Taylor	1937-2013	
447	N R11 G15	Casto	Elena Grace Sayre	1911-1989	
447	N R11 G16	Casto	Rufus Hoyt	1910-1974	
286	HW R2 G11	Caudill	Michael	1974-1990	
52	GW R8 G26	Cawley	Charlotte	1937-2022	
292	HW R2 G22	Cawley	Forest E	1914-2005	
292	HW R2 G21	Cawley	M Evelyn	1916-1969	
8	GN R7 G35	Chaffin	Leonard	1926-2014	
8	GN R7 G34	Chaffin	Lillian	1927-2012	
387	HW R9 G37	Chaney	Arthur (CR)	1865-1949	
110	GN R8 G3	Chaney	Billie Jean Barry	1931-2016	
182	NE R1 G10	Chaney	Daisy Alice	1880-1968	
110	GN R8 G2	Chaney	Elvin "Bob" (CR)	1925-2018	WWII
418	N R2 G9	Chaney	Hazel	1899-1977	
296	HW R1 G31	Chaney	Lottie	1875-1974	

182	NE R1 G9	Chaney	Maude	1912-1390	
182	NE R2 G9	Chaney	Raymond	1903-1989	WWII
182	NE R1 G11	Chaney	Robert H	1875-1944	
56B	G R23 G2	Chaney	Vivian M (CR)	1927-1999	
264	E R3 G62	Chaney	William Robert	1907-1976	
56B	G R23 G1	Chaney Jr	Henry L	1920-1986	WWII
418	N R2 G10	Chaney Sr.	Henry L	1897-1978	
249	E R4 G40	Chapman	Wesley (CR)	and 1 other infant (CR)	
122	HE R8 G53	Charles	Florence Dora Campbell	1864-1945	
52B	G R17 G5	Cicolino	Carol Ann Linscott	1943-2018	
52B	G R17 G6	Cicolino	Joseph Anthony	1933-2001	
38B	G R15 G10	Clark	Alfred "Mack"	5 May 1947-16 Nov 2003	V
337	HW R5 G58	Clark	Ellis G	1898-1984	
38B	G R15 G11	Clark	Geneva	18 Mar 1949-6 Feb 2023	
337	HW R5 G24	Clark	Gertrude C	1905-1965	
38B	G R15 G9	Clark	Jonathon	Infant	
38B	G R15 G9	Clark	Kimberly (CR)	daughter of Geneva & Alfred	
62	GE R7 G14	Claypool	Kayleigh	1996 2003	
28	GW R13 G29	Clements	Jessica	1947 -	
28	GW R13 G30	Clements	Roger A	1948-2014	V
25B	G R8 G14	Clevenger	Harry A	1926-2016	WWII

25B	G R8 G13	Clevenger	Rosalee	1927-2020	
22B	G R4 G19	Clevenger	Amy Lynn (CR)	25 Dec 1973-13 Sep 2017	
22B	G R4 G20	Clevenger III	Harry	4 Mar 1953-11 May 2017	
343	HW R5 G36	Coffindaffer	Dale E	1909-1975	
343	HW R5 G35	Coffindaffer	Dane L	1920-1969	
429	N R10 G2	Coffindaffer	John K	1948 -1975	
192	NE R4 G13	Collins	Harry L		
192	NE R4 G12	Collins	Mary Ingle		
3	H R2 G6	Cone	John A	1836-1910	CW
85	HE R2 G43	Cone	John Weber	1809 - 1891	
65	HE R1 G43	CONE	LARGE	MONUMENT	
3	H R2 G7	Cone	Mary E	1841-1912	
85	HE R2 G42	Cone	Mary Williams	1814 - 1885	
85	HE R2 G41	Cone	Nelson W	1833 - 1886	CW
3	H R2 G8	Cone	Stella G	1872-1917	
86	HE R3 G46	Cone	George Ann	1853-1923	
86	HE R3 G47	Cone	William J	1851 - 1933	CW
288	HW R1 G15	Congrove	Alice	1927-2010	
288	HW R1 G13	Congrove	Bessie V Sisson	1903-1994	
288	HW R2 G13	Congrove	Esther V Seitter	1933-1966	
288	HW R1 G14	Congrove	Sherry Lee	1899-1986	

288	HW R2 G14	Congrove	Sherry Warren " Dick"	1925-1982	
272	E R2 G75	Conklin	Anna E Kientz	1870-1957	
272	E R2 G76	Conklin	Charles Fremont	1863-1930	
171	HE R8 G1	Conley	Mattie	NO MARKER	
26	H R3 G53	Connelly	Emma Burgner	1858 - 1883	
44B	G R4 G10	Cook	Helen	13 Sep 1914-2 Oct 1997	
124	HE R7 G58	Coonfare	Augusta Griffith	1883-1955	
146	HE R11 G35	Coonfare	Clara Stammer	1900-1988	
146	HE R11 G33	Coonfare	Clyde C	1883-1965	
326	LG R5 G22	Coonfare	Clyde Richard	1928-2018	K
146	HE R11 G34	Coonfare	Edna E	1881-1973	
326	LG R5 G21	Coonfare	Elizabeth E	1928-2012	
146	HE R12 G35	Coonfare	Elizabeth Robinson	1859 - 1914	
146	HE R12 G36	Coonfare	Ephram	1856 - 1925	
254	E R1 G51	Coonfare	Frank	1866-1922	
124	HE R7 G59	Coonfare	Harry W	1875-1956	
212	NE R11 G9	Coonfare	Hazel Lloyd	1895-1934	
324	LG R6 G19	Coonfare	James Richard	1963-1963	
148	HE R12 G39	Coonfare	John Norman	1896-1953	WWI
254	E R1 G52	Coonfare	Martha Thomas		
146	HE R12 G34	Coonfare	Mary Augusta	1888-1904	

148	HE R12 G37	Coonfare	Nettie	1854-1917	
146	HE R12 G33	Coonfare	Rey lola	1881 - 1903	
148	HE R12 G38	Coonfare	Sarah Ann	1832-1904	
348	HW R8 G42	Coonfare	Sue A	16 Jun 1941-	
348	HW R8 G41	Coonfare	Ted R	16 Apr 1940-	
146	HE R11 G36	Coonfare	Ted R	1901-1991	
55	GN R1 G21	Corwin	Steven	1942-2018	
349	HW R6 G48	Cowdery	Ed	1915-1978	
349	HW R6 G47	Cowdery	Freda	1907-1969	
40B	G R12 G11	Cox	Alvin R (Rev)	1946-2020	Army Reserves
40B	G R12 G12	Cox	Beverly	1946-	
79	HE R2 G30	Cox	Catherine Rostorfer	1863-1933	
16	H R4 G30	Cox	Charlotte Luella Thurston	1857-1908	
234	E R3 G22	Cox	Chester F	1856-1948	on back of Beatrice
234	E R3 G21	Cox	Ellen Prichard	1857-1948	
79	HE R2 G32	Cox	Isabelle Frances	1821 - 1887	
16	H R4 G31	Cox	James Francis	1854-1928	
16	H R4 G32	Cox	John Thurston	died 27 Dec 1891	
16	H R4 G29	COX	LARGE	MONUMENT	
233	E R1 G22	Cox	Minnie Lewis	1863-1927	
272	E R1 G73	Cox	Myrtle M	1873-1952	

79	HE R2 G29	Cox	Prior Josephus	1857-1924	
79	HE R2 G31	Cox	Prior Jr	1826 -1906	
233	E R1 G23	Cox	Walter	1860-1941	
272	E R1 G74	Cox	William H	1866-1935	
375	HW R9 G13	Crabbe	Neville Cobblah (CR)	1923-1983	
38B	G R16 G10	Cramer	Catherine S	1950-	
38B	G R16 G9	Cramer	Charles D	1948-2022	
444	N R11 G10	Crandall	Dottie	1932 - 2016	
444	N R12 G11	Crandall	Homer Odus	1932 - 2016	NAVY
444	N R12 G11	Crandall	Mary Phillips	1904 - 1991	
388	HW R12 G39	Crigler	Anna J	1869-1946	
388	HW R12 G40	Crigler	James M	1862-1938	
422	N R4 G17	Crist	Marjorie Jean	1922-2000	
110	HE R7 G30	Cronkleton	Chester Cissero	1842 - 1917	
110	HE R7 G28	Cronkleton	Harland	1866 - 1900	
110	HE R7 G31	Cronkleton	John Truman (CR)	1881 - 1925	
110	HE R8 G31	Cronkleton	Joseph W	1874 - 1954	
110	HE R8 G28	Cronkleton	Lyman Lorenzo	1871 - 1948	
110	HE R7 G29	Cronkleton	Mary Jane Williams	1847 - 1901	
110	HE R8 G30	Cronkleton	Pearl V Piatt	1882 - 1957	
8	GN R7 G33	Cumberledge	Gary W	1944-2015	

14B	G R19 G17	Cummins	Carolyn Leasure (CR)	1946-2022	V
247	E R6 G35	Cunningham	Mary Blaine	1924 - 1994	
247	E R6 G36	Cunningham	Noel A	1917 - 1993	
374	HW R11 G12	Curtis	Clifford Leroy	1922-1990	
374	HW R11 G11	Curtis	Florence A Kerr	1928-2011	
96	HE R3 G67	Curtiss	Edward	1864 - 1935	
96	HE R3 G66	Curtiss	Henry	1814-1879	
96	HE R3 G65	Curtiss	Jane Monroe	1824-1898	
96	HE R3 G64	Curtiss	John Quincy	1857-1940	
96	HE R4 G67	CURTISS	LARGE	MONUMENT	
42	H R8 G17	Cutlip	Carol (CR)	1948-2019	

LOT #	SECTION, ROW, GRAVE	LAST	FIRST	DATES	MILITARY
301	HW R3 G40	Dailey	Dave Franklin	1871-1944	
287	HW R3 G9	Dailey	Mildred	1914-	
287	HW R3 G10	Dailey	Robert N	1914-1967	
301	HW R4 G39	Dailey	Thurman	1910-1971	
75	GW R4 G2	Damron	Donald		
75	GW R4 G19	Damron	Mary Lee Middleton	1944-2020	
75	GW R4 G21	Damron	Paul L	1948-	
75	GW R4 G20	Damron	Wanda		
446	N R12 G14	Darby	Ellen Casto (CR)	1943-2022	
4	H R3 G7	Darst	Alfred	1892-1970	
4	H R5 G52	Darst	Anna Elizabeth	1895-1909	
320	LG R6 G10	Darst	Arthur W	1871-1949	
7	H R1 G14	Darst	Charles W	1860-1937	
7	H R1 G16	Darst	Duncan P	1837-1927	
4	H R4 G7	Darst	Emery	1862-1923	
209	NE R5 G19	Darst	Estella Jones	1876-1918	
320	LG R6 G9	Darst	Eva May	1875-1940	
4	H R4 G8	Darst	Ezra H	1853-1915	
364	LG R9 G14	Darst	Frank A	1862-1942	
299	HW R3 G33	Darst	Hayes E	1885-1963	

364	LG R10 G14	Darst	Hobart Frank	1899-1986	
209	NE R5 G20	Darst	Hosea A	1874-1963	
299	HW R3 G34	Darst	Ida L	1893-1986	
4	H R4 G6	Darst	Ida May Risher	1870 - 1951	
57	H R5 G50	Darst	Isabella Campbell	1812-1882	
364	LG R9 G13	Darst	Mary Emma	1871-1947	
7	H R1 G15	Darst	Mary G	1837-1907	
364	LG R10 G13	Darst	Rose Marie	1897-1945	
57	H R5 G51	Darst	Samuel	1808-1870	
5B	G R12 G24	Daugherty	Jon Lowell	1960 - 1992	
448	N R12 G16	Davids	Avis	1906-1984	
193	NE R6 12	Davids	Freda Butts	1908-2006	
448	N R11 G17	Davids	John Edward	1933-2018	K
448	N R12 G17	Davids	Paul	1908-1995	
269	E R1 G69	Davies	Emma W	1865-1957	
269	E R1 G70	Davies	Rev John B	1858-1934	UCC
324	LG R5 G17	Davis	Alverna O	1888-1973	
76	HE R4 G25	Davis	Anna	1830 - 1908	
54	GW R11 G22	Davis	Bret A	1959 -	
67	HE R1 G54	Davis	Catherine Penry	1824-1895	
36	H R8 G8	Davis	Charles A	1878-1900	Sp Am

76	HE R3 G26	Davis	Charles E	1867 - 1913	
354	HW R8 G55	Davis	Clara Lena	1869-1940	
4B	G R10 G21	Davis	Connie Sue	1949-1996	
109	HE R6 G29	Davis	David T	1850-1923	ON BIG STONE FACING EAST
4B	G R9 G21	Davis	Donald F	1920-1995	WWII
404	LG R13 G5	Davis	Dorothy J	1928-2017	
64B	G R7 G3	Davis	Earl O	21 Jun 1920-27 Dec 1990	WWII
259	E R6 G49	Davis	Eileen (CR)	1916-1995	
148	HE R12 G40	Davis	Eliza Hattie Coonfare	1857-1921	
80	HE R4 G33	Davis	Elizabeth	1858-1926	
91	HE R2 G53	Davis	Elizabeth D Jones	1859 - 1928	
64B	G R7 G4	Davis	Erma R	27 Jun 1929-9 Jan 2004	
404	LG R14 G6	Davis	Eulola B Barnett (CR)	1903-1983	
432	N R5 G12	Davis	Everett P	1921 - 2009	
107	HE R5 G26	Davis	George N	1871-1947	
406	LG R14 G10	Davis	Guy C	1897-1985	
324	LG R5 G18	Davis	Harvey Newton	1881 - 1944	
107	HE R5 G25	Davis	Hattie Ora Phillipa	1870-1963	
36	H R8 G6	Davis	Henry H	1849-1931	
36	H R7 G8	Davis	J Lewis	1882-1964	
404	LG R14 G5	Davis	Jane L Salathe	1897-1950	

404	LG R13 G6	Davis	John Alfred	1922-2022	
91	HE R2 G56	Davis	John W	1862 - 1936	
7A	GN R5 G39	Davis	Judith	1947-2005	
259	E R6 G50	Davis	Leo A	1916-1985	
36	H R8 G5	Davis	Malinda Guss	1853-1935	
4B	G R9 G22	Davis	Margaret	1921-1994	
107	HE R5 G27	Davis	Marion	1889 - 1903	
354	HW R7 G53	Davis	Mary E	1924-	
76	HE R3 G25	Davis	Mary E Gallant	1866 - 1945	
406	LG R14 G9	Davis	Mary E Pittman	1896-1984	
36	H R7 G7	Davis	Mary Minerva Bensley	1884-1958	
91	HE R2 G55	Davis	Phoebe Williams	1861 - 1925	
354	HW R7 G54	Davis	Raymond J	1902-1972	
354	HW R7 G55	Davis	Raymond Scott	1959-1960	
76	HE R4 G26	Davis	Robert O	27 Nov 1814 - 30 Mar 1905	
80	HE R4 G34	Davis	Robert R	12 Dec 1851 - 24 Jun 1920	
137	HE R10 G22	Davis	Roxie Belle Darst	1883-1977	
54	GW R11 G21	Davis	Sarah J "Janie"	1955 -	
432	N R5 G11	Davis	Shirley J	1925 - 2001	
91	HE R2 G54	Davis	Stephen R	1861 - 1928	
354	HW R8 G56	Davis	Thomas L	1861-1935	

67	HE R1 G53	Davis	Walter	1895 - 1953	
67	HE R2 G55	Davis	William	1836 - 29 Jan 1916	CW
137	HE R10 G23	Davis	William Don	1885 - 1970	WWI
404	LG R14 G6	Davis	William J (CR)	1894-1981	
36	H R8 G7	Davis	Wm H	1891-1908	
372	HW R12 G8	Dawson	John Henry	1902-1971	
372	HW R12 G7	Dawson	Rosella	1902-1946	
37	H R6 G10	Decker	Alice I	1897-1988	
187	NE R11 G2	Decker	Arthur	1898-1867	
187	NE R11 G1	Decker	Bernice	1903-1992	
48B	G R10 G5	Decker	Lillian	1902-1983	
48B	G R10 G6	Decker	Paul E	1923-1988	
25B	G R8 G16	Decker	Richard L	31 Jan 1929-25 Apr 1989	WWII
25B	G R8 G15	Decker	Ruth E	30 Oct 1928-23 Jan 1921	
25B	G R7 G16	Decker	Stephen	infant	
37	H R6 G11	Decker Jr	Robert M	1934-1972	K
37	H R6 G9	Decker Sr	Robert M	1897-1953	WWI
178	NE R4 G4	DeGood	Ella Goodman	1861-1931	
178	NE R4 G5	DeGood	William B	1957-1931	
110	GN R8 G4	Demopolis	John F	1940-2014	Army Reserve
443	N R12 G7	Denney	Betty M	1923-2013	

443	N R12 G8	Denney	Dossel E	1940 - 2013	
443	N R11 G7	Denney	Maude M	1914 - 1997	
443	N R11 G8	Denney	Stacey N	1905-1981	
291	HW R3 G17	Dennis	Charles C	1893-1966	WWI
291	HW R3 G18	Dennis	Dortha	1903-1993	
53B	G R20 G5	Dennis	Eva Mae Nielsen	1907-1995	
53B	G R19 G5	Dennis	George T	5 May 1931-21 oct 2005	K
111	GN R3 G3	Denny Sr	Kenneth W "Doodie"	1947-2017	
345	HW R5 G38	Derr	Gladys A	1909-1955	
345	HW R5 G37	Derr	Harry C	1895-1960	
36B	G R20 G12	DeSaw	Fred A	26 Dec 1923-31 Mar 1998	V
36B	G R20 G11	DeSaw	Rosemary	30 Oct 1929-6 May 2008	
428	N R5 G5	Detwiler	Margaret E Stine	1917-2012	
428	N R5 G6	Detwiler	William Leroy	1913-1981	WWII
88	GN R8 G7	DeVault	Dave		
5	GN R2 G37	DeVault	Dorothy Rose Rowe	8 Apr 1937 - 27 Nov 2019	
5	GN R2 G38	DeVault	Harold R "Butch"	29 Apr 1935 - 24 Dec 2022	V
5	GN R2 G40	DeVault	Rex Allan	20 Jul 1959 - 9 Jun 2019	
5	GN R2 G39	DeVault	Shirley Lynn Noland	25 Jan 1964 - 3 Oct 2021	
88	GN R8 G8	DeVault	Susan		
59B	G R17 G2	DeWalt	Esther Anna	19 Aug 1911-26 Aug 1993	

59B	G R17 G3	DeWalt	Rev Kenneth Lamberson	1909-1994	
19A	GN R4 G34	Dew	Robin	1950-2025	
350	HW R7 G47	DeWitt	Florence	1912-1993	
350	HW R7 G48	DeWitt	Leland	1912-1998	
350	HW R7 G46	DeWitt	Malcolm	1947-1988	V
350	HW R8 G45	DeWitt	Suzanne	1936-2010	
350	HW R8 G46	DeWitt	Vaughn	5 Jan 1935-	
101	HE R5 G13	Dildine	Estella Catherine	2 Jun 1871 - 26 Oct 1943	
141	HE R9 G28	Dildine	Helen	1900 - 1977	
55	H R5 G47	Dildine	John T		
141	HE R9 G31	DILDINE	LARGE	MONUMENT	
141	HE R10 G29	Dildine	Margaret	1879 - 1971	
55	H R5 G48	Dildine	Margaret Ellen Wolfley	1850-1932	
55	H R5 G46	Dildine	Mary A	1873-1894	
141	HE R10 G31	Dildine	Mildred E	1901 - 1974	
101	HE R5 G14	Dildine	Newton V	22 Nov 1861 - 10 May 1904	
141	HE R10 G30	Dildine	Paul W	1898 - 1973	
141	HE R10 G28	Dildine	R Burton	1875 - 1967	
141	HE R9 G29	Dildine	Ralph	1901 -1988	
141	HE R9 G30	Dildine	Robert P	1910 - 1978	
55	H R6 G49	Dildine	William "Uncle Billy"		

55	H R5 G49	Dildine	William H	16 Oct 1848 - 22 Sep 1915	
214	NE R15 G12	Dill	Ardelia Elizabeth "Betty"	1911-1999	
46	H R8 G25	Dill	Grace	1889-1893	
46	H R8 G27	Dill	Jennie Merchant	1858-1907	
214	NE R15 G11	Dill	Joel W	1853-1944	
46	H R8 G28	Dill	John B	1849-1889	
46	H R8 G26	Dill	Josie	1885-1893	
214	NE R15 G10	Dill	Ora May	1874-1946	
89	HE R3 G48	Dilsaver	Arminta Shumaker	31 Jul 1836 - Jan 1892	
89	HE R3 G49	Dilsaver	Simon	1842 - 1915	
399	HW R9 G60	Disbennett	Bessie	1874-1965	
397	HW R10 G57	Disbennett	Frances G	1902-1963	
397	HW R10 G58	Disbennett	Howard M	1896-1943	
399	HW R9 G59	Disbennett	Rachel M	1872-1934	
360	LG R10 G7	Diven	Alice Jones	1870-1950	
360	LG R10 G5	Diven	Emma C Prouty	1865-1955	
360	LG R10 G6	Diven	William C	1865-1946	
102	HE R8 G14	Dix	Charles Franklin	1851-1910	
102	HE R7 G15	Dix	George Alfred	1885-1959	
102	HE R7 G14	Dix	Grace Evans	1883 - 1929	
102	HE R7 G12	DIX	LARGE	MONUMENT	

102	HE R7 G13	Dix	Ruth Hilliday	1902 - 1995	
102	HE R8 G13	Dix	Sarah Price	1856-1910	
197	NE R14 G5	Dodge	Ethel	1895-1977	
132	HE R12 G6	Doland	Emma B Sartwell Swearingin	1889-1942	
75	GW R3 G21	Donahue	Timothy Alan	1976-2006	
449	N R12 G19	Douglas	Anna M	1895 - 1989	
449	N R11 G19	Douglas	Dale S	1930-2012	K
449	N R12 G17	Douglas	Dorothy Thomas	1922-2009	
298	HW R2 G35	Douglas	Dortha Irene (CR)		
449	N R12 G18	Douglas	Dwight	18 Jun 1919 - 25 Oct 1992	
449	N R11 G19	Douglas	Fred A	1896-1989	
298	HW R2 G36	Douglas	Linda Diana (CR)	Daughters	
289	HW R4 G14	Dowell	Gail M	1891-1969	
289	HW R4 G13	Dowell	Robert James	1884-1969	
35	H R5 G5	Downing	Della A	1883-1972	
135	HE R10 G17	Downing	Della Leona	1883 - 1947	
135	HE R10 G19	Downing	Doris Louise	1924 - 1925	
135	HE R9 G19	Downing	Edith L	1901 - 1973	
135	HE R10 G18	Downing	Erwin Rufus	1881 - 1946	
137	HE R9 G20	Downing	Henry O	29 Oct 1901 - 7 Jun 1969	
35	H R5 G6	Downing	J Elwin	1877-1941	

135	HE R9 G17	Downing	Mary E	1857 - 1961	
135	HE R10 G16	Downing	Mary Lola	1914 - 1919	
135	HE R9 G18	Downing	Rufus W	1854 - 1917	
50	GW R3 G25	Duncan	Carolyn Wilson	1955 - 2008	
316	LG R6 G1	Dunn	Anna Mary	1880-1963	
316	LG R6 G2	Dunn	William	1877 1963	
142	HE R11 G25	Durfey	2 infants	NO MARKERS	
142	HE R12 G27	Durfey	Martha Ann Griffith	6 Sep 1874 - 23 Apr 1948	
142	HE R12 G26	Durfey	Otis Eugene	18 Sept 1867 - 2 Aug 1939	
37	H R6 G12	Duvendeck	Helen I	18 Jan 1898-18 Mar 1988	

LOT #	SECTION, ROW, GRAVE	LAST	FIRST	DATES	MILITARY
6	H R3 G11	Eagon	Gilbert Richard	1926-2017	WWII
358	LG R10 G1	Eagon	Heidi Jo	1980-1996	
5	H R2 G10	Eagon	Mary Smeck	1905-1993	
5	H R2 G9	Eagon	Norma Jean	1935-1938	
6	H R3 G12	Eagon	Olivia Eileen	1924-2011	
5	H R1 G9	Eagon	Virginia M	1939-2003	
5	H R1 G10	Eagon Jr	Herbert Bernard	1939-2023	Army Natl Guard BG
5	H R2 G11	Eagon Sr	Herbert Barnard	1908-1995	WWII & Korea
320	LG R5 G11	Earlywine	Daisy May	1877-1951	
320	LG R5 G12	Earlywine	Evan Thurman	1874-1940	
389	HW R10 G44	Easterday	Gilford E	1909-1989	
389	HW R10 G43	Easterday	Olive E	1907-1984	
66	HE R3 G7	Eckhardt	Harold Glenn	1902 - 1958	
66	HE R3 G6	Eckhardt	Margaret Osborne	1902 - 1979	
389	HW R10 G41	Eckles	Edna F	1879-1947	
389	HW R10 G42	Eckles	Maurice A	1873-1943	
129	HE R9 G5	Eddy	Catherine Tennant	1847 - 1914	
129	HE R9 G4	Eddy	Peter Androus	1849 - 1936	
172	HE R10 G3	Eddy	Remembrance S	1878 - 1948	
172	HE R10 G2	Eddy	Sarah A Haught	1881 - 1970	

129	HE R9 G6	Eddy	Simon	1828 - 1909	
45B	G R4 G6	Edelblute	Aaron James	1 Nov 1995- Infant	
297	HW R3 G31	Edelblute	Clara Loveless	1900-1989	DAR # 457135
297	HW R4 G32	Edelblute	Clinton O	1922-1978	WWII
339	HW R5 G27	Edelblute	Cora Anna	1887-1980	
339	HW R5 G28	Edelblute	Ellsworth A	1879-1968	
188	NE R14 G2	Edelblute	Isabella M	1851-1931	
339	HW R6 G27	Edelblute	Jack L	1922-2019	
297	HW R3 G32	Edelblute	John H	1893-1951	
188	NE R14 G3	Edelblute	John W	1846-1936	CW
339	HW R6 G28	Edelblute	Kathleen	1933-2013	
297	HW R4 G31	Edelblute	Marjorie Alice	1924-1952	
64	H R7 G66	Edwards	David G	1821 - 1912	
81	HE R2 G34	Edwards	Elizabeth J	1869 - 1942	
69	HE R1 G35	Edwards	infant dau	11 Dec 1885	
64	H R7 G64	Edwards	Jane	died 1 Jul 1868	
67	HE R1 G33	Edwards	Joseph	18 Dec 1837 - 19 Sep 1921	CW
64	H R7 G65	Edwards	Mary	died May 1840	
69	HE R1 G34	Edwards	Mary Penry	1848 - 25 Dec 1885	
81	HE R2 G36	Edwards	Maurice	1876 - 1959	
64	H R7 G63	Edwards	Maurice Morris	1802 - 1853	

81	HE R2 G35	Edwards	William	1877 - 1936	SP-AMER
37	GE R7 G19	Elliott	James (CR)	1951 - 2020	Veteran
44	H R7 G22	Emery	James Robert	1905-1997	
44	H R7 G21	Emery	Ruth Ellen Harmon	1910-1990	
108	HE R8 G24	Evans	Anna Hamner	1879 - 1964	
152	HE R11 G45	Evans	Anna Katherine	1885-1947	
130	HE R12 G1	Evans	Arthur W	1886-1967	
108	HE R8 G27	Evans	BABE		
102	HE R8 G15	Evans	Bess	1885-1978	
376	HW R12 G13	Evans	Bessie Diley	1905-1987	
397	HW R9 G57	Evans	Bessie G	1902-1975	
144	HE R11 G30	Evans	Betty	1902-1988	
302	HW R1 G41	Evans	Betty E Lockhart	1928-2004	
302	HW R1 G42	Evans	Clyde W (CR)	1929-2013	
1	G R4 G23	Evans	David Bryan	1960-2025	
310	HW R4 G57	Evans	Dona	1931-1998	
108	HE R7 G26	Evans	Durward (CR)	1910 - 1985	
130	HE R12 G2	Evans	Elizabeth Grace	1863-1947	
204	NE R4 G16	Evans	Elizabeth Jones	1854-1926	
197	NE R14 G6	Evans	Ella V Harsh	1863-1917	
344	HW R8 G34	Evans	Ernest	1905-1988	

87	HE R2 G46	Evans	Evan S	3 Jul 1837 - 26 Mar 1885	CW
62	H R8 G60	Evans	Foster	1866 - 1927	
1	GW R6 G42	Evans	George Allen	27 Jan 1933 - 2 Jul 2005	K
144	HE R11 G29	Evans	infant	NO MARKER	
310	HW R4 G59	Evans	infant son		
152	HE R11 G47	Evans	John	1847-1912	
1	GW R5 G41	Evans	John (CR)	7 Jan 1962 - 23 Apr 2018	
87	HE R2 G48	Evans	John R	17 Apr 1878 - 16 Apr 1887	
1	G R4 G24	Evans	John R (CR)	1962-2018	
69	HE R1 G46	Evans	John W	4 May 1839 - 9 Apr 1917	CW
87	HE R2 G47	Evans	Joseph E	24 Nov 1884 - 8 May 1886	
310	HW R4 G58	Evans	Kenneth	1927-1996	WWII
62	H R8 G58	Evans	Margaret Luellen	1838 - 1898	
69	HE R1 G47	Evans	Mary J	14 Aug 1852 - 5 Sep 1889	
108	HE R8 G25	Evans	Mattie S	1875 - 1904	
376	HW R12 G14	Evans	Merritt Paul	1902-1961	
71	HE R1 G48	Evans	Morris	1888 - 1889	
344	HW R8 G33	Evans	Opal	1909-1972	
1	GW R7 G43	Evans	Orlene Louise		
197	NE R14 G8	Evans	Robert F	1902-1979	
108	HE R8 G26	Evans	Robert Luellen	1870 - 1952	

130	HE R12 G3	Evans	Robert T	1860-1917	
28B	G R13 G13	Evans	Scott Lee	1952-1999	
130	HE R12 G4	Evans	Thomas Robert	1893-1967	
204	NE R3 G16	Evans	Walter	1895-1925	WWI
144	HE R11 G31	Evans	Walter W	1900-1977	
62	H R8 G59	Evans	William	1821- 1889	
204	NE R3 G17	Evans	William	1882-1941	
204	NE R4 G17	Evans	Wm J	1844-1926	
87	HE R2 G45	EVANS	LARGE	MONUMENT	
152	HE R11 G46	Evans Jr	John	1879-1962	
37	GE R7 G20	Everhart	William (CR)	1931-2020	K

LOT #	SECTION, ROW, GRAVE	LAST	FIRST	DATES	MILITARY
196	NE R11 G7	Fahey	John	1862 - 1938	
196	NE R11 G6	Fahey	Mary	1898 - 1981	
196	NE R11 G8	Fahey	Nettie Cronkleton	1876 - 1917	
377	HW R10 G18	Farrington	Anna Gale Osborn	1920-1981	
377	HW R10 G17	Farrington	Raymond Hugo	1916-1983	WWII & Korea
120	GW R4 G8	Fathbruck	Judy A	1948 -	
446	N R11 G13	Faulkner	Charles J	1899 - 1982	WWI
446	N R9 G12	Faulkner	Nina Srigley	1901 - 1988	
16B	G R16 G19	Fegley	Kenneth L	24 Jan 1934-4 Oct 1922	
16B	G R16 G20	Fegley	Linda L	23 May 1937 -	
205	NE R5 G16	Fielder	Amanda Ellen	1865-1913	
205	NE R5 G18	Fielder	Walter Franklin	1884-1921	
205	NE R5 G17	Fielder	William Washington	1860 - 1921	
19	H R1 G39	Fields	Anna E	1884-1958	
313	LG R2 G12	Fields	Donald E	1929-1979	
313	LG R2 G10	Fields	Ernest C	1903-1951	
19	H R1 G41	Fields	Grover	1884-1963	
313	LG R2 G11	Fields	Helen I	1935 -	
19	H R1 G40	Fields	Kenneth E	1904-1955	
313	LG R2 G9	Fields	Verna	1907-1991	

67B	G R1 G4	Finley	Edward Carl	1939-1990	NAVY
67B	G R1 G3	Finley	Marjorie Benefer	1940-1997	
8	H R4 G13	Fisher	Don	died 2017	
216	NE R20 G7	Fisher	Mayme Rouse	1888-1938	
184	NE R5 G9	Fleming	Anna G	184-1986	
70	HE R4 G13	Fleming	Dorothy	1885 - 1954	
184	NE R5 G10	Fleming	Frank A	1882-1941	
55B	G R23 G6	Fleming	Gladys M	1918-2001	
195	NE R10 G11	Fleming	Henry	1858-1891	
195	NE R10 G9	Fleming	Jacob	1864-1918	
82	HE R4 G37	Fleming	James	1766 - 1851	
82	HE R4 G36	Fleming	Jean Brown	1773 - 1840	
195	NE R10 G10	Fleming	Julietta Martin	1858-1916	
195	NE R10 G8	Fleming	Lelo		
170	HE R6 G1	Fleming	Marcella (CR) remains in Mary Katherine	12 Feb 1971 - 21 May 1996	
51	H R6 G39	Fleming	Margaret Ann		
55B	G R23 G5	Fleming	O Richard	1919-1988	WWII
295	HW R3 G26	Fogle	Nettie Carter Dailey	1926-2011	
222	E R3 G6	Foor	George Sherman	1906-1974	
222	E R3 G5	Foor	Mary S Goodman	1911-1983	
358	LG R9 G4	Foreman	Robert I	1930-2009	

358	LG R9 G3	Foreman	Sara L	1929-2017	
65B	G R5 G3	Foster	Kara Claire	1993 - 1998	
51B	G R16 G7	Fraker	Clinton (CR)	died b4 2015	
354	HW R8 G54	Fraker	Edna	1899-1966	
354	HW R8 G53	Fraker	Elmer	1902-1977	
51B	G R16 G6	Fraker	Paul John	1927-2000	
51B	G R16 G8	Fraker	Willeen (CR)	1931-2015	
450	N R11 G22	Frank	Eldon E	1917-1997	
422	N R3 G18	Frazier	Lafe A	5 Sep 1927 - 2 Dec 1993	WWII
422	N R3 G17	Frazier	Patricia A	1931-2003	
311	LG R1 G1	Freeman	Marjorie L	09/17/1930 - 06/15/2002	
311	LG R1 G2	Freeman	Robert L	06/07/1920 - 11/20/1988	WWII
44B	G R3 G10	French	Donna (CR)	9 Jan 1934-9 Feb 2024	
44B	G R3 G9	French	Robert Wallace	22 Mar 1932-21 Mar 2000	K
447	N R12 G15	Freshly	Ruth M Milligan	1918-1981	
178	NE R3 G7	Frye	Donald L	20 Sep 1927-12 Feb 2004	WWII
178	NE R4 G6	Frye	Eva F	1901-1972	
178	NE R4 G7	Frye	James H	3 Aug 1895 - 19 May 1974	WWI
178	NE R3 G6	Frye	Leslie J	1924-1929	
341	HW R6 G29	Fryman	Dorothy Jean Watkins	1920-1982	
43B	G R6 G10	Fryman	Georgette E	30 May 1952 -	

341	HW R6 G30	Fryman	Harry Willis	1918-2007	WWII
43B	G R6 G09	Fryman	Jerry	22 Jul 1947-2 Jun 2014	V
23A	GW R5 G38	Fryman	John	1950-2025	US Army Reserves
341	HW R6 G31	Fryman	Mabel Herd	1895-1982	
341	HW R5 G58	Fryman	Paul Vernon	1943-2002	V
341	HW R6 G32	Fryman	Thomas Elmer	1894-1953	
93	HE R2 G58	Furstenberger	Cora Herbert	2 Sep 1880 - 25 Sep 1962	
93	HE R2 G59	Furstenberger	Rev Albert J	27 Oct 1877 - 19 Mar 1961	

LOT #	SECTION, ROW, GRAVE	LAST	FIRST	DATES	MILITARY
177	NE R2 G8	Gabriel	Finley M	1902-1962	
445	N R12 G10	Gabriel	Joyce C	25 May 1941-	
177	NE R2 G7	Gabriel	Marie F	1907-1975	
445	N R12 G9	Gabriel	Ronald M	29-Mar-35	
177	NE R1 G8	Gabriel	Sandra Maxine	1948-1948	
110	GN R7 G3	Gale	Jerry Lee	1942-2014	V
110	GN R7 G4	Gale	Lula (CR)	1946-2018	
138	HE R12 G19	Gallant	Bernice		
138	HE R11 G18	Gallant	Elizabeth Jane Wallace	1859-1923	
140	HE R11 G23	Gallant	Elizabeth Jones	1868 - 1917	
140	HE R12 G22	Gallant	Elizabeth Williams	1836-1922	
140	HE R12 G24	Gallant	Fred W	27 Jul 1878 - 24 Feb 1948	
138	HE R12 G20	Gallant	Harry	1871-1948	
361	LG R8 G10	Gallant	James Morgan	1911-1970	
361	LG R8 G9	Gallant	Mildred J	1912 - 2010	
140	HE R11 G21	Gallant	Sadie Sara	1867-1927	
138	HE R11 G19	Gallant	William E	16 Feb 1856 - 15 Nov 1941	
140	HE R11 G22	Gallant Jr	James W	1868 - 1931	
140	HE R12 G23	Gallant Sr	James W	1834 - 1915	
5	GN R1 G38	Galloway	Gene		

5	GN R1 G37	Galloway	Trina		
121	HE R6 G52	Gardner	Mary Jeanette Pugh	1923 - 2002	
121	HE R6 G53	Gardner	Rev Richard	1914-1964	WWII
345	HW R6 G37	Garee	Betty J	1923-2011	
345	HW R6 G39	Garee	Georgiana	1926-1947	
345	HW R6 G40	Garee Jr	Cecil	1946-1979	
345	HW R6 G38	Garee Sr	Cecil	1922-1995	WWII
33	GE R2 G28	Garner	Matthew	1957-2022	Del Co Sheriff
240	E R4 G27	Garrison	Dortha Medors	1918-2006	
2	GW R7 G42	Garrison	James (CR)	1936-2006	Army
62B	G R12 G3	Garrison	Karen E	8-Feb-65	
2	GW R8 G43	Garrison	Mary		
240	E R4 G28	Garrison	Ralph Harlin	1920-2006	
62B	G R12 G4	Garrison	Richard V	5 Nov 1944-12 Aug 2001	
5	GN R1 G39	Garrison	Robert (CR)		
5	GN R1 G39	Garrison	Florence (CR)		
6B	G R13 G23	Gast	Dorothy	1918-2013	
6B	G R13 G24	Gast	Ernest	1915-2008	
289	HW R3 G15	Gast	Mary Griffith	1886-1967	
289	HW R3 G16	Gast	Milo H	1884-1960	
62	GE R8 G14	Gentry	Betty F	1933 - 2017	

327	HW R5 G1	Gephart	Marjorie	7 Apr 1925-14 Feb 2000	
327	HW R5 G2	Gephart	Richard (CR)	3 Apr 1927-9 Apr 1991	WWII
145	HE R9 G39	Gibson	Bry Edgar	1886 - 1957	
145	HE R9 G37	Gibson	Carrie Coonfare	1864 - 1947	
145	HE R9 G38	Gibson	Charles	1862 - 1903	
145	HE R10 G36	Gibson	Ina I Bell	1892 - 1969	
145	HE R10 G39	Gibson	Infant	NO MARKER	
145	HE R10 G37	Gibson	Paul E	1893 - 1985	
145	HE R9 G36	Gibson	Ross Charles	1890 - 1950	Headstone ordered
63B	G R10 G4	Gillard	Ann Price	1931-	
63B	G R10 G1	Gillard	James Roland	1928-2025	USAF
63B	G R10 G3	Gillard	Michael (CR)	1954-2006	
321	LG R3 G15	Gillis	Ruth Gladden	05/19/1901 077/26/1991	
321	LG R3 G16	Gladden	William A	05/07/1900 02/02/1969	
217	NE R21 G5	Glaze	Nellie Morris Landers	1878-1965	
217	NE R21 G4	Glaze	Thomas Robert	1874-1940	Sp-Amer - Headstone
304	HW R2 G45	Golden	Carma Jean Thor	1926-2015	
67	HE R2 G7	Gomff	Mabel Edna Griffith	1895 - 1934	No headstone
50B	G R14 G5	Good	Charlotte	10 Feb 1955-1 Mar 2019	
433	N R7 G10	Good	Helen Vigar Good	1918 - 2010	WWII
50B	G R13 G8	Good	Ivan Carl	18 May 1949-18 Nov 2022	

433	N R7 G9	Good	Jesse B	1920 - 1978	
50B	G R13 G7	Good	Linda Sue	13 Feb 1949-21 Sep 2004	
415	N R1 G6	Goodin	Clarence	6 Jun 1898 - 13 Sep 1982	
415	N R2 G6	Goodin	Don M	8 Jun 1942 - 4 oct 2020	V
415	N R1 G5	Goodin	Hazel M	14 oct 1911 - 1 Apr 1996	
415	N R2 G5	Goodin	Virginia A	25 May 1945 -	
198	NE R16 G5	Goodman	Bertha Mable	1887-1943	
198	NE R15 G7	Goodman	Charles E	1897-1919	
198	NE R15 G6	Goodman	Clifford Earl	1900-1919	
198	NE R15 G5	Goodman	Donald M	1904-1919	
198	NE R16 G4	Goodman	Gladys	1928-1929	
198	NE R16 G8	Goodman	James	1854 - 1919	
198	NE R16 G7	Goodman	Mary Etta	1867 - 1950	
225	E R3 G8	Goodman	Robert William	27 Dec 1920-4 Dec 1983	WWII
198	NE R15 G4	Goodman	Theodore	1906-1919	
198	NE R16 G6	Goodman	William A	1887-1946	
230	E R1 G20	Goss	Mary A Jenkins	1876-1937	
316	LG R5 G1	Gow	Cornelia E	1860-1950	
316	LG R5 G2	Gow	Rev David W	1859-1958	
		Grable	Jerry	1937-2003	V
55	H R6 G48	Graham	Alonzo D	1876-1945	

55	H R6 G47	Graham	Sarah	1880-1956	
285	HW R3 G6	Gray	J P (Pat)	1893-1970	
352	HW R7 G50	Gray	Allen	1867-1941	
389	HW R9 G41	Gray	Baby Boy		
21	GW R13 G34	Gray	Barbara	1936-2017	
21	GW R13 G35	Gray	Charlie	1935 -	
417	N R1 G11	Gray	Emma D	1913-1987	
434	N R6 G16	Gray	Glenn M	1932 - 1996	
387	HW R10 G39	Gray	James Wesley	30 Nov 1893-27 Nov 1955	WWI
285	HW R3 G5	Gray	Jane lone	1895-1958	
389	HW R9 G43	Gray	Kathryn	1897-1985	
387	HW R10 G40	Gray	Margaret E	1900-1976	
21	G R9 G20	Gray	Michelle A	1960-	
389	HW R9 G42	Gray	Ross	1891-1955	
417	N R1 G12	Gray	Sidney A	1912-1996	
262	E R5 G54	Gray	Victoria E Taylor	7 Jan 1865-25 May 1934	
306	HW R1 G49	Green	Edith E Havens	1899-1894	
306	HW R1 G50	Green	Ernest E	1896-1973	WWI
226	E R5 G7	Green	Jonathan Randolph	1966-2022	
226	E R5 G8	Green	Sue	1941 -	
394	HW R12 G50	Gregory	Ira	1870-1936	

394	HW R12 G51	Gregory Jr	William		
403	LG R12 G6	Griffith	Barton Russell	1892-1975	WWI
211	NE R9 G13	Griffith	Clara Hedges	9 May 1869 - 5 Jun 1913	
151	HE R10 G49	Griffith	Daisy Marie Boring	1907 - 1950	
343	HW R5 G34	Griffith	Edwin H	1893-1957	
151	HE R9 G49	Griffith	Elizabeth Hull	1871 - 1904	
144	HE R12 G30	Griffith	Elma Smith	1974 - 1957	
153	HE R9 G52	Griffith	Elmer B	1884-1923	
144	HE R12 G31	Griffith	Evan D	1873 - 1958	
343	HW R5 G33	Griffith	Faye M Tuller	1893-1968	
255	E R4 G49	Griffith	Florence		
345	HW R5 G39	Griffith	Florence Bula Moore	1892-1950	
403	LG R12 G7	Griffith	Georgia	1894 - 1978	
24	H R3 G46	Griffith	Hanna E McMillan	Died 28 Apr 1903	
24	H R4 G45	Griffith	Jane Ludwig	1839-1903	
211	NE R9 G14	Griffith	Joel	2 Feb 1843 - 7 Jan 1915	
116	HE R8 G43	Griffith	John D	1853 - 1929	
49	H R6 G34	Griffith	Mary Kathryn	1914-1916	
24	H R3 G48	Griffith	Mary Rosetta	Died 30 Dec 1869 (infant)	
151	HE R9 G48	Griffith	Nettie M	1883 - 1938	
345	HW R5 G40	Griffith	Owen	1882-1961	

151	HE R10 G50	Griffith	Rev Thomas R	1 Nov 1899 - 13 Feb 1933	WWI
343	HW R6 G34	Griffith	Richard Alvin	1916-1944	WWII
211	NE R9 G12	Griffith	Richard Pugh	25 Dec 1899 - 18 May 1938	
258	E R4 G53	Griffith	Sandra C	17 Apr 1961 -	
116	HE R8 G42	Griffith	Sue M Jones	1856 - 1926	
255	E R4 G50	Griffith	William		
24	H R3 G45	Griffith	William Henry	1874-1892	
24	H R4 G48	Griffith	William Henry	1837-1886	
25	H R2 G53	Griffiths	Albert	1850-1915	
43	H R6 G21	Griffiths	Ann	1830-1902	
153	HE R9 G55	Griffiths	Annie C	1873 - 1964	
363	LG R8 G15	Griffiths	Bessie Runnels	1876 - 1952	
143	HE R9 G33	Griffiths	Charles E	1875 - 1954	
365	LG R8 G17	Griffiths	Daisy	1876-1964	
25	H R1 G52	Griffiths	David	1792-1870	
67	HE R2 G6	Griffiths	David Howard	1893 - 1971	WWI
143	HE R10 G34	Griffiths	David R	1913 - 1977	
376	HW R12 G16	Griffiths	David S	1964-1990	
153	HE R9 G54	Griffiths	David T	1853 - 1938	
143	HE R9 G34	Griffiths	E Grace	1879 - 1965	
41	H R6 G17	Griffiths	Eleanor J	1867-1927	

41	H R6 G18	Griffiths	Elizabeth	1844-1907	
124	HE R8 G58	Griffiths	Elizabeth B	1842 - 1923	
111	HE R5 G32	Griffiths	Ella Jones	21 Mar 1870 - 12 Sep 1958	
41	H R6 G20	Griffiths	George A	1871-1929	
71	HE R1 G6	Griffiths	George M	1842 - 1900	
153	HE R10 G52	Griffiths	Henry	NO Headstone	
41	H R6 G19	Griffiths	Humphrey	1835-1923	
67	HE R2 G5	Griffiths	Ina May Feasel	1903 - 1989	
49	H R6 G35	Griffiths	Jennibel	1887-1965	
143	HE R10 G33	Griffiths	Mabel Irene Beaver	1916 - 1995	
25	H R2 G50	Griffiths	Margaret J	died 1846	
25	H R1 G53	Griffiths	Martha J	1883-1884	NO headstone
25	H R1 G51	Griffiths	Martha Pugh	1806-1881	
153	HE R9 G53	Griffiths	Mary Viola	1855-	
111	HE R5 G33	Griffiths	Perry	17 Dec 1867 - 27 Mar 1951	
124	HE R8 G59	Griffiths	Rev Thomas S	1840 - 1899	
25	H R2 G51	Griffiths	Richard P	1835-1888	CW
143	HE R9 G35	Griffiths	Robert L	1904 - 1905	
25	H R1 G50	Griffiths	Sarah A	unknown - 17 Oct 1851	
43	H R6 G22	Griffiths	Thomas	1821-1896	
365	LG R8 G18	Griffiths	Thomas L	1873-1952	

49	H R6 G36	Griffiths	Thomas Ray	1882-1957	
143	HE R10 G35	Griffiths	Thomas T	1939 - 1956	
376	HW R12 G15	Griffiths	William A	1896-1975	
376	HW R12 G15	Griffiths	Ruby E	1897-1991	
151	HE R9 G50	Griffiths	William T	d 1918	
151	HE R9 G50	Griffiths	George	died 1918	
363	LG R8 G16	Griffiths	Wm Chauncey	1876 - 1947	
189	NE R15 G2	Grigsby	Jacob H	1858 - 1937	
189	NE R15 G3	Grigsby	Mary A Goodman	1862 -1921	
224	E R2 G9	Grover	Louise Hylton	1899-1975	
97	GW R2 G22	Gundelfinger	Boyd S. Sr.	23 Oct 1918 - 24 Mar 2007	WWII
97	GW R2 G21	Gundelfinger	Juanita Sadler	17 Sep 1920 - 11 Jan 2010	
97	GW R1 G22	Gundelfinger Jr	Boyd Allen Jr.	1938-2006	K
50B	G R14 G7	Guthrie	Helen	12 Aug 1920-28 May 2007	
50B	G R14 G6	Guthrie	James E	5 Dec 1916-8 Dec 2005	WWII

LOT #	SECTION, ROW, GRAVE	LAST	FIRST	DATES	MILITARY
360	LG R9 G8	Hadley	Edward	1862-1941	
360	LG R9 G7	Hadley	Ruth	1867-1953	
256	E R6 G46	Hagaman	Edwin K	1915-1993	
256	E R6 G45	Hagaman	Marjorie	1919-1990	
257	E R1 G55	Hague	Alice M	1901-1985	
257	E R1 G56	Hague	Andy R	1889-1969	
388	HW R12 G38	Haines	James E	1887-1943	
388	HW R12 G37	Haines	Mary Ida Kirby	1883-1958	
416	N R3 G6	Halbert	Marguerite James	1909 -1999	
82	GE R5 G8	Hall	John Jack	1954-2014	Veteran
450	N R11 G20	Hall	Margaret Ann	1918-1972	
431	N R10 G7	Hall	Ruth Ann	11 Jan 1928 - 14 Dec 2012	
424	N R3 G24	Hall	Scott Eugene	1951-1972	
431	N R10 G6	Hall	Thomas M	21 Mar 1929 - 20 Dec 2024	K
295	HW R3 G25	Hall	Beverly Dailey	1950-2018	
295	HW R3 G25	Hall	Harley R (CR)	1954-2021	V
9	GE R2 G34	Hamilton	Ava Jean (CR)	1936-2023	
298	HW R1 G33	Hamilton	infant		
9	GE R2 G35	Hamilton	Jack (CR)	1934-2010	K
395	HW R9 G56	Hammond	Charles S	1865-1935	

395	HW R9 G55	Hammond	Etta	1871-1934	
171	HE R8 G2	Hammonds	Frederick	1852 - 1924	
171	HE R8 G3	Hammonds	Jane Thomas	1854 - 1928	
171	HE R7 G3	Hammonds	Jerry	Unknown - 23 Apr 1945	
191	NE R1 G13	Harbin	Anna	1907-1982	
191	NE R1 G14	Harbin	Floyd Asbury	1903-1946	
44	H R8 G23	Harmon	Agnes Dill	1883-1943	
44	H R8 G22	Harmon	John Dill	1916-1955	
44	H R8 G24	Harmon	Leonard M	1876-1949	
73	GW R8 G22	Harper	Bryan	1968 -	
73	GW R8 G21	Harper	Catherine	1968 -	
63	GE R7 G9	Harrison	Brenda	1951 - 2017	
63	GE R8 G9	Harrison	Mary Lou	1930 - 2020	
63	GE R8 G10	Harrison	Robert	1927 - 2020	
305	HW R4 G46	Harsh	Carl E	1939-2007	USMC
340	HW R8 G28	Harsh	Charles (CR)	1933-2020	
305	HW RE G47	Harsh	Charles C	1882-1963	
340	HW R8 G25	Harsh	Charles F III	29 Jan 1958-4 Sep 1977	
436	N R5 G21	Harsh	Cora Jane Lehner	1934 - 2016	
436	N R5 G22	Harsh	Dale	1930 -	
436	N R6 G21	Harsh	Edwin Lewis	1934-2022	

305	HW RE4 G47	Harsh	Grace E Kottermar	1905-1975	
305	HW R3 G46	Harsh	Hazel C	1885-1966	
340	HW R8 G26	Harsh	John	1908-2000	
436	N R6 G22	Harsh	Kay J Buckingham	1937 - 2016	
436	N R5 G20	HARSH	LARGE	MONUMENT	
436	N R6 G19	Harsh	Mildred Louise Kunze	1908-1994	DAR
305	HW R4 G48	Harsh	Paul Byron	1907-1979	
340	HW R8 G27	Harsh	Ruth E Carnes	30 Sep 1908-4 Dec 2006	
436	N R6 G20	Harsh	William E	1902-1980	
357	LG R8 G2	Harter	Hortense Alberta (CR)	1911-2005	DAR #569032
357	LG R7 G2	Harter	John H	1872-1937	
357	LG R7 G1	Harter	Mary E	1892-1979	
330	HW R8 G7	Harvey	Mina	1900-1991	
330	HW R7 G7	Harvey	Rodger T	1942-1997	
330	HW R7 G8	Harvey	Ronald Paul	1940-1964	
330	HW R8 G8	Harvey	Roy	1887-1975	
36B	G R20 G10	Havens	Bethel O Cooper	1918-2003	
36B	G R20 G9	Havens	Delbert	12 Jan 1914-27 Jan 2009	WWII
252	E R5 G57	Hawk	Myrta May Swam	1913 - 1988	
252	E R5 G56	Hawk	Ralph	1906 - 1988	
247	E R5 G34	Hawkins	Bonnie Ruth	1911 - 1985	

247	E R5 G36	Hawkins	Clarence James	21 Aug 1912-5 Jul 1995	WWII
247	E R5 G35	Hawkins	Norbert (CR)	1946 - 2014	V
8	H R3 G13	Hay	Lloyd Q	Dec 1902 - 14 Apr 1959	
8	H R3 G14	Hay Keagy	Helen Gould Osborn	4 Nov 1902 - 30 Oct 1991	
63B	G R10 G2	Heasley	Lisa	1958-2015	
71	HE R1 G7	Hedges	Charles Wesley	1865 - 1948	NO MARKER
67	HE R2 G8	Hedges	Clifford	28 Jun 1903 - 30 Jun 1948	NO MARKER
418	N R3 G11	Hedges	Dorothy M	1919-2002	
1B	G R3 G23	Hedges	Ivan I	1 Jan 1918-25 Dec 2003	
1B	G R4 G24	Hedges	Karen Sue Howald	24 Jun 1952 -	
418	N R3 G12	Hedges	Luther	1916-2015	
71	HE R1 G5	Hedges	Sallie Bendell Griffiths	1864 - 1927	
1B	G R3 G24	Hedges	Vera M	4 Aug 1917 - 17 Oct 2010	
1B	G R4 G23	Hedges	William Ivan	18 Aug 1951-25 Dec 2019	
126	HE R8 G62	Heckerman	Sarah J (CR)		
126	HE R8 G62	Heckerman	Guy C (CR)		
259	E R6 G51	Heineman	Christina D Israel	20 May 1920-22 Jun 2000	
259	E R6 G52	Heineman	Earl L	21 Dec 1917-2 May 1978	
69	HE R2 G12	Henke	Joseph	1914 - 1982	WWII
69	HE R2 G11	Henke	Loma	1918 - 1991	
290	HW R2 G17	Henry	infant		

290	HW R1 G18	Henry	Lester	1973-1966	WWII
290	HW R1 G17	Henry	Vivian	1923-1988	
75	HE R1 G61	Herbert	2 infant sons		
73	HE R1 G59	Herbert	Baby Boy	23 Nov 1876 - 1 Dec 1876	
73	HE R1 G58	Herbert	Benjamin Lewis	1 Apr 1849 - 18 May 1923	
95	HE R2 G64	Herbert	Elizabeth Jones	1822 - 1904	
311	LG R2 G3	Herbert	Helen	1899-1969	
73	HE R1 G57	Herbert	Ida E Duncan	17 Jun 1852 - 8 Aug 1925	
73	HE R1 G60	Herbert	Ira	5 Mar 1884 - 8 Sep 1884	
93	HE R2 G57	HERBERT	LARGE	MONUMENT	
75	HE R1 G64	Herbert	Lizzie	1847-1855	
75	HE R1 G64	Herbert	Maggie	1850-1866	
75	HE R1 G62	Herbert	Mary Anna Jones	9 Feb 1862 - 6 Dec 1900	
311	LG R1 G3	Herbert	Velma L	1926-1983	
75	HE R1 G63	Herbert	William	1856 - 1934	
95	HE R2 G63	Herbert	William	1813 - 1903	
311	LG R2 G4	Herbert	William B	1895-1978	WWI
311	LG R1 G4	Herbert	William G	10/27/1922 - 04/15/1980	WWII
365	LG R7 G17	Herd	Abner	07/3/1902 04/7/1982	
365	LG R7 G18	Herd	Margaret	07/13/1908 06/10/1964	
22	H R3 G42	Herren	Alma E	1919-2010	

22	H R3 G43	Herren	Russel L	1923-2003	
295	HW R4 G25	Hetsler	Nettie Tilley Osbourne Carter	1898-1978	
353	HW R6 G53	Hetzner	Alice	20 Feb 1904-10 Mar 1986	
329	HW R5 G8	Hetzner	Bernice	1900-1989	
329	HW R5 G7	Hetzner	Carl	1901-1968	
353	HW R6 G56	Hetzner	Frank	21 May 1861-21 Dec 1936	
329	HW R6 G8	Hetzner	Lowell	1931-2002	1 Lt USAF
353	HW R6 G55	Hetzner	Margaret A		
329	HW R6 G7	Hetzner	Norma Jean	1937-2022	
60B	G R16 G3	Hickman	Nancy E	1940-1998	
60B	G R16 G4	Hickman	Robert D	1930-2000	
416	N R3 G8	Hill	Bernard Ray	6 Jun 1926-20 May 1995	WWII
369	HW R10 G4	Hill	Charles Ralph	1910-1998	
416	N R3 G7	Hill	Mary E	11 Oct 1929-25 Aug 2013	
369	HW R10 G3	Hill	Mary Kathryn	1915-1986	
443	N R11 G5	Hill	Mary N	1925-1993	
443	N R11 G6	Hill	Robert K	6 May 1922 - 19 Dec 1989	WWII
309	HW R4 G53	Hillard	Amanda Ida Long House	1877-1956	
109	HE R6 G28	Hillard	Gerald Davis	1929-1929	
107	HE R6 G27	Hillard	Mansel Luther	1928-1928	
309	HW R4 G54	Hilliard	Mansel L	1870-1943	

239	E R1 G30	Hinderlong	Elizabeth Slay	1867-1934	
239	E R1 G32	Hinderlong	Ellis		NO GRAVE MARKER
239	E R1 G29	Hinderlong	Emmet C	1895-1918	WWI
239	E R2 G29	Hinderlong	infant		
175	NE R5 G2	Hinderlong	Martin K	1863-1947	
175	NE R5 G1	Hinderlong	Nancy J	1854-1937	
239	E R1 G31	Hinderlong	Samuel	1857-1936	WWI
17B	G R13 G18	Hing	Jack	1911-1992	
17B	G R13 G17	Hing	Mamie	1922-2002	
261	E R3 G55	Hinkle	Betty Lou Shaw	2 Apr 1927 - 26 May 2007	
260	E R1 G58	Hinkle	George L	1989 - 1967	
261	E R3 G56	Hinkle	Gerald Roy	23 Jul 1898 - 11 Oct 1967	
260	E R2 G57	Hinkle	June Ilene	died June 1929	
260	E R2 G57	Hinkle	Martha Irene	died April 1926	
260	E R2 G58	Hinkle	Robert	1950-2019	
260	E R1 G57	Hinkle	Sylvia	1906 - 1954	
406	LG R14 G11	Hissin	Susan Dale	1948-1948	
390	HW R12 G44	Hodges	Clarence O	1878-1944	
450	N R12 G23	Hodges	James D	1942-2019	
450	N R11 G21	Hodges	Janice L	1941-2010	
390	HW R12 G43	Hodges	Lelia	1877-1962	

450	N R12 G22	Hodges	Mary Jane	1922-2013	WWII
25B	G R7 G15	Hoge	Larry E	13 Apr 1952-19 Aug 2013	
258	NE R6 G7	Holt	Eileen Shark (CR)	1936-1978	
27	GW R9 G35	Honeter	Kolton Ramon	2000-2020	
27	GW R9 G36	Honeter	Ronald	1955 - 2018	
226	E R6 G7	Horner	Lois Iris Mobley	26 Jan 1904-8 Apr 1990	
226	E R6 G8	Horner	Marvin (CR)"Buck"	25 Apr 1900-26 Feb 1894	
257	E R2 G54	Hornsby	Dallas S	1874-1953	
54B	G R22 G7	Hornsby	Geraldine Hartley	1932-2008	
54B	G R22 G8	Hornsby	Howard S	1929-2013	
258	E R3 G51	Hornsby	Lela Agnes Dunfee	14 Apr 1899 - 11 Sep 1986	
258	E R4 G51	Hornsby	Naomi Faye	4 Jan 1926 - 26 Feb 2017	
258	E R4 G52	Hornsby	Paul E	10 Jul 1927 - 14 Oct 1999	WWII
258	E R3 G52	Hornsby	Ray Ernest	2 Apr 1899 - 25 Aug 1934	
257	E R2 G53	Hornsby	Ruth Ellen	1931 - 1931	
257	E R1 G53	Hornsby	Sarah R	1877-1922	
60	GE R4 G20	Hossler Sr	Robert Damon	1947-2020	
442	N R9 G8	Howald	Charles W	1938 -	
442	N R9 G7	Howald	Patricia L	1939 -	
229	E R5 G10	Howard	Bernard Wilson	11 Dec 1933-26 Feb 2004	K
229	E R5 G9	Howard	Harriet A Ott	25 Dec 1925-9 Jun 2008	

229	E R6 G10	Howard	Jason (infant)	6 Jun 1987-8 Oct 1987	
229	E R6 G9	Howard	Maria Sue	6 July 1963-16 Jun 2013	
5B	G R11 G21	Howe	James (CR)	17 Jan 1919-29 Jun 2011	WWII
5B	G R11 G22	Howe	Marjorie Jean Heavlin	1922-2017	
291	HW R4 G20	Howe	Scott Alan (CR)	1963-2006	
5B	G R12 G21	Howe	Stephen R (on back of parents)	1947-2024	V
291	HW R3 G19	Howey	Anabel Edelblute	1934-2010	
291	HW R3 G20	Howey	Edward F	1925-2011	
291	HW R4 G20	Howey	John Edward	1955-1960	
291	HW R4 G19	Howey	Kathy Susan	1954-1960	
51	H R6 G41	Howison	Annie	1859-1934	
428	N R6 G3	Howison	Brent	1941-2012	
12	H R4 G23	Howison	Eltheo	1902-1994	
12	H R3 G21	Howison	George C	1879-1901	
12	H R4 G21	Howison	Harold S	Died 25 Oct 1927.	Masonic Symbol
12	H R4 G22	Howison	Joan P	Died 3 Oct 1928	Eastern Star
12	H R4 G24	Howison	Leroy	1901-1957	Masonic Symbol
428	N R5 G3	Howison	Mary E Williams	1918-1990	
51	H R6 G40	Howison	Samuel	1853-1898	
428	N R5 G4	Howison	Wade Winfield	1903-1985	
449	N R11 G17	Hoy	Todd Arthur	27 Feb 1969-31 Mar 2012	

357	LG R8 G4	Hoyt	John H	1872 - 1937	
3B	G R7 G24	Huffman	Francis D	1919-1988	WWII
?	?	Huffman	Jeffrey Eugene	1956-2017	V
3B	G R7 G23	Huffman	Josephine	1927-1995	
24B	G R6 G14	Huffman	Louis H	11 Sep 1935-14 Sep 2006	
6	H R3 G9	Hughes	Annie E	1850-1934	
447	N R11 G14	Hughes	Arthur C	1888-1971	
240	E R3 G28	Hughes	Dwight M	1925-2000	WWII
447	N R11 G13	Hughes	Grace J	1889-1970	
240	E R3 G27	Hughes	Jo Ann	1929-1982	
6	H R3 G10	Hughes	John T	1853-1928	
200	NE R19 G4	Hughes	Thomas W	1850-1929	
294	HW R1 G28	Hummel	James F	1886-1966	
294	HW R1 G26	Hummel	Jesse Franklin	1912-1989	WWII
294	HW R1 G27	Hummel	Mary Ella Bechtel	1886-1962	
294	HW R1 G25	Hummel	Mildred (CR)	1924-2021	WWII
294	HW R2 G25	Hummell	Beloved Daughter of Mr & Mrs J	1958	
294	HW R2 G27	Hummell	Gladys	1924-1999	
294	HW R2 G28	Hummell	Ralph	1914-1992	
383	HW R10 G29	Humphreys	Anna R	1929-	
383	HW R10 G30	Humphreys	Charles M	1923-2007	WWII

53	H R6 G43	Humphreys	Hattie M	1858 - 1878	
335	HW R6 G20	Humphreys Jr	John		
335	HW R5 G19	Humphreys	John R	1917-1996	
53	H R5 G43	Humphreys	John W	1854-1936	
53	H R5 G42	Humphreys	Lucy Weiland	1857-1939	
29	H R1 G59	Humphreys	Margaret E Wasson	1829-1895	
318	LG R6 G7	Humphreys	Martha Davies	1863-1947	
383	HW R10 G31	Humphreys	Mildred M	1892-1983	
29	H R1 G60	Humphreys	Morris J	1829-1899	
29	H R2 G61	Humphreys	Morris J	infant - died 12 Aug 1870	
383	HW R10 G32	Humphreys	Morris W	1883-1961	
335	HW R5 G20	Humphreys	Neva I	1917-2012	
53	H R5 G44	Humphreys	Robert	1887-1888	
335	HW R5 G17	Humphreys	Stanley	1891-1972	
335	HW R5 G18	Humphreys	Virginia M	1894-1978	
318	LG R6 G8	Humphreys	William McVey	1859-1941	
318	LG R5 G7	Humphries	Sara M	1891-1965	
318	LG R5 G8	Humphries	Walter J	1892-1957	
56B	G R23 G3	Hutchisson	Elbert J	1919-1992	
56B	G R23 G4	Hutchisson	Elizabeth I Penn	1918-1986	
253	E R5 G44	Hyatt	James D	1931	

253	E R5 G41	Hyatt	Juanita M Redman	1903-1983	
253	E R5 G43	Hyatt	Lillian I Chevalier	1926-1992	
253	E R5 G42	Hyatt Sr.	Charles T	1905-1984	
CE	E R1 G10	Hylton	Archie B	29 Apr 1874-1954	
224	E R1 G9	Hylton	Bertha E McMillin	1873-1968	
224	E R2 G11	Hylton	Chester	1901 - 1954	
410	LG R14 G18	Hylton	Chester Robert (CR)	1926-2008	WWII
410	LG R14 G17	Hylton	Eleanor Roberts	1901-1982	
410	LG R14 G20	Hylton	Jon & Carolyn	LIVING	
410	LG R14 G19	Hylton	Patricia (CR)	1928-2017	
224	E R2 G10	Hylton	Winona	infant dau of AB & BE Hylton	

LOT #	SECTION, ROW, GRAVE	LAST	FIRST	DATES	MILITARY
70B	G R2 G14	Jackson	Harold	1927-2013	WWII & KOREA
70B	G R2 G13	Jackson	Terri & Leona (CR)	T:1959-2007 L: 1922-1997	
179	NE R6 G3	James	Daniel G	1949 - 1949	
154	HE R11 G49	James	2 infants	NO MARKERS	
154	HE R12 G52	James	Alice C	1913-1982	
126	HE R7 G60	James	Anna Jones	1858 - 1930	
154	HE R11 G51	James	Anson Bradley	1871-1949	
123	HE R6 G58	James	Charles T	1881 - 1970	
255	E R3 G49	James	Cleo A Swam	1920-2007	
123	HE R6 G56	James	Clifford	1911-1989	WWII
74	G R5 G2	James	David A	1941 -	
126	HE R7 G61	James	David Kyle	1899 - 1909	
49B	G R12 G6	James	Dee Dee	8 Mar 1970 -	
154	HE R11 G52	James	Edward	1855-1932	
28B	G R13 G16	James	Elwin Lemuel	1922-2014	WWII
28B	G R13 G15	James	Eva Adlee	1926-2007	
255	E R3 G50	James	Glen Willis	1919-1998	
123	HE R6 G57	James	Hazel B	1888 - 1982	
123	HE R5 G56	James	Infant	NO MARKER	
123	HE R5 G57	James	Infant	NO MARKER	

154	HE R11 G50	James	Louise Robinson	1867-1908	
49B	G R12 G5	James	Mark	1 Jan 1963 -	
184	NE R5 G7	James	Mary A	1851-1937	
123	HE R5 G59	James	Mary Ellen Conklin	1862-1927	
154	HE R12 G49	James	Ora Myrtle Elliot	1891-1973	
126	HE R7 G62	James	Rev Thomas Price	1853 - 1911	
255	E R3 G47	James	Robert	1943 -	
179	NE R5 G5	James	Ruth Ann	1892-1967	
255	E R3 G48	James	Sue	1946 -	
74	G R5 G1	James	Vivian	1942 -	
179	NE R5 G6	James	Walter	1886-1952	
259	E R5 G50	James	William	1915 - 1995	
184	NE R5 G8	James	William	1863-1931	
230	E R1 G19	Jenkins	Dr. William	1852-1930	
230	E R2 G17	JENKINS	LARGE	MONUMENT	
230	E R1 G18	Jenkins	Mary E Thomas	1858-1921	
230	E R1 G17	Jenkins	Thomas S	1862-1907	
173	NE R1 G3	Jewell	Bertha Rachel	1877-1952	
173	NE R1 G1	Jewell	Sarah R	1909-1989	
173	NE R1 G4	Jewell	Walter T	1874-1989	
173	NE R1 G2	Jewell Sr	George R	1905-1966	

295	HW R4 G27	Jewett	Fannie M Bell	1899-1990	
295	HW R4 G28	Jewett	James Franklin	1895-1960	
250	E R5 G40	Jewett Jr	James Franklin	1919-1982	WWII
153	HE R10 G55	Johnson	Frances, Jessica both (CR)	F: 1902 -1999, J: 1934-1977	
317	LG R3 G6	Johnson	Grace E	1915-1974	
97	HE R6 G4	Johnson	Mary Katherine	1946-1951	
317	LG R3 G5	Johnson Jr	Herbert C	1918-1985	WWII
317	LG R4 G5	Johnson III	Herbert C	1951-1979	
21B	G R5 G20	Jolliff	Rodger L	1940-1996	
71	HE R3 G15	Jones	Anna M	1902 - 1971	
19	H R2 G39	Jones	Sarah Ella	1857-1918	
147	HE R10 G40	Jones	2 infants	NO MARKERS	
193	NE R5 G12	Jones	Ada Lloyd	1885-1985	
157	HE R9 G61	Jones	Ada Margaret	1866 - 1898	
205	NE R6 17	Jones	Ada May	1894-1945	
92	HE R4 G58	Jones	Allie Browning	1872 - 1954	
408	LG R14 G16	Jones	Anah B Roberts	1896-1988	
147	HE R10 G42	Jones	Angie Marie Owens	1894 - 1970	
120	HE R8 G51	Jones	Ann	1829 - 1917	
77	HE R1 G2	Jones	Ann Ingram	1843 - 1925	
113	HE R5 G38	Jones	Anna Davis	1855-1925	

152	HE R12 G45	Jones	Anna J	1867-1917	
157	HE R10 G61	Jones	Anna Margaret Reinhard	1912 - 1999	
423	N R2 G23	Jones	Avery I	1918-2006	WWII
78	HE R4 G31	Jones	Benjamin Burdette	1896-1899	
47	H R5 G33	Jones	Bennett	25 Jun 1866-30 Aug 1892	
47	H R5 G32	Jones	Bertham M	1877-1878	
346	HW R7 G39	Jones	Betty Jane	1923-2011	
139	HE R9 G24	Jones	Blanche		
155	HE R9 G58	Jones	Charles R	1862 - 1937	
105	HE R5 G20	Jones	Charles T	1908-1910	
155	HE R9 G57	Jones	Chess Hull	1863 - 1950	
157	HE R10 G62	Jones	Clarence Humphrey	1911 - 1986	
408	LG R14 G15	Jones	Clayton Russell	1895-1946	
185	NE R8 G8	Jones	Cora A	1876-1922	
13	H R1 G28	Jones	D Walter	1887-1966	
112	HE R8 G34	Jones	Daniel N	1853-1938	
105	HE R1 G15	Jones	David D	1856 - 1948	
????	HE R7 G18	Jones	David F	CANNOT LOCATE HIS GRAVE	CW??
317	HE R3 G59	Jones	David Lockport	1879 - 1916	
362	LG R4 G7	Jones	David T	1878-1958	
30	LG R10 G10	Jones	David Valentine	1879 - 1959	

407	H R3 G58	Jones	David W	1840-1891	CW
339	LG R12 G15	Jones	Douglas Wayne	1960-1960	
43	HW R5 G25	Jones	Edith	1917-1960	
19	H R6 G23	Jones	Edward	1820-1897	
120	H R2 G41	Jones	Edward E	1857-1934	
159	HE R8 G50	Jones	Edward J	1818 - 1900	
337	HE R9 G66	Jones	Edward O	1855 - 1929	
54	HW R5 G22	Jones	Edward T	1888-1974	
159	H R8 G43	Jones	Eleanor Evans	1829 - 1913	
157	HE R9 G65	Jones	Eleanor Nellie Jones	1865 - 1896	
159	HE R9 G62	Jones	Elias H	1859 - 1937	
77	HE R10 G65	Jones	Elizabeth Humphreys	1837-1915	
47	HE R1 G1	Jones	Elizabeth J	1869 - 1964	
47	H R5 G31	Jones	Ella B	1880-1894	
63	H R5 G30	Jones	Ellen B	1838-1917	
112	H R6 G65	Jones	Ellen T	1815-1887	
147	HE R8 G32	Jones	Elmer Ernest	1892-1942	WWI
92	HE R9 G42	Jones	Elnora	1862 - 1944	
152	HE R3 G56	Jones	Etta	Died 1947	
77	HE R12 G47	Jones	Evan C	1836-1899	
71	HE R1 G4	Jones	Evan Ingram	1867 - 1934	

139	HE R3 G14	Jones	Evan P "Hap"	1898 - 1971	
216	HE R9 G25	Jones	Evan T	1818 - 1896	
155	NE R19 G7	Jones	Frank	1860-1940	
18	HE R10 G58	Jones	Fred E	1896 - 1986	
147	H R3 G33	Jones	Freda A	1921-2000	
159	HE R10 G43	Jones	George Emmet	1894 - 1953	
371	HE R10 G66	Jones	George W	1839-1907	CW
339	HW R9 G7	Jones	Grace F	1897-1966	
32	HW R5 G26	Jones	Greenleaf	1897-1986	
35	H R4 G63	Jones	Gwen	3 Jun 1880	
193	H R6 G8	Jones	Gwendolyn	1909-1909	
92	NE R5 G14	Jones	Harold Lloyd	1910-1919	
54	HE R4 G59	Jones	Harry Stanwell	1874 - 1930	
13	H R8 G45	Jones	Harvey	unknown-1902	
185	H R1 G27	Jones	Hazel M	1893-1952	
185	NE R8 G6	Jones	Helen Springer	1868-1942	
134	NE R8 G7	Jones	Hosea	1872-1959	
134	HE R12 G9	Jones	Hugh E	1840-1916	
32	HE R12 G11	Jones	Hugh R	1876 - 1923	
65	H R4 G62	Jones	Infant	NO Grave Marker	
423	HE R2 G4	Jones	infant	NO Grave Marker	

95	N R1 G24	Jones	Irwin C	1898-1976	
60	HE R2 G61	Jones	Isaac D	1857-1887	
147	H R7 G57	Jones	Ishmael Andrew	1841-1906	CW
134	HE R10 G41	Jones	Jacqueline Luella	1923 - 1926	
63	HE R12 G12	Jones	James	1883-1918	
115	H R5 G63	Jones	Jane		Wife of Timothy G
408	HE R5 G42	Jones	Jane E	1822 - 1898	
105	LG R14 G13	Jones	Jeannette Ellen Ulmer	1920-1999	
115	HE R5 G22	Jones	Jennie E	1854-1920	
79	HE R5 G41	Jones	Jennie F	1860 - 1926	
19	HE R1 G14	Jones	Jennie Thomas	1859 - 1933	
63	H R2 G40	Jones	Jessie M., Sarah Ella	1880-1967	
60	H R5 G62	Jones	John A	1886-1909	
78	H R7 G58	Jones	John Andrew	15 Aug 1879-8 Dec 1909	
134	HE R4 G28	Jones	John Arthur	20 Dec 1886 - 15 Apr 1917	
78	HE R11 G11	Jones	John Elmer	1872-1936	
32	HE R4 G30	Jones	John P	19 Feb 1854 - 23 Jan 1929	
346	H R4 G64	Jones	John T	14 Jul 1893	
77	HW R8 G38	Jones	John W	1891-1960	
157	HE R1 G3	Jones	John Walter	1839 - 1912	
71	HE R10 G60	JONES	LARGE	MONUMENT	

112	HE R2 G14	JONES	LARGE	MONUMENT	
216	HE R7 G32	JONES	LARGE	MONUMENT	
35	NE R19 G6	Jones	Lucy	1860 - 1913	
90	H R6 G5	Jones	Lyda Jones	1880-1975	
18	HE R3 G54	Jones	Lydia A Williams	1844 - 1883	
157	H R3 G36	Jones	Mabel E	1885-1966	
423	HE R9 G63	Jones	Margaret L Hamner	1880-1959	
185	N R1 G23	Jones	Martha D	1897-1979	
60	NE R8 G9	Jones	Marvel Plows, Wyford both	M: 1912 - 2008 W: 1912 - 1993	
155	H R7 G56	Jones	Mary A	Jan 1839-	
152	HE R10 G57	Jones	Mary Elizabeth Dildine	1900 - 1984	
346	HE R12 G46	Jones	Mary Evans	1838-1923	
337	HW R8 G40	Jones	Mary Henrietta F	1914-2003	
30	HW R5 G21	Jones	Mary Mae	1887-1969	
362	H R3 G59	Jones	Mary W	May 1848 - 29 Jan 1928	
317	LG R10 G9	Jones	Minerva Biggerstaff	1881 - 1931	
112	LG R4 G6	Jones	Myrtle A	October 11 1877 - November 29	
193	HE R7 G35	Jones	Newton Alfred	1883 - 1966	
193	NE R5 G13	Jones	Owen R	1881-1961	
396	NE R5 G11	Jones	Pauline	1914-1933	
115	HW R12 G55	Jones	Pauline Freeman Timms	1911-2006	

92	HE R5 G43	Jones	Phillip	1820 - 1896	
113	HE R3 G57	Jones	Phoebe Settles	1854 - 1932	
79	HE R5 G37	Jones	R Edgar	1854 1926	
13B	HE R1 G16	Jones	Ray S	1886 - 1915	
30	G R22 G20	Jones	Rees Marvin	24 Dec 1919-6 Aug 2000	WWII
346	H R4 G59	Jones	Rees T	10 May 1804 - 11 Apr 1891	
159	HW R7 G40	Jones	Richard B	1921-1988	WWII
112	HE R9 G67	Jones	Richard M F "Merrick"	1859 - 1933	US Army
157	HE R8 G33	Jones	Rilla Grace	1 May 1855 - 5 Jan 1951	
13B	HE R9 G60	Jones	Robert T (infant)	1898-1898	
371	G R22 G19	Jones	Rose Ellen	31 Aug 1919-28 Dec 1988	WWII
35	HW R9 G6	Jones	Rossford	1890-1961	WWI
30	H R6 G7	Jones	Ruthella	13 Jan 1912-13 Jan 1912	
134	H R4 G58	Jones	Sarah E	May 1809 - 20 Feb 1884	
78	HE R12 G10	Jones	Sarah Price	1845-1908	
18	HE R4 G29	Jones	Sarah Pritchard	22 Jun 1856 - 16 Aug 1930	
47	H R3 G35	Jones	Thomas Arthur	1884-1965	
79	H R5 G29	Jones	Thomas B	1834-1923	CW
35	HE R1 G13	Jones	Thomas C	26 Feb 1893 - 15 Oct 1894	
18	H R6 G6	Jones	Thomas Emlyn	1876-1944	
63	H R3 G34	Jones	Thomas W	1922-2016	WWII

423	H R6 G63	Jones	Timothy G		Wife Jane A, son John A
115	N R2 G24	Jones	Vera I	1928-2020	
205	HE R5 G40	Jones	W Guy	1857 - 1918	
112	NE R6 16	Jones	Walter W	1884-1969	
408	HE R8 G35	Jones	William E	1889 - 1914	
78	LG R14 G14	Jones	William E "Billy"	1920-1993	
90	HE R3 G28	Jones	William P	15 Jul 1881 - 20 Feb 1931	
54	HE R3 G55	Jones	William W	28 Mar 1841 - 25 Nov 1915	CW
346	H R8 G44	Jones	William Walter	1825 - 1914	CW
147	HW R8 G37	Jones	Winifred Biggerst	1881-1944	
134	HE R9 G43	Jones	Wm H	1858 - 1928	
92	HE R11 G12	Jones	Wm M	1886-1925	
346	HE R3 G58	Jones Jr	David Lockport	1842 -1882	CW
267	HW R8 G39	Jones Jr.	John W	1915-1961	
267	HW R8 G39	Jones III	John W (CR)	1949-2000	
267	E R3 G66	Jordan	Frank Eugene	5 Nov 1928-24 Oct 2004	K
179	E R3 G65	Jordan	Joan L	29 Sep 1932- 16 Feb 2005	
179	NE R5 G3	Judson	Charles R	8 Apr 1936 - 14 Jul 2021	ARMY
179	NE R5 G4	Judson	Judy A	19 Jan 1939-11 May 2025	

LOT #	SECTION, ROW, GRAVE	LAST	FIRST	DATES	MILITARY
130	GW R1 G1	Kanniard	Dorothy	4 Aug 1934-23 Jan 2006	
130	GW R1 G2	Kanniard	Lester	3 Sep 1932-3 Sep 2008	K
42	H R8 G19	Keifer	Lyda Rodefer	1876-1897	
147	HE R9 G41	Kelber	Billie	1923 - 1943	
147	HE R9 G40	Kelber	Lucille Jones	1901 - 1927	
28B	G R14 G14	Kelley	Harley	1928-2003	WWII
28B	G R14 G13	Kelley	Mary	1932-2015	
374	HW R12 G12	Kerr	Chester Arthur	1894-1947	WWI
344	HW R7 G33	Kerr	Edith Jean Evans	1932-1996	
344	HW R7 G33	Kerr	Jean	1932-1996	
374	HW R12 G11	Kerr	Mary	1909-1977	
344	HW R7 G34	Kerr	Robert	1930-2006	K
121	GW R5 G8	Kidwell	David A	23 Jul 1945 - 8 May 2018	
448	N R11 G19	Kietzman	Clarence	1907-2002	
448	N R12 G18	Kietzman	Edna	1902-1997	
448	N R11 G18	Kietzman	Henrietta	1907-1982	
448	N R12 G19	Kietzman	Leonard	1905-1972	
14	GE R6 G28	King	Alan (CR)	1938 - 2008	
14	GE R6 G27	King	Janet	1939 -	
245	E R2 G38	Kirk	Clarence	1903-1962	

245	E R1 G37	Kirk	Cleo Louise	1907-1920	
245	E R1 G39	Kirk	Elizabeth Thomas	1878-1971	
245	E R2 G39	Kirk	Eloise Darling	1908-1994	
245	E R1 G38	Kirk	J Forest	1877-1957	
204	NE R4 G18	Kline	Carrie Patterson	1889-1961	
37B	G R17 G9	Knapp	Betty Jean Sprouse	12 Dec 1927-26 May 2014	
37B	G R17 G10	Knapp	Sandra Wigg (CR)	9 Oct 1946-9 Aug 2015	
37B	G R17 G10	Knapp Jr	Milton A	1947-1991	V
8	GN R8 G33	Knell	M Marie	2 Apr 1938 - 26 Dec 2006	
8	GN R8 G34	Knell	Richard W	9 Jan 1938 - 1 Jun 2006	
437	N R10 G20	Knickle	Ethel Hudson	1888 - 1947	
9	H R2 G18	Knobbs	Samuel	1825-1905	
9	H R2 G19	Knobbs	Sarah	1831-1913	
101	HE R6 G13	Koch	Ella Morris	1886 - 1959	
110	GN R7 G2	Krouse	Carl J	1932-2017	K
110	GN R7 G2	Krouse	Donald	1956-2019	
283	HW R3 G1	Kuba	Elizabeth Ann	1980-2004	
384	HW R12 G31	Kuhns	Albert Carl	1890-1942	
65B	G R8 G4	Kuhns	Charlotte Eleanor	1915-1997	
65B	G R8 G3	Kuhns	Dr John Wesley	1914-1987	
384	HW R12 G32	Kuhns	Margie May	1887-1973	

384	HW R11 G31	Kuhns Jr	Albert Carl	1926-1926	
226	E R5 G5	Kunce	Virginia Baldrige	1954-2013	
352	HW R8 G51	Kuntz	Addie Belle		
352	HW R8 G52	Kuntz	William A	1916-1937	
373	HW R7 G51	Kuntz	Wm J		

LOT #	SECTION, ROW, GRAVE	LAST	FIRST	DATES	MILITARY
7B	G R16 G22	Lafferty	Delmer	1942-1991	
218	NE R23 G6	Landers	Elbert D	1898 - 1919	
217	NE R21 G6	Landers	Elbert Gurley	1874-1920	
218	NE R23 G8	Landers	Sarah E Inskeep	1848-1918	
218	NE R23 G5	Landers	Gussie French	1877 - 1913	
321	LG R4 G15	Landon	Carrie B	1874-1952	
334	HW R7 G13	Landon	Danny Roy	12 Mar 1950 - 3 Aug 1969	V
426	N R4 G26	Landon	Donald F	1919-1988	WWII
424	N R4 G22	Landon	George (CR)	5 Jun 1926 - 16 Feb 1999	WWII
334	HW R8 G14	Landon	Helen Sartwell	1923-2004	
39B	G R13 G10	Landon	Jack R	18 Oct 1932-26 Feb 2001	K
426	N R3 G26	LANDON	LARGE	MONUMENT	
321	LG R4 G16	Landon	Lewis B	1868-1951	
426	N R4 G27	Landon	Margaret	1920-2018	
263	E R2 G63	Landon	Mary Louise	3 Jan 1912-7 Feb 1913	
424	N R5 G24	Landon	Patricia R (CR)	1930 - 2004	
334	HW R8 G13	Landon	Roy	1923-1967	
421	N R1 G20	Lane	Charles W	23 Jul, 1919-7 Nov, 1994	WWII
107	GN R7 G4	Lane	John E	9 Ju 1922-27 Dec 2009	WWII
421	N R2 G19	Lane	Keith Richard	16 Sep 1970-18 Sep 1970	

421	N R1 G19	Lane	Maude	26 Mar 1924-14 Feb 2012	
107	GN R7 G3	Lane	Ruth E Green	18 Mar 1926 - 6 Sep 2009	
38B	G R16 G12	Large	Goldie	8 Jan 1925-14 Jan 2003	
38B	G R16 G11	Large	Mont	3 Mar 1924-9 Mar 2000	
351	HW R5 G52	Lauer	"infant"	1942 & 1971	
351	HW R5 G50	Lauer	Betsy Lee	1941-	
351	HW R5 G51	Lauer	Evelyn w	1912-1990	
351	HW R5 G49	Lauer	Mariann	1944-	
287	HW R3 G12	Lavender	Hosea E	1891-1962	
228	E R4 G13	Lavender	Ida F Reed	1927-2010	
287	HW R3 G11	Lavender	Margaret Grace	1894-1980	
228	E R3 G14	Lavender Jr	Bobby Elwin	16 Aug 1957-28 Apr 2024	Firefighter
228	E R4 G14	Lavender Sr	Bobby Elwin	1924-2002	WWII
286	HW R2 G12	Lawhon	Susan	1955-2012	
199	NE R18 G4	Lawrence	Mary Isabelle Maize	1859-1919	
199	NE R18 G5	Lawrence	Wirt	1855-1932	
302	HW R1 G44	Lawson	Stacey Edward	1958-1991	
177	NE R1 G6	Layman Sr.	Charles H	1930-1991	
177	NE R1 G5	Layman	Marlene	1933-2005	
187	NE R12 G1	Lea	Edna B	1882-1966	
187	NE R12 G2	Lea	Orton G	1882-1942	

54	GW R11 G23	Lea McAfee	Joy Ellen	1979-2016	
31B	G R19 G14	Leasure	Gail (CR)	1921-2001	
31B	G R19 G13	Leasure	Mary Turner (CR)	1926-2000	
215	NE R17 G7	Lee	Blanche G	1892-1970	
234	E R4 G19	Lee	Carmen J Firstenberger	1930-2012	
307	HW R3 G52	Lee	Charles Rea (CR)	1904-1999	
215	NE R17 G9	Lee	Gladys	1896-1988	
235	E R5 G18	Lee	H Warren	1925 - 2009	
215	NE R17 G8	Lee	James S	1886-1955	
307	HW R3 G51	Lee	Mary J Davis (CR)	1911-1990	
215	NE R18 G8	Lee	Paul Lee (CR)	1948 - 2021	
215	NE R18 G7	Lee	Paul Wm.	1910 - 1970	
215	NE R18 G9	Lee	Phillip Lewis	15 Jun 1946- 17 Jun 1971	V (KIA)
234	E R4 G20	Lee	Robert E "Ed"	1921-2000	WWII
235	E R5 G17	Lee	Rosemary	1929 -	
215	NE R17 G6	Lee	Walter	1895-1977	
336	HW R8 G19	Lehner	Charles "Tom"	1948-2024	
29B	G R16 G16	Lehner	Charles E	1925-2015	WWII
94	GW R8 G17	Lehner	Christy	1976 -	
46B	G R5 G5	Lehner	Earl	7 May 1964 -	
46B	G R5 G1	Lehner	Earl Eli	1993-1997	

46B	G R5 G6	Lehner	Eleanor Elizabeth	14 May 1962 -	
336	HW R7 G19	Lehner	Ellis	4 Sep 1901-19 Mar 1992	
336	HW R7 G20	Lehner	Gladys	17 Nov 1898-30 Jan 1990	AR #39784!
292	HW R2 G23	Lehner	Goldie E	1902-1988	
29B	G R16 G15	Lehner	Lois VanAtta	1926-2007	
94	GW R8 G18	Lehner	Shawn	1978 - 2021	
292	HW R2 G24	Lehner	William G	1896-1973	WWI
199	NE R18 G3	Leonard	Edith Lawrence	1889-1926	
37	GE R8 G18	LeVan	Donnie	1965-2003	
37	GE R9 G17	LeVan	Stacey		
119	HE R5 G49	Lewis	Charles E	12 Dec 1863-28 Mar 1938	
11	H R1 G23	Lewis	Daniel E	Dec. 1945 -	
119	HE R5 G48	Lewis	Emma T	12 Jul 1862-30 May 1938	
11	H R1 G21	Lewis	Esther M	1897-1963	
117	HE R5 G45	Lewis	Florence	23 Feb 1895-14 Jul 1982	
119	HE R5 G51	Lewis	George	5 Jun 1893 - 10 Dec 1962	WWI
119	HE R5 G50	Lewis	Hannah T	10 Dec 1865-17 Feb 1895	
11	H R1 G24	Lewis	Judson E	1892-1969	
11	H R2 G22	Lewis	Mary J	6 Jul 1886- 20 Aug 1900	
117	HE R5 G46	Lewis	Mary S	1863 - 1926	
11	H R2 G23	Lewis	Samuel	8 Aug 1832- 21 Feb 1901	CW

117	HE R5 G47	Lewis	Thomas S	27 Dec 1857-11 Nov 1932	
11	H R1 G22	Lewis	Veta L	1952-2021	
370	HW R12 G4	Liggett	Adaline	1929-1993	
226	E R6 G5	Likens	Barbara A Neville	22 Dec 1932-18 Apr 2012	
226	E R6 G6	Likens	Charles Edward	6 Jan 1935-2 Feb 2000	
66B	G R3 G2	Likens	James Lewis	1970-1991	
66B	G R3 G1	Likens	Jemima		
66B	G R4 G1	Likens	Lisa M	19 Jul 1967-8 Feb 2001	
226	E R5 G6	Likens	Steve (CR)	11 Feb 1964-8 Jul 2022	
66	GE R1 G14	Likens	Timothy Lee	1963 - 2014	
66B	G R4 G2	Likens	W Russell	1967 -	
155	HE R10 G56	Linn	Cecilia A Johnson	1927-2000	
23	H R1 G48	Livisey	E J	NO MARKER	
23	H R1 G47	Livisey	Isabelle	NO MARKER	
6	H R4 G9	Lloyd	Benjamin	1843-1922	
212	NE R11 G11	Lloyd	Evan W	1856-1898	Mex Amer
11B	G R23 G21	Lloyd	Florence M	1915-2011	
431	N R8 G6	Lloyd	George W	1913-1975	
212	NE R12 G12	Lloyd	Guy A	1889-1966	
60	H R7 G55	Lloyd	Jane Rees	1814 - 1880	
60	H R7 G54	Lloyd	John	1809-1887	

6	H R4 G10	Lloyd	Margaret	1849-1932	
212	NE R12 G11	Lloyd	Marie Theresa	1893-1950	
431	N R8 G5	Lloyd	Mildred J	1916-2001	
212	NE R12 G10	Lloyd	Robert C	1916-1916	K
11B	G R23 G22	Lloyd	Stanley	1910-1998	
212	NE R11 G10	Lloyd	Susan C	1864-1946	
241	E R5 G27	Lobdell	Ardith	1946 - 2023	
241	E R5 G28	Lobdell	Kenneth (CR)	1938 - 2019	USAF
303	HW R3 G41	Lockhart	Bessie A	1885-1973	
303	HW R3 G43	Lockhart	Elizabeth-infant	1918	
302	HW R2 G41	Lockhart	Helen E Rowland	1903-1974	
302	HW R2 G42	Lockhart	Ira Raymond	1901-1957	
303	HW R3 G42	Lockhart	John Clinton	1880-1943	
302	HW R2 G44	Lockhart	Leo Osal	1910-1979	
407	LG R12 G13	Lockhart	Margaret J Thomas	1915-1987	
302	HW R2 G43	Lockhart	Mildred Dowell	1911-2008	
407	LG R12 G14	Lockhart	Virgil Asa	1913-1976	
158	HE R11 G60	Lodwig	Harry J	1882 - 1971	
158	HE R11 G59	Lodwig	Mabel Jones	1890 - 1932	
80	GE R2 G10	Long	Harry	1937 - 2012	
59	H R6 G54	Loveless	Erdean	1909-1919	

214	NE R16 G9	Low	Charles Jerome	1899 - 1970	WWI
214	NE R15 G9	Low	Fred C	1901-1919	
416	N R4 G7	Lowe	Mary K James (CR)	1924-2013	
416	N R4 G8	Lowe	Orville Raymond	1942-1996	
36B	G R19 G10	Lucas	Leslie	1935-1995	
323	LG R3 G20	Lugger	Mary M	1878-1968	
323	LG R4 G20	Lugger	William H	1883 - 1957	
13B	G R22 G17	Luikart	Eliza Stutler	1928-2004	
13B	G R22 G18	Luikart	Lawrence E	1927-1993	
262	E R6 G53	Luikert	George Earl	6 Feb 1949 (infant)	
37	GE R8 G19	Lukas	Annetia	1927 -	
37	GE R8 G20	Lukas	Lawrence L	1924-2009	K
22B	G R4 G19	Lynn	Amy Clevenger	1973-2017	

LOT #	SECTION, ROW, GRAVE	LAST	FIRST	DATES	MILITARY
197	NE R13 G8	Macklin	John	1892-1980	
197	NE R13 G7	Macklin	Martha E	1893-1969	
435	N R9 G15	Magrew	Carolyn Sue (CR)	1 Sep 1939 - 19 Jul 2021	
40	H R8 G16	Magrew	Elizabeth Perry	died 1897	
40	H R8 G15	Magrew	Mahala Terrell	1899-1969	
435	N R8 G13	Magrew	Mary E	22 May 1917- 18 Apr 1998	
435	N R8 G14	Magrew	Robert T	7 Jan 1917 - 30 Jun 1995	
435	N R8 G16	Magrew	Sally K (CR)	29 Jan 1943 - 2 Dec 2008	
40	H R7 G15	Magrew Jr	Edward	1896-1939	
40	H R7 G16	Magrew Sr	Edward	1859-1945	
118	HE R7 G47	Main	Cleo L	21 Apr 1897 - 3 Sep 1898	
118	HE R7 G45	Main	James H	1858 - 1922	
118	HE R7 G44	Main	Maggie	1863 - 1951	
329	HW R5 G6	Marks	Florence	1886-1970	
329	HW R6 G6	Marks	Mary Frances	1920-1992	
329	HW R6 G5	Marks	Miriam L	1912-1916	
34B	G R24 G11	Marks	Virginia Thomas	1922-2001	
34B	G R24 G12	Marks	W Dale	1917-1985	
329	HW R5 G5	Marks	Wm H	1883-1939	
139	HE R10 G26	Martin	Becky	no marker	

112	HE R7 G34	Martin	Esther	1885-1966	
112	HE R7 G33	Martin	Richard Ralph	1888-1978	
128	GW R3 G3	Martin	Teresa Rinehart (CR)	15 Aug 1972 - 28 Oct 2022	
67	GN R7 G14	Mason	David	1964 -	
67	GN R7 G13	Mason	Melinda Mick	1967 -	
67	GN R7 G15	Mason	Morgan Marie	1990-2013	
182	NE R2 G11	Mathews	Henry H	1913-1985	
182	NE R2 G12	Mathews	Rose	1914-1999	
257	E R2 G56	Matlack	John B	20 Jun 1864 - 25 Sep 1925	
415	N R1 G7	Matlack	Laura F Thomas	1911-1985	
257	E R2 G55	Matlack	Margaret J	28 Sep 1872 - 18 May 1957	
415	N R1 G8	Matlack Sr.	Everett Maywood	1907-1979	
438	N R7 G25	Maxwell	Warren	1914 - 1959	
438	N R6 G26	Maxwell	Donald W	1936-2013	
438	N R5 G24	Maxwell	Janet	1915 - 1983	
438	N R6 G25	Maxwell	Lois A	1936-2022	
13	H R1 G25	Maxwell	Sara Jane	1927-2000	
13	H R1 G26	Maxwell	Theodore P	1919-1994	
33	GE R2 G26	May	James	1951 - 2019	
362	LG R10 G11	Mayes	Ray Wilson	1912-1974	
48	H R8 G31	Mayfield	Bessie	1884 - 1903	

48	H R8 G30	Mayfield	Mary Ellen Ella	1872 - 1894	
2	H R3 G1	McALLISTER	LARGE	MONUMENT	
2	H R4 G2	McAllister	Mary	unknown-1930	
2	H R4 G3	McAllister	Wallace	9 Jul 1841 - unknown	
266	E R2 G67	McCall	Frances R Brocklesby	27 Jan 1912-18 Jun 1993	
81	HE R1 G9	McClaskey	Charles	1893 - 1977	
69	HE R2 G9	McCLASKEY	LARGE	MONUMENT	
81	HE R1 G11	McClaskey	Margaret J Kisner	1934 - 2009	
81	HE R1 G10	McClaskey	Roy Earl	1922 - 1981	
300	HW R1 G39	McCombs	Chester Ivan	1894-1978	WWI
300	HW R1 G38	McCombs	Mary Ellen	1894-1970	
225	E R4 G7	McCumber	Agnes L Goodman	28 Jul 1930-2 May 2000	
225	E R4 G8	McCumber	James Lemuel	13 Feb 1930-26 Apr 2004	K
222	E R3 G4	McCumber	Mabel E Foor	1934-2010	
222	E R3 G3	McCumber Jr	Harold T	1927-1994	
234	E R4 G22	McDaniel	Leah Cox	1890-1947	
260	E R2 G59	McDaniel	Pauline Prichard	1899 - 1975	
5	GN R1 G40	McGlothlin	Lisa Renee Clark	27 Aug 1970-23 Mar 2022	
331	HW R5 G11	McKibben	Marjorie	1926-1965	
331	HW R5 G10	McKibben	Richard	1926-1965	WWII
151	HE R10 G51	McKim	Floyd, Pauline G	F:1898-1920 P:1917-1918	

82	HE R4 G38	McKinnie	James R	1797 - 1869	
82	HE R4 G39	McKinnie	Margretta Campbell	1805 - 1867	
188	NE R13 G3	McKitrick	Floyd D	1877-1963	
188	NE R13 G1	McKitrick	Geneva I	1904-1934	
188	NE R13 G2	McKitrick	Mrs Nellie	1876-1945	
388	HW R11 G38	McNamee	Emma Jane Se	1864-1939	
387	HW R10 G37	Mead	Raymond (CR)	1913-1950	
264	E R1 3	Meade	Andrew J	26 Aug 1882 - 1 Dec 1964	WWI
85	GE R5 G2	Meddles	Charles "Bud" (CR)	1929-2019	K
85	GE R5 G1	Meddles	Mary	1933-2008	
182	NE R2 G10	Mehaffey	Charlotte Matthews	1934-2009	
46	H R7 G29	Merchant	Agnes	1860-	
46	H R7 G25	Merchant	Eugene	1869-	
44	H R7 G23	Merchant	Eulalia Blanche	1870-1928	
44	H R7 G22	Merchant	James B	1858-	
46	H R7 G28	Merchant	Jessie	1876-	
46	H R7 G26	Merchant	John R	1872-	
46	H R7 G27	Merchant	Larimer	1867-	
323	LG R4 G19	Meredith	Cora L	1874-1954	
323	LG R4 G18	Meredith	Daniel	1874-1951	
323	LG R3 G19	Meredith	Edward J	1888-1978	

8	H R3 G15	Meredith	Gladys Mae Osborn	18 Nov 1894 - 22 Jan 1944	
342	HW R7 G32	Merkel	Robert	1936-2006	
342	HW R8 G32	Merkle	Charles Otto	1904-1991	
342	HW R8 G31	Merkle	Doris Carnes	1906-1952	
374	HW R11 G10	Metzger	William A C	1911-1974	
68B	G R1 G8	Meyer	Richard Carey	1923-2008	WWII
68B	G R1 G7	Meyer	Suzanne Penry	1925-2020	
293	HW R3 G22	Miller	Arthur C	1897-1971	
395	HW R10 G54	Miller	Arthur Harmon	1897-1971	
187	NE R12 G3	Miller	Cloebelle	1910-1998	
173	NE R2 G2	Miller	Denny Joe	1955-1973	
177	NE R2 G6	Miller	Franklin Carey	1935-1989	
173	NE R2 G1	Miller	George E	1930 - 2015	K
187	NE R11 G4	Miller	George W	1871-1952	
172	HE R9 G1	Miller	infant	NO MARKER	
73	HE R2 G19	Miller	John J	1849-1921	
73	HE R2 G17	Miller	Laura	1878-1896	
173	NE R2 G4	Miller	M Arlene	1937 -	
395	HW R10 G56	Miller	Margaret C Frie	1913-1967	
395	HW R10 G55	Miller	Marie Hammon	1899-1962	
286	HW R1 G11	Miller	Mildred	1932-1954	

187	NE R11 G3	Miller	Millie Darst	1868-1931	
425	N R2 G27	Miller	Ray W	1899-1986	
73	HE R2 G18	Miller	Susan	1847-1894	
		Miller	Theodore A		WWII
293	HW R3 G21	Miller	Vera B	1897-19__	
187	NE R12 G4	Miller	Wesley J (CR)	1932-2020	Army Reserve
187	NE R12 G4	Miller	Wallace	1907-1967	
173	NE R2 G3	Miller	Wilma Jane	1932 -	
287	HW R4 G12	Millhon	Mary E	1899-1976	
287	HW R4 G11	Millhon	William M	1899-1963	
129	GW R2 G7	Milligan	Barbara	1951-2018	
282	HW R2 G2	Milligan	Doris Ward	1916-2001	
447	N R12 G16	Milligan	Everett F	1918-1973	WWII
282	HW R2 G3	Milligan	Gailord Henry	1914-1995	
406	LG R13 G11	Milligan	Hazel G Caffee	1895-1946	
344	HW R7 G36	Milligan	infant	Unknown-1948	
58B	G R20 G4	Milligan	Larry		
58B	G R20 G3	Milligan	Mary Anne Wilson	1942-1995	
344	HW R8 G35	Milligan	Ona F Rowland	1917-1994	
237	E R3 G24	Milligan	Ora M Bill	1887-1966	
441	N R 11 G4	Milligan	Patrick	1946-1982	V

406	LG R13 G12	Milligan	Robert Earl	1896-1943	WWI
447	N R12 G16	Milligan	Ruth Rowland	1918-1981	
344	HW R7 G35	Milligan	Sheila E Aldrich	1951-2024	
129	GW R2 G8	Milligan	Wayne L		
344	HW R8 G36	Milligan	Wilbert	1909-1970	WWII
237	E R3 G23	Milligan	William J	1877-1966	
42B	G R8 G11	Milum	Cecil S	1933-2015	
42B	G R8 G12	Milum	Joyce E	1937-2014	
98	GW R1 G15	Mitchell	Donald	2 Jul 1941-	
417	N R1 G10	Mitchell	Harold R	1921-2002	
417	N R1 G9	Mitchell	Lois E	1934 -	
98	GW R1 G16	Mitchell	Marcia G	1944 - 2014	
43B	G R5 G12	Mitchell	Marilou (CR)	1935-2025	
61B	G R14 G4	Mitchell	Ruth D	5 Oct 1915-25 Sep 1994	
61B	G R14 G3	Mitchell Sr	Densel	4 May 1915-12 Jan 2004	
438	N R7 G26	Mohler	John Frank	1920 - 1972	WWII
254	E R1 G50	Mohr	Margaret C Thomas	1882-1955	
254	E R1 G49	Mohr	Roy Henry	1878-1944	
10B	G R21 G21	Monks	Gayle Elizabeth	1951-2024	
10B	G R22 G22	Monks	Martha Joan Jones	1917-2006	
10B	G R22 G21	Monks	Wilbur Edwin	1917-1979	WWII

442	N R12 G7	Moore	Dorothy V	1912-1986	
49	H R5 G34	Moore	Edward	Unknown - 1893 only the base & name remain	
442	N R12 G8	Moore	Elmer Thomas	1915-1989	
49	H R5 G37	Moore	Henry Monroe	1860-1932	
49	H R5 G36	Moore	Lucy A	1862-1936	
387	HW R9 G39	Morgan	Arlie Lewis	1915-2014	
387	HW R9 G38	Morgan	Charles "Shorty"	1910-1977	
291	HW R4 G18	Morgan	David	1875-1960	
387	HW R10 G38	Morgan	Donald	1941-1943	
291	HW R4 G17	Morgan	Rose C	1888-1970	
150	HE R12 G41	Morris	Agnes	1903 - 1904	
150	HE R11 G42	Morris	Ann (Mrs David)	1812-1851	
150	HE R12 G43	Morris	Archie Wilbur	1879 - 1942	
149	HE R10 G45	Morris	Bert	1879 - 1944	
295	HW R3 G28	Morris	Bert	1905-1956	
391	HW R10 G48	Morris	Charles Ray	1927-1935	
262	E R5 G55	Morris	Clyde Wilbur	31 Jul 1894-17 Mar 1976	WWI
150	HE R11 G41	Morris	David	1805-1845	
99	HE R5 G9	Morris	Ella Tuste	1862 -1918	
202	NE R23 G2	Morris	Elmer "Turk"	1877 - 1936	
150	HE R11 G43	Morris	Infant David	1844 - 1845	

99	HE R5 G11	Morris	John	1880 - 1905	
149	HE R9 G46	Morris	John	1827 - 1910	CW
99	HE R5 G8	Morris	John Charles "Ray"	1856 - 1913	
149	HE R10 G44	Morris	Leona H	1884 - 1984	
101	HE R6 G12	Morris	Lulu	1883 - 1974	
391	HW R10 G47	Morris	Mary E	1903-1969	
150	HE R12 G42	Morris	Mary Thomas	1876 - 1963	
149	HE R9 G47	Morris	Mildred	1918 - 2012	
149	HE R10 G47	Morris	Norman Edwin	1930 - 1931	
149	HE R9 G45	Morris	Sarah J	1833 - 1915	
99	HE R5 G10	Morris	Walter C	1885 - 1909	
149	HE R10 G46	Morris	William Burton	1915 - 1916	
149	HE R9 G44	Morris	Wm R	1864 - 1943	
409	LG R11 G18	Morrison	Baby Dallas	1925-1925	
14	H R4 G27	Morrison	Bennett	1903-1906	
14	H R4 G26	Morrison	Edmon W	1874-1963	
14	H R4 G25	Morrison	Elizabeth E	1874-1959	
409	LG R12 G19	Morrison	George N	1887-1947	
14	H R4 G28	Morrison	Infants	2	
409	LG R11 G20	Morrison	Leon C	1916-1967	WWII
409	LG R12 G18	Morrison	Myrtle E Thompson	1896-1988	

409	LG R11 G19	Morrison	Nekoda	aka George N	
18B	G R11 G20	Mullins	Bert B	1935-2000	
18B	G R11 G19	Mullins	Bonnie Yates	1936-2016	
18B	G R12 G19	Mullins	Melinda		
244	E R6 G30	Murphy	Edward Lee	1921-1988	WWII
244	E R6 G29	Murphy	Mildred M Parrish	1926-2004	
378	HW R12 G20	Musser	Margaret Edwa	1876-1960	
378	HW R12 G19	Musser	Thomas	1880-1948	
2B	G R5 G23	Mussman	Camilla (CR)	1927-2005	
2B	G R5 G24	Mussman	M Courtland "Milt" (CR)	1926-2000	WWII

LOT #	SECTION, ROW, GRAVE	LAST	FIRST	DATES	MILITARY
395	HW R9 G53	Neff	Anna	1883-1958	
395	HW R10 G53	Neff	Francis Eliz	1919-1935	
395	HW R9 G54	Neff	Irvin	1876-1961	
309	HW R3 G53	Neff	Pearl E	1916-2017	
309	HW R3 G54	Neff	Russell L	1911-1995	
109	GE R4 G4	Neville	Beverly N	1959-2020	
86	GE R3 G5	Neville	Candace S Brokaw	1963-2017	
109	GE R3 G3	Neville	Carol A Elliott	1937-2015	
86	GE R3 G6	Neville	Jeffrey E	1958-2018	
86	GE R4 G7	Neville	Jennifer	1987-2009	
86	GE R4 G6	Neville	Joseph Alan	1962-2017	Army
109	GE R3 G4	Neville Jr	Phillip Franklin	1934-2008	V
256	E R5 G47	Newell	Dorothy	1915 - 2008	
151	HE R10 G48	Newell	Helen E McKim	1897 - 1973	
256	E R6 G48	Newell	James L (CR)	1933-2013	K
256	E R5 G48	Newell	Leo	1914 - 1998	
256	E R6 G47	Newell	Shirley E Brown	1934-2024	
264	E R4 G59	Nichols	Ivadell Warren	1903 - 1984	
264	E R4 G60	Nichols	Robert	1903-1974	
35B	G R22 G11	Nicholson	Elinor Glessner	1916-2008	

35B	G R22 G10	Nicholson	Mary Elinor		
35B	G R22 G12	Nicholson II	Guy Christopher	1918-1996	WWII
44B	G R3 G12	Nist	Dorothy A	1928-2025	
44B	G R3 G11	Nist	Floyd L	1928-1998	
126	HE R7 G63	Norris	Mary Ann James	1876 - 1954	
64	GE R5 G12	Norris	Robert E	1944-2024	Army/Air Natl Guards

LOT #	SECTION, ROW, GRAVE	LAST	FIRST	DATES	MILITARY
65	G R7 G2	Odessky	Norman	1934 - 1986	
337	HW R6 G22	Oehler	Carol Ann Clark	1937-1980	
388	HW R11 G39	Oehler	Eleanor M Crigler	1909-1989	
337	HW R6 G21	Oehler	Robert E	1937-1984	
388	HW R11 G40	Oehler Sr	Robert E	1906-1990	
66	HE R2 G6	Osborn	Andrew (Jack)	1862-1957	
321	LG R4 G14	Osborn	Carroll	1908-1988	
420	N R4 G14	Osborn	Carroll	1908-1988	
321	LG R4 G13	Osborn	Catherine W	1916-1986	
420	N R4 G13	Osborn	Catherine W	1916-1986	
52	H R8 G41	Osborn	Charles Verner	1860-1885	
183	NE R4 G9	Osborn	Dallas L	1891-1966	
183	NE R4 G8	Osborn	Della M Hinderlong	1886 - 1928	
66	HE R4 G7	Osborn	Dorothy	1892 - 1915	
66	HE R4 G5	Osborn	Emma C	1868-1936	
324	LG R5 G20	Osborn	Helen I	1900-1970	
66	HE R4 G4	Osborn	Isabella	1936-1905	
8	H R4 G15	Osborn	James G	1864-1952	
52	H R8 G38	Osborn	James Parce	1834 - 1927	
52	H R8 G39	Osborn	Margaret Lloyd	1937 - 1911	

235	E R6 G18	Osborn	Martha Jones	1872-1908	
137	HE R9 G23	Osborn	Peter G	1847 - 1905	
324	LG R5 G19	Osborn	William Floyd	1901-1973	
100	HE R7 G8	Oswald	Arthur	1924 - 2010	WWII
100	HE R7 G8	Oswald	Davena Thomas	1926-2002	
296	HW R1 G30	Oswald	Della M	1880-1963	
296	HW R1 G32	OSWALD	LARGE	MONUMENT	
296	HW R2 G29	Oswald	Paul W	1916-1998	
296	HW R2 G30	Oswald	Rosalie	1926-2003	
296	HW R1 G29	Oswald	Tracy L	1881-1955	
375	HW R10 G14	Owens	Betty Louise	1914-1985	
374	HW R12 G10	Owens	Clyde	1901-1976	
183	NE R3 G10	Owens	Esther Maxine	1916-1981	
183	NE R3 G11	Owens	Myrtle Anne	1904-1937	
374	HW R12 G9	Owens	Nellie	1903-1993	
183	NE R4 G11	Owens	Oliver I	1875-1928	
375	HW R10 G13	Owens	Paul Oliver	1910-1990	WWII
183	NE R4 G10	Owens	Rosa May Ayers	1874-1939	

LOT #	SECTION, ROW, GRAVE	LAST	FIRST	DATES	MILITARY
		Patterson	Carl E		K
262	E R5 G53	Packer	Charles		
354	HW R7 G56	Patterson	Clara Louise	1929-1985	
204	NE R4 G20	Patterson	Harry R	1894-1938	
74	GW R6 G21	Paul	Shirley Weber (CR)		
358	LG R10 G4	Pearl	Florence Louise	01/21/1931 12/13/1937	
358	LG R10 G2	Pearl	Harry Smith	05/29/1888 02/05/1967	WWI
358	LG R10 G3	Pearl	Margaret D. David	06/12/1894 12/16/1952	
221	E R1 G7	Peel	Alpheus Austin	1859-1917	
219	E R2 G4	Peel	Baby		
19	H R1 G38	Peel	Charles F	1879-1957	SP AM
221	E R1 G8	Peel	Clayton Russell	8 Aug 1899-29 May 1941	
19	H R1 G37	Peel	Elizabeth	1873-1946	
221	E R2 G5	PEEL	LARGE	MONUMENT	
221	E R1 G6	Peel	Margaret Wirth	1861-1941	
221	E R2 G6	Peel	Ollie Marie Evans	1895-1985	
221	E R2 G8	Peel	Pearl Robert	6 Dec 1883-18 May 1932	WWI
221	E R2 G7	Peel	William J	17 Dec 1895-7 Feb 1963	WWI
232	E R5 G16	Pence Sr	Larry D	15 Dec 1952-15 Nov 1984	
55B	G R24 G7	Penhorwood	Luella Ruth	1917-2010	

55B	G R24 G8	Penhorwood	Olen Burl	1913-2006	
128	HE R7 G65	Penry	Anna Gertrude Roberts	1870 - 1959	
33	H R5 G4	Penry	Baby Boy	died 27 Apr 1910	
70B	G R2 G16	Penry	David M	1940-2009	
70B	G R2 G15	Penry	Doris J	1943 -	
33	H R6 G3	Penry	Evan William	1914-2000	
33	H R5 G2	Penry	Katherine Stratton	1886-1920	
33	H R6 G4	Penry	Leona Fickel	1913-1971	
128	HE R8 G67	Penry	Louise		
128	HE R8 G67	Penry	Walter	1812-1878	
128	HE R8 G67	Penry	David S	1857-1870	
128	HE R8 G67	Penry	EvanE	1859-1876	
128	HE R8 G65	Penry	Lyda May	1 Jan 1870 - 11 Sep 1871	
126	HE R8 G63	Penry	Margaret L	1878 - 1899	
128	HE R8 G66	Penry	Mary B	Aug 1858 - Jan 1864	
128	HE R7 G66	Penry	Miriam Reed	1906 - 2000	
128	HE R7 G64	Penry	Randy Lee (CR)	died 1960	
128	HE R7 G64	Penry	Wm P	1864-1955	
128	HE R8 G68	Penry	Walter Guy	1896 - 1992	WWI
128	HE R8 G64	Penry	Walter S	Jan 1867 - Jun 1872	
33	H R5 G3	Penry	William Arthur	1883-1927	

236	E R1 G27	Penry	William W	1851-1918	
236	E R1 G26	Penry	Elizabeth A Miller	1855-1931	
83	HE R2 G37	Perry	Alice E	1880 - 1906	
83	HE R2 G40	Perry	Bessie	in infancy	
83	HE R2 G40	Perry	William	in infancy	
40	H R7 G14	Perry	Caroline	1859-1931	
83	HE R1 G38	Perry	Charles	1873 - 1926	
81	HE R1 G37	Perry	David D	1836 1906	
83	HE R2 G39	Perry	Hugh J	1833 - 1899	CW
40	H R8 G13	Perry	Margaret Thomas	1833-1900	
40	H R7 G13	Perry	Robert Thew	1848 - 1916	CW
40	H R8 G14	Perry	Samuel	1825-1914	
83	HE R2 G38	Perry	Sarah Anderson	11 Nov 1840 - 19 Apr 1923	
111	GN R4 G4	Pesout	Joan C Marks	11 Oct 1932 - 14 May 2018	
261	E R4 G56	Petty	Conda Lewis	8 Mar 1874 - 30 Dec 1951	
261	E R4 G55	Petty	Lucy Mary Jane Russell	17 Mar 1875 - 4 Jun1951	
103	GN R12 G12	Pfarr	Ted L	1948-2024	
314	LG R2 G13	Pheasant	Frank C	1904-1987	
314	LG R2 G14	Pheasant	Katherine	1909-1970	
314	LG R2 G15	Pheasant	Lora	1904 - 1953	
115	HE R6 G42	PHILLIP JONES	LARGE	MONUMENT	

311	LG R2 G2	Pigg	George T	1924-1982	WWII
311	LG R2 G1	Pigg	Jean Anne	1926-2012	
240	E R3 G29	Plymale	Carol Lumbard	1934-2019	
240	E R3 G30	Plymale Sr	Roy	LIVING	K
178	NE R3 G4	Poland	Bessie M	1887-1963	
178	NE R3 G5	Poland	Samuel C	1883-1945	
48	GW R6 G29	Ponstingle	Goldie Sedlon	1943-2023	
48	GW R6 G30	Ponstingle	Tim	1942 -	
6	H R4 G12	Powell	Anna E	1863-1942	
322	LG R6 G13	Powell	David H	1880-1959	
322	LG R5 G14	Powell	Edwin K	1886-1965	
322	LG R6 G14	Powell	John W	1878-1959	Sp-Am
322	LG R6 G16	Powell	Margaret Humphreys	1900 - 1969	
322	LG R5 G13	Powell	Theo M	1888-1974	
322	LG R6 G15	Powell	William R	1876 -1967	
289	HW R4 G15	Powers	Esther (Mrs.)	1895-1964	
45	H R5 G25	Price	Alice	1864-1950	
45	H R5 G26	Price	Cad	1861-1922	
106	HE R8 G22	Price	Charles N	2 Sep 1868 - Jun 1923	
125	HE R5 G63	Price	David	9 Oct 1856 - 22 Dec 1888	
251	E R1 G45	Price	Donna M	1873-1972	

251	E R2 G47	Price	Doris Ilene	1925-1975	
63B	G R9 G3	Price	Doris Wilkinson	1925-1994	
106	HE R8 G21	Price	Earl Emerson	1899 - 1928	
104	HE R8 G19	Price	Edith	1891-1973	
104	HE R8 G18	Price	Elizabeth	1873 - 1952	
15	H R2 G31	Price	Elizabeth A Jones	1848-1926	
111	HE R5 G35	Price	Evan	1851 - 1925	
125	HE R5 G62	Price	Evan	1820-1894	
133	HE R10 G12	Price	Florence	1897 - 1977	
251	E R1 G47	Price	Fred D	1913-1971	
13	H R2 G28	Price	Gertrude D	1897-1899	
133	HE R10 G14	Price	Infant Rodman	1912	
34	H R8 G4	Price	John		
15	H R2 G32	Price	John A	1845-1917	CW
445	N R11 G11	Price	John C	1906-1994	
251	E R1 G46	Price	John M	1872-1956	
125	HE R5 G60	PRICE	LARGE	MONUMENT	
106	HE R7 G20	PRICE	LARGE	MONUMENT	
34	H R7 G2	Price	Mabel Rose Martin	1893-1922	
95	HE R2 G62	Price	Marcy Rachel "Mollie"	1859 - 1866	
95	HE R2 G62	Price	Elizabeth Ann	1847-1855	

125	HE R5 G61	Price	Margaret	1854-1877	
111	HE R6 G34	Price	Margaret A	1852 - 1932	
15	H R2 G30	Price	Margaret J	1876-1927	
106	HE R8 G20	Price	Martha Josephine	1903 -	
34	H R8 G1	Price	Mary		
106	HE R8 G23	Price	Mary Ann	17 Jun 1868 - 31 Dec 1939	
133	HE R9 G14	Price	Mary Elizabeth Jones	29 Nov 1866 - 12 Dec 1950	
251	E R1 G48	Price	Mary George	1912-1991	
445	N R11 G12	Price	Mildred L	1906-1996	
15	H R1 G31	Price	Miss Mary	1885-1966	
251	E R2 G46	Price	Nancy Lee	11 Jan 1934 - 11 Jan 1934	
252	E R3 G46	Price	Paul	1936-2025	
13	H R2 G27	Price	Robert	1847-1912	
310	HW R3 G57	Price	Ronald Victor	1942-2010	USMC
13	H R2 G26	Price	Sarah	1858-1939	
34	H R8 G3	Price	Sarah		
34	H R8 G2	Price	Thomas		
15	H R1 G32	Price	Thomas A	1893-1963	
104	HE R8 G17	Price	Thomas R	20 Mar 1864 -10 Jan 1929	
34	H R7 G3	Price	Thomas Raymond	1891-1971	
133	HE R10 G13	Price	Walter E	1896 - 1958	

133	HE R9 G15	Price	William	4 Feb 1859 -1 Jul 1908	
63B	G R9 G4	Price	William M	1918-1950	
34	H R7 G4	Price	William Reece	1879-1924	
437	N R10 G19	Price	Wilma Knickle Paulins	1908 - 2003	
251	E R2 G45	Price Jr	John Evan "Jack"	13 Nov 1947 - 22 May 1966	
251	E R2 G48	Price Sr	John Evan	20 Feb 1920 - 10 Sep 2001	WWII
156	HE R12 G55	Prichard	Benjamin	1866-1910	
260	E R1 G60	Prichard	David L	1858-1917	
260	E R1 G59	Prichard	Elizabeth	1861-1951	
156	HE R12 G56	Prichard	Helena Thelma	1898-1900	
32	H R3 G62	Prichard	Mary Jane	1857-1940	
19	H R2 G37	Prouty	Baby Boy	died 1892	
19	H R2 G37	Prouty	Baby Ethel	died 1895	
19	H R2 G38	Prouty	Chauncey W	1867-1899	
10	H R4 G18	Prouty	Elmer E	1862-1865	
10	H R4 G17	Prouty	Infant Son	23 Dec 1862.	
8	H R4 G16	PROUTY	LARGE	MONUMENT	
10	H R4 G19	Prouty	Sarah E Peck	17 May 1838-9 Apr 1913	
10	H R4 G20	Prouty	Stephen M	14 May 1825-18 Mar 1906	
121	HE R5 G55	Pugh	Ellen	28 Oct 1849 - 27 Jul 1888	
121	HE R6 G55	Pugh	George L	24 jan 1897 - 4 Apr 1875	

121	HE R5 G54	Pugh	John E	21 Feb 1860 - 4 Apr 1920	
121	HE R5 G53	Pugh	Lizzie A	18 Jul 1868 - 28 Oct 1920	
121	HE R5 G52	Pugh	Mary Barre	1904 - 1988	
121	HE R6 G54	Pugh	Ruby Bockhaven	24 Apr 1896 - 15 Oct 1981	DAR #251517
339	HW R6 G25	Pyles	Ronald & James (CR)	R: 1945-1968	

LOT #	SECTION, ROW, GRAVE	LAST	FIRST	DATES	MILITARY
17	GN R7 G31	Rahn	Patricia	1947 - 2019	
308	HW R2 G54	Ransom	Connie S Hess	1951-2012	
308	HW R2 G55	Ransom	Wilbur A	1941-1992	
29	H R2 G60	Ransome	Margaret W	unknown - 7 Oct 1846	
259	E R5 G52	Rathburn	Harold E	1907-1968	
259	E R5 G51	Rathburn	Rebecca I	1911-1987	
143	HE R10 G32	Rawlings	James & Phyllis (CR-1 urn)	1945 - 2003 1937 - 2008	V
424	N R3 G21	Ray	Frances Virginia Myers	1924-1976	
424	N R3 G22	Ray	James Ervin	1924-1981	WWII
72	GW R10 G21	Reece	Janet	1935 -	
72	GW R10 G20	Reece	Richard	1931-2019	
360	LG R9 G5	Reed	Bessie	1887-1974	
228	E R4 G12	Reed	Charlie L Reed	1920-1967	WWI
153	HE R10 G54	Reed	Christina R	1906 - 1991	
228	E R3 G12	Reed	Erma W Maize	1895 -1951	
228	E R3 G13	Reed	Homer C	1896 - 1959	
227	E R2 G13	Reed	Ida M Mays	25 Nov 1873-28 Feb 1931	
360	LG R9 G6	Reed	Lysle Henry	1886-1954	WWI
45B	G R4 G8	Reed	Patricia A	1929-1993	
45B	G R4 G7	Reed	Philip E	1929-2000	K

153	HE R10 G53	Reed	Rev George Corwin	1902 - 1993	
96	GW R4 G15	Reynolds	Donald (CR)	1925-2012	WWII
424	N R4 G23	Reynolds	Gladys Rock	1910-2001	
96	GW R4 G16	Reynolds	Toni Ann	1946 -	
20B	G R8 G20	Rhoades	Annadale Nixon	23 Nov 1916-19 Jul 1992	
20B	G R8 G19	Rhoades	James F "Dusty"	17 Dec 1915-5 May 2004	WWII
19	GN R3 G34	Rhoades	Ronald (Bumpy)	17 May 1947 - 1 Oct 2020	
258	E R4 G54	Ribov	Phillip Leroy	20 Sep 1951 - 19 May 1971	
41	GN R7 G23	Rice	Martha Deel	24 Mar 1934 - 25 Jul 2022	
41	GN R7 G24	Rice	Wilson	1931-2005	
253	E R6 G44	Rider	Hurleigh Hobart	1917-2006	WW II
253	E R6 G43	Rider	Maxine I	1920-1988	
42B	G R7 G10	Rieser	Jack (CR)	1926-1993	WWII
307	HW R4 G51	Rinehart	Elva Lee	1884-1946	
180	NE R7 G5	Rinehart	Evert E	1933-2021	Army
128	GW R4 G4	Rinehart	Fred	1946 -	
180	NE R7 G4	Rinehart	Ina M Jewell	1935 -	
307	HW R4 G52	Rinehart	Nora Davis	1905-1990	
128	GW R4 G3	Rinehart	Susan M	1949 -	
155	HE R9 G59	Rittenhouse	Betty McKim	1916 - 1938	
151	HE R9 G51	Rittenhouse	Hannah	1884-1923	

118	GW R2 G16	Roberson	Norman	1941-2016	V
75	HE R2 G21	Roberts	Ann E Foos	1838-1915	
392	HW R11 G46	Roberts	Barbara (CR)		
75	HE R2 G24	Roberts	Benjamin	1871 - 1893	
38	H R8 G10	Roberts	Benjamin Chidlow	1848 - 1916	CW
131	HE R9 G10	Roberts	Benjamin D	1868 - 1945	
131	HE R10 G11	Roberts	Bert B (CR)	1910 - 1981	WWII
392	HW R12 G45	Roberts	Bessie Jones	1880-1947	
391	HW R9 G46	Roberts	Carl	1909-1988	
392	HW R12 G46	Roberts	Charles A	1876-1935	
392	HW R11 G45	Roberts	Charles F (CR)		
131	HE R9 G11	Roberts	Clarence	1899-1909	
75	HE R2 G23	Roberts	Clarence Mackie	1837 - 1932	
94	HE R4 G61	Roberts	David H	9 Apr 1870 - 4 Oct 1895	
68	HE R4 G9	Roberts	Edward G	29 Nov 1878 - 16 Jun 1946	
94	HE R4 G62	Roberts	Elizabeth	1833 - 1926	
10B	G R21 G23	Roberts	Elizabeth	23 Apr 1925-14 Jan 2005	
120	HE R7 G48	Roberts	Ercell L	5 Apr 1891 - 13 Jan 1980	
391	HW R10 G46	Roberts	Evan E	1862-1936	
58	H R8 G53	Roberts	Gilbert T	died 6 Apr 1881	
360	LG R10 G8	Roberts	Griffith J	1871-1962	

10B	G R21 G24	Roberts	Guy	1916-201	
358	LG R9 G1	Roberts	Harriette "Hattie" Bean	1872-1960	
94	HE R4 G60	Roberts	infant	NO MARKER	
58	H R8 G50	Roberts	Isaac	1816 - 1883	
10B	G R21 G24	Roberts	James W	1949-1991	
120	HE R7 G49	Roberts	Jay		
131	HE R9 G9	Roberts	Jennie Bensley	1874 - 1946	
75	HE R2 G22	Roberts	John	1827 - 1901	
131	HE R10 G8	Roberts	John	1904 - 1976	
68	HE R3 G8	Roberts	John D	1855 - 1907	
94	HE R4 G63	Roberts	John E	1832 - 1909	
38	H R8 G11	Roberts	Katie Curtis	died before 1902	
84	HE R4 G40	ROBERTS	LARGE	MONUMENT	
58	H R8 G51	Roberts	Lettice Jones	1829 - 1911	
84	HE R3 G41	Roberts	Lettice Ludwig	1838 - 1911	
84	HE R3 G42	Roberts	Levi	1823 - 1896	
203	NE R1 G19	Roberts	Martha Thomas	1885-1924	
68	HE R4 G8	Roberts	Maude E	1884-1952	
391	HW R9 G45	Roberts	Myrtle	1903-1976	
391	HW R10 G45	Roberts	Nancy	1868-1939	
70	GN R1 G18	Roberts	Phillip	1943 -	

84	HE R3 G43	Roberts	Rev Arthur G	1880 - 1941	
358	LG R9 G2	Roberts	Robert D	1868-1938	
131	HE R10 G9	Roberts	Ruth Betty (CR)	1921 - 1992	
10B	G R22 G23	Roberts	Ruth Elizabeth Warren	1915-2005	
120	HE R8 G49	Roberts	Sarah P	1866 - 1950	
70	GN R1 G17	Roberts	Sharon	1952 -	
73	HE R2 G20	Roberts	Susie M	1868 - 1948	
203	NE R1 G20	Roberts	Urban Robert	1885-1924	WWI
68	HE R3 G10	Roberts	Victoria E	1859 - 1901	
68	HE R3 G9	Roberts	William J	1880 - 1901	
131	HE R9 G8	Roberts	William T "Bill"	1907-1957	
120	HE R8 G48	Roberts	Wm T	1863 - 1943	
154	HE R12 G50	Robinson	Anna Gallant	1901-1983	
359	LG R8 G7	Robinson	Cecil	1915-2003	
59	H R6 G55	Robinson	Charles	1826 - 1907	CW-No top to the stone
59	H R5 G54	Robinson	Charley S	1885-1918	
359	LG R7 G7	Robinson	Clayton	1887-1959	
359	LG R8 G8	Robinson	Eloise	1918-2015	
59	H R5 G56	Robinson	Emma P	1861-1926	
414	N R3 G4	Robinson	Emmett E	1896-1990	
414	N R3 G3	Robinson	Fannie L	1903-1988	

59	H R5 G57	Robinson	George F	1857-1938	
59	H R5 G55	Robinson	Georgia M	1891-1918	
359	LG R7 G8	Robinson	Glenna May	1887-1985	
319	LG R4 G10	Robinson	John C	1903-1973	
59	H R6 G57	Robinson	Lloyd M	1895-1970	
319	LG R4 G9	Robinson	Margaret	1901-1983	
36	GE R8 G24	Robinson	Richard M "Dick"	1922-2014	WWII
359	LG R7 G6	Robinson	Russell R	1911-1938	
36	GE R8 G23	Robinson	Ruth Frederick	1923 - 2003	
59	H R6 G56	Robinson	Virginia	1897-1978	
42	H R7 G17	Rodefer	Emma Penry	1879-1925	
42	H R8 G18	Rodefer	Harry	1869-1911	
42	H R7 G18	Rodefer	John Wallace	1880-1956	
42	H R8 G20	Rodefer	Martha	1847-1896	
256	E R5 G46	Rodgers	Rex Leroy	16 Feb 1916-5 Dec 1997	
256	E R5 G45	Rodgers	Winifred M Thomas	25 Jun 1917-6 Jun 1997	
109	HE R5 G30	Rodman	Alp Jones	7 Apr 1837 - 7 Aug 1916	CW
45	H R6 G27	Rodman	Alpine C	1890-1970	
439	N R8 G21	Rodman	Barbara L	1937-1985	
109	HE R6 G30	Rodman	Cora Alice	1882 - 1941	
109	HE R5 G31	Rodman	Elizabeth Thomas	1854 - 1939	

9B	G R19 G23	Rodman	George A		
439	N R8 G22	Rodman	Gerald J	1936-2013	
109	HE R5 G29	Rodman	Guy H	1894 - 1958	
439	N R9 G22	Rodman	Harriett L	1900-1971	
109	HE R6 G31	Rodman	Harry Alp	1875-1950	
9B	G R19 G24	Rodman	Hugh Warren	1921-2013	
9B	G R19 G23	Rodman	Leah Hedges	1924-2003	
9B	G R19 G21	Rodman	Lori L	1958-2017	
133	HE R10 G15	Rodman	Mayme Price	1890 - 1912	
45	H R6 G26	Rodman	Nellie P	1890-1976	DAR
439	N R9 G21	Rodman	Raymond A	1905-1972	
111	HE R6 G32	Rodman	Richard	1876-1958	
353	HW R5 G56	Roger	Allen	1942-1947	
381	HW R9 G27	Rogers	Clara Anne Beddow	1939-2004	
381	HW R10 G28	Rogers	Paul Eugene	1950-1950	
381	HW R9 G28	Rogers	Paul Gene	1931-2003	
9B	G R20 G21	Rogers	Rhoda Marie Jewell	1929-1985	
241	E R6 G25	Rollison	Jessica J	5 Dec 1983-3 May 1984	
54	GW R11 G24	Ross	Timothy	1981 -	
200	NE R20 G4	Rouse	Alice Josephine	1912-1992	
216	NE R20 G6	Rouse	Arthur Newton	1885-1929	

100	HE R7 G9	Rouse	Terry A	1956-2019	USMC CPL
216	NE R20 G5	Rouse	Walter D	1909-1976	WWII
393	HW R9 G51	Rowland	Marian A	1861-1934	
393	HW R9 G52	Rowland	Richard S	1871-1940	
220	E R3 G2	Rowland	Simeon Jacob "Sam"	1875-1960	WWI
382	HW R12 G27	Rowlands	Anne	1912-2009	
180	NE R8 G5	Rowlands	George W	1873-1942	
382	HW R12 G25	Rowlands	Hannah	1873-1958	
56	H R8 G46	Rowlands	Martha Jones	1884 - 1921	
180	NE R8 G4	Rowlands	Mary E	1871-1932	
56	H R8 G48	Rowlands	Mollie A	1865 - 1889	
56	H R7 G49	Rowlands	Richard	1806 - 1886	
56	H R8 G49	Rowlands	Richard	died 7 Nov 1883	
56	H R7 G48	Rowlands	Richard B	1837 - 1909	CW
382	HW R12 G26	Rowlands	Richard J	1868-1945	
56	H R8 G47	Rowlands	Robert M	1832 - 1895	
382	HW R12 G28	Rowlands	William E	1909-1997	
56	H R7 G46	Rowlands	Wm R	1879 - 1953	
105	GN R4 G6	Rucker	James	1 Sep 1934 - 13 May 2024	Army Reserve
353	HW R5 G54	Rusher	Mildred A	1913-1994	
353	HW R6 G54	Rusher	Ross M	1888-1971	

336	HW R8 G17	Rusnell	Charles H	1909-2001	
336	HW R8 G18	Rusnell	Fern V	1909-1963	
361	LG R8 G11	Russell	Gail Linneaus	1892-1956	
57B	G R22 G4	Russell	Ina	1921-2010	
361	LG R9 G12	Russell	Nellie E Harsh	1892-1988	
32	GN R8 G25	Russell	Renita Williamson		
361	LG R7 G12	Russell	Richard Harsh	1925-1952	
57B	G R22 G3	Russell	Robert	1915-1989	WWII
32	GN R8 G26	Russell	Ronald Linneaus	1946-2020	
57B	G R21 G4	Russell	Troy David	1966-1995	
41	GN R7 G21	Rye	Steven (CR)	1943-2019	V

LOT #	SECTION, ROW, GRAVE	LAST	FIRST	DATES	MILITARY
404	LG R14 G8	Salathe	Alfred E	1874-1949	
404	LG R14 G7	Salathe	Jennie Jones	1873-1955	
10	GE R4 G34	Salyer	Steve (CR)	1944-2007	
103	HE R5 G19	Sartwell	Ansel	1894-1918	WWI
60B	G R16 G2	Sartwell	Betty J	1930-2013	
60B	G R16 G1	Sartwell	Donald E	1929-2006	K
447	N R12 G13	Sartwell	Geo Allen	1921-1987	WWII
105	HE R6 G20	Sartwell	George Bruce	1885-1935	
103	HE R6 G18	Sartwell	Mary Alice Osborn	1868-1933	
105	HE R6 G21	Sartwell	Millhoan	1921 - 1921	
445	N R12 G11	Sartwell	Monnie M	1913-1991	Fire Dept Volunteer
315	LG R4 G3	Sartwell	Rachel S	1897-1957	
315	LG R4 G2	Sartwell	Thomas A	1892-1954	
315	LG R4 G4	Sartwell	Thomas W	1916-1938	
445	N R12 G12	Sartwell	William S	1912-1964	WWII
103	HE R6 G19	Sartwell	Wm D	1857-1930	
9	H R2 G17	Saunders	Ethel Anna Ward	1880 - 1918	
301	HW R3 G39	Saylor	Billie, Betty (CR)		
301	HW R4 G40	Saylor	Kendall Kenneth	1963-1979	
322	LG R5 G16	Schaeffer	Olen J	1887-1977	

322	LG R5 G15	Schaeffer	Winifred G	1887-1969	
378	HW R11 G19	Scheiderer	Ruth Musser	1910-1983	
378	HW R11 G20	Scheiderer Jr	Ralph	1909-1979	
390	HW R11 G42	Schneck	Maude	1880-1954	
63	GE R8 G12	Schrock	Truman "Jim"	1930-2017	K
60B	G R15 G3	Schuette	Kelly Westbrook	1962-2003	
17B	G R13 G20	Schultz	Daniel Lee	1968-1991	
70	GN R2 G19	Schultz	Katherine	1950 -	
70	GN R2 G20	Schultz	Lawrence	1945-2021	
189	NE R16 G3	Scott	Anna Francis	1884 - 1934	
138	HE R12 G17	Searl	Lena Howard	1844-1923	
7	GN R6 G37	Seemueller	Valerie Milum	1954-2015	
88	GN R7 G5	Segovia	Maya Elisa	2003-2011	
389	HW R9 G44	Seidle	Clyde "Butch"	1950-2019	Marine
377	HW R9 G18	Selanders	Amber Mae Osborn	1904-1961	WWII
377	HW R9 G17	Selanders	Virgil R "Jerry"	1903-1978	
418	N R4 G10	Sellers	Arthur	1899-1978	
418	N R4 G9	Sellers	Nellie E	1909-1987	
399	HW R10 G60	Shannon	Detmer John	1924-1981	
399	HW R10 G59	Shannon	Donna Jean	1925-1986	
250	E R6 G37	Shappard	Judith Kay	1951-1995	

290	HW R2 G19	Shappard	Margaret Maxine	1924-2005	
250	E R6 G38	Shappard	Robert C	14 Jul 1943 -	
184	NE R6 10	Shark	Byron J	1909-1969	
184	NE R6 G8	Shark	Linda	1939-2014	
184	NE R6 G9	Shark	Mildred L	1909-1989	
98	GW R2 G17	Sheets	Cathleen	1956 -	
98	GW R2 G18	Sheets	J Steven	1958 -	
98	GW R2 G16	Sheets	James Lee	1930-2017	K
98	GW R2 G15	Sheets	Mary Lou	17 Sep 1935 -	
49	H R5 G35	Sheldon	Della Moore	1879-1901	
37	GE R7 G18	Shipman	Floyd	1951-2020	
37	GE R7 G17	Shipman	Marilyn M Eastlake	1940 - 2021	
435	N R9 G13	Shirley	Elsie M	1896-1980	
368	LG R10 G21	Shoaf	Albert Horace	1942-1942	
368	LG R9 G21	Shoaf	Edna M	1917-1975	
368	LG R9 G22	Shoaf	Homer R	1911-1988	
3	H R1 G5	Shoaf	Michael Lloyd (CR)	1961-2001	No headstone
367	LG R7 G21	Showalter	Dewey	1938 - 1981	
74	HE R3 G22	Sibole	Clyde	Died 7 May 1961	No headstone
74	HE R3 G21	Sibole	John W		No headstone
235	E R5 G20	Sidenstricker	Jack A	1924-1993	WWII

235	E R5 G19	Sidenstricker	Martha Lee	1923-2015	
293	HW R3 G58	Simpson	Cinda E	1884-unknown	
293	HW R3 G24	Simpson	Levi T	1873-1957	
124	HE R7 G57	Sipes	Margaret	1909-1983	
124	HE R8 G57	Sipes	Robert Lawson	1941-1941	
124	HE R7 G56	Sipes	Wm P	1906-1967	
261	E R4 G58	Sisson	Cecil Richard	1900-1962	
261	E R3 G58	Sisson	Charles R	1932-1960	
75	GW R3 G22	Sisson	Clara	1956 -	
247	E R6 G34	Sisson	Clarence	1916 - 2003	
261	E R4 G57	Sisson	Daisy M Congrove	1905-1997	
75	GW R3 G23	Sisson	Eddie H	1944-2004	V
247	E R6 G33	Sisson	Helen	1914 - 1989	
8B	G R18 G24	Sisson	Marjorie Sparks	1939-2014	
264	E R4 G62	Sisson	Nelson	1908-1985	
258	E R3 G54	Sisson	Oran	1914-1967	WWII
264	E R4 G61	Sisson	Rachel Forrider	1907-1990	
75	GW R4 G22	Sisson	Ray "Gene"	1937-2012	NAVY
258	E R3 G53	Sisson	Warren "Bud"	1914-1975	
44B	G R4 G1	Slagle	Catherine (CR)	-2025	
422	N R3 G20	Smale	Dorence Eugene	1908 - 1973	

422	N R4 G20	Smale	Mary	1913 -	
65B	G R6 G2	Smith	Ardith (CR)	1915-2002	
284	HW R1 G5	Smith	Bertha E	1879-1967	
41B	G R10 G11	Smith	Carolyn (CR)	1931-2019	
13B	G R21 G18	Smith	Edward Rudy (CR)	1908-1997	
4B	G R10 G22	Smith	George	1943-1954	
72	HE R4 G18	Smith	Jacob F	1833-1903	
44	GN R1 G28	Smith	James Carl	1948-2013	
367	LG R8 G22	Smith	Lewis Dillard	1889 - 1979	
65B	G R6 G1	Smith	Lloyd (CR)	1914-1997	
320	LG R6 G12	Smith	Lola B	1897-1970	
72	HE R4 G19	Smith	Louana	1865-1900	
72	HE R4 G17	Smith	M Almira Cone	1837-1916	
44	GN R1 G27	Smith	Mary Ann Morgan	1946 -	
213	NE R14 G12	Smith	Mary Lou Hodges	1915-2005	
336	HW R7 G17	Smith	Nettie L	1878-1963	
336	HW R7 G18	Smith	Nora	1914-1982	
367	LG R8 G21	Smith	Nora B Harris	1889 - 1990	
229	E R5 G12	Smith	Phillip L	1955 -	
41B	G R10 G10	Smith	Robert (CR)	1928-2014	NAVY
244	E R5 G32	Smith	Robert H	1919-1981	

284	HW R1 G6	Smith	Robert S	1880-1956	
229	E R5 G11	Smith	Rose Ella Howard	1958 -	
244	E R5 G31	Smith	Sadie M	1915-1994	
13B	G R21 G17	Smith	Sarah M Jones (CR)	1911-1992	
136	HE R11 G16	Smith	Thomas		
367	LG R7 G22	Smith	Walter W	1914 - 1942	
320	LG R6 G11	Smith	William R	1896-1969	WWII
186	NE R9 G5	Snodgrass	Eva J	1841-1917	
186	NE R9 G6	Snodgrass	Rev John A	1836-1918	CW
32B	G R22 G14	Snyder	Camdon O	1915-2004	WWII
308	HW R2 G53	Snyder	Mandy May	1925-1992	
32B	G R22 G13	Snyder	Mildred Phelps (CR)	1918-2002	
203	NE R1 G17	Sonner	Elsie L	1891-1979	
124	HE R8 G56	Sonner	Esther A	1807 - 1910	
203	NE R2 G18	Sonner	Lewis J	1863-1944	
203	NE R2 G17	Sonner	Mattie (Mrs L J)	1868-1924	
203	NE R1 G18	Sonner	Warren J	1886-1967	
15B	G R17 G20	Sparks	Evelyn Williams	1942-2013	
8B	G R18 G24	Sparks	Glenna Weiss	1917-1997	
8B	G R18 G3	Sparks	Harold Ivan	1915-1988	
15B	G R17 G19	Sparks	Harold R	1945 -	

376	HW R11 G14	Sparks	Jay Prentiss	1943-2019	
376	HW R11 G13	Sparks	Martha Evans	1942-2019	
379	HW R9 G21	Spencer	Alban F	1890-1986	
379	HW R9 G24	Spencer	Barbara J Rinker	1934-2001	
379	HW R10 G23	Spencer	Charlotte J	1941-2022	
379	HW R10 G24	Spencer	David Robert	1957-1960	
379	HW R10 G21	Spencer	Denzel C	1918-1997	
61B	G R14 G4	Spencer	Henry	1927-2005	
61B	G R14 G3	Spencer	Juanite	1933-2017	
379	HW R10 G22	Spencer	Mary Eilene Rodman	1917-1970	
379	HW R9 G22	Spencer	Olive Morris	1893-1983	
233	E R1 G21	Sperry	Wilson Cox	Unkknown - 12 nov 1917	
250	E R5 G39	Spierling	Helen (CR)	1892-1975	
4B	G R9 G23	Spierling	Margaret	1920-1991	
4B	G R9 G24	Spierling Jr	Bill	1922-2001	
76	HE R4 G24	Spradlin	Bobby Joe	1931-1934	
262	E R6 G56	Spradlin	Ralph	1938-1938	
92	GW R12 G13	Stanley	Jay	1934 -	
92	GW R12 G14	Stanley	Mary	1932-2023	
25	GW R6 G34	Stansbery	Jeffrey M	1950-2014	
241	E R5 G25	Stayner	Mary Phyllis	1924-1993	WWII

20	GN R1 G36	Stayner	Blake W. R.	1989 - 2005	
238	E R5 G22	Stayner	Bruce Arthur	1964-2014	Firefighter
241	E R5 G26	Stayner	Edward Arthur	1923-1987	WWII
238	E R5 G21	Stayner	Gwen Spriggs	1964 -	
19B	G R9 G18	Steed	Alice Price	1924 - 2018	
57B	G R22 G1	Steed	David	1917-2001	WWII
19B	G R9 G19	Steed	Neal Pete	1912 - 2004	WWII
57B	G R22 G2	Steed	Sarah Roberts	1911-1989	
356	HW R7 G58	Steitz	Fred	1881-1960	
356	HW R8 G58	Steitz	Hattie E	1864-1933	
356	HW R8 G59	Steitz	Jacob	1859-1956	
356	HW R7 G57	Steitz	Lula	1884-1957	
120	HE R7 G50	Stephens	Mary Elizabeth Jones	1956-1945	
120	HE R7 G51	Stephens	Rev James Vinson	1855-1917	
138	HE R12 G18	Stephenson	Mary Lou Gallant	1908-1999	
338	HW R8 G58	Stewart	Gladys H	1899-1960	
338	HW R8 G24	Stewart	Harry L	1888-1963	
213	NE R14 G9	Stiffler	Earnest J	1900-1910	
213	NE R14 G10	Stiffler	Hattie Elnora	1864-1933	
213	NE R13 G11	Stiffler	Ida Belle	1881-1958	
213	NE R14 G11	Stiffler	John Wesley	1859-1954	

213	NE R13 G10	Stiffler	Mae	1899-1918	
357	LG R7 G3	Stiffler	Marion, Mary Ann & Harry Simerson-infant		
357	LG R7 G4	Stiffler	Raymond R	1890-1947	
357	LG R7 G4	Stiffler	Martha Mae	1914-1937	
213	NE R13 G12	Stiffler	William Henry	1881-1949	
289	HW R3 G13	Stine	Hattie B	1889-1963	
289	HW R3 G14	Stine	Lawrence W	1886-1962	
357	LG R8 G1	Stock	Katharine	1936-2016	
357	LG R8 G1	Stock	Otto	1935-2021	
224	E R1 G11	Stone	Bernice M Hylton	1906-1943	
159	HE R10 G67	Stonebraker	George	1865 - 1923	
33B	G R24 G15	Strohl	Janice		
33B	G R24 G16	Strohl	Lowell L	1931-2015	K
237	E R3 G26	Stuart	Dallas Paul	1874-1932	WWII
237	E R3 G25	Stuart	Hulda F Milligan	1907-1984	
321	LG R3 G13	Stuart	Willa Jean Osborne "Billie"	1936-2005	
321	LG R3 G14	Stuart	William D "Bill"	1932-1997	K
246	E R3 G35	Stutler	Bertha Viola, Baby Boy, Hillary, Isiah all		
232	E R5 G14	Stutler	Carrie M Mattox	1923-1985	
246	E R3 G38	Stutler	Charles B (CR)	1953-2011	
232	E R5 G13	Stutler	Clayton (CR)	1922-2013	

246	E R3 G36	Stutler	Eloise Hawkins	1935-2018	
246	E R3 G37	Stutler	George	1932-1994	
246	E R4 G38	Stutler	John Albert	1901-1989	
246	E R4 G37	Stutler	Mary B Pearson	1907-1973	
208	NE R4 G21	Styer	Mary H	1883-1965	
208	NE R4 G20	Styer	Webb L	1880-1963	
177	NE R2 G5	Sullivan	Marilyn Arlene	1937-2025	
22B	G R3 G20	Sutherland	Jim H	1940-1998	
22B	G R3 G20	Sutherland	Jim H	1940-1998	
22B	G R3 G19	Sutherland	Monica K	23 Aug 1928 -	
420	N R3 G16	Swan	Edward O	1921-1998	WWII Purple Heart
420	N R3 G15	Swan	Gladys P	1926-2022	
132	HE R11 G7	Swearingin	Ernest W	1909-1963	
132	HE R11 G6	Swearingin	Joseph	1850-1922	
132	HE R11 G8	Swearingin	Nina Mae Fraley	1901-1981	
132	HE R11 G5	Swearingin	Phoebe Sendeldecker	1850-1917	
132	HE R12 G7	Swearingin	Ernest W--Infant	unknown-1908	

LOT #	SECTION, ROW, GRAVE	LAST	FIRST	DATES	MILITARY
357	LG R8 G3	Taft	Mary E	1892 - 1979	
52B	G R18 G7	Tate	Mary Anne	1947-2008	
435	N R10 G15	Taylor	Blanche W	1897-1981	
432	N R5 G14	Taylor	Chester	1918 0 2004	
412	LG R14 G21	Taylor	David Warren, on back of Warren L	1944-1948	
428	N R6 G5	Taylor	Freta B Clark	1917 - 1977	
432	N R5 G13	Taylor	Jewell M Gray	1922 - 2019	
428	N R6 G6	Taylor	John N (CR)	1915 - 2001	
53B	G R19 G5	Taylor	June		
53B	G R19 G8	Taylor	Mary L	22 Feb 1919-27 Aug 2012	
41B	G R10 G9	Taylor	Nancy K	25 Sep 1908-31 Jan 2018	
432	N R6 G13	Taylor	Paul Clayton "Corky"	1949 - 1976	
435	N R10 G14	Taylor	Paul E	1906-1985	
412	LG R13 G21	Taylor	Warren L	1921-2002 Buried Hephzibah Cemetery, Byromville GA	WWII
100	HE R8 G11	Thomas	Ada Mohr	12 Jun 1883 - 25 Mar 1936	
20	H R3 G40	Thomas	Arden James	3 Nov 1903 - 6 May 1918	
100	HE R8 G8	Thomas	BABY		
127	HE R5 G64	Thomas	Benjamin	1831-1909	
97	HE R5 G4	Thomas	Benjamin Lewis	1883 - 1955	

62	GE R8 G15	Thomas	Billy	1952-2021	
304	HW R2 G48	Thomas	Carl Raymond	1905-1968	
98	HE R8 G7	Thomas	Charles Albert	1888 - 1914	
191	NE R1 G16	Thomas	Cicero	1893-1970	
401	LG R11 G1	Thomas	Daniel E	1952 - 1998	
100	HE R7 G10	Thomas	David "Davy"	1929-2002	K
366	LG R10 G19	Thomas	David Henry	1889-1952	WWI
366	LG R10 G20	Thomas	David O	1939 - 1939	
26B	G R10 G14	Thomas	David R	1924-1994	WWII
100	HE R8 G10	Thomas	David R	1885-1941	
304	HW R2 G46	Thomas	Dianne (CR)	1943 -	
267	E R3 G64	Thomas	Edwin E	1893-1983	
20	H R4 G38	Thomas	Elizabeth		
17	H R1 G35	Thomas	Elizabeth A	1846-1898	
98	HE R7 G6	Thomas	Ethel	1882-1956	
366	LG R9 G17	Thomas	Evelyn	1940-1988	
191	NE R2 G16	Thomas	Everett	1920-1931	
97	HE R6 G6	Thomas	Flora Faye Cumston	1910-1992	
401	LG R12 G1	Thomas	Florence Horn	1896-1983	
401	LG R12 G3	Thomas	George Robert	1926-2006	WWII
401	LG R12 G1	Thomas	George William	1897-1982	

402	LG R13 G2	Thomas	Govern Olive Jones	1891-1980	
77	HE R3 G31	Thomas	Grace H	1894 - 1983	
98	HE R7 G4	Thomas	Hannah Louise	1914-1926	
100	HE R7 G9	Thomas	Helen Ramsey Cox Rouse	1929-2004	
26B	G R9 G14	Thomas	Howard	1921-2010	
98	HE R8 G6	Thomas	Howard W	1898-1919	
364	LG R9 G16	Thomas	I Pauline	1899-1980	
83	HE R1 G25	Thomas	infant	1887 - 1887	
70	HE R3 G12	Thomas	infant		NO headstone
304	HW R1 G48	Thomas	J Eddy	1936-2015	
247	E R6 G35	Thomas	James (CR)j sp Kathleen	buried 2025	
20	H R4 G39	Thomas	James		
386	HW R12 G33	Thomas	James Garfield	1885-1952	WWI
191	NE R2 G14	Thomas	James Harold	1926 - 1926	
386	HW R12 G36	Thomas	James R	1863-1939	
402	LG R13 G3	Thomas	James R	1890-1970	
285	HW R3 G7	Thomas	James Willey	1885-1960	
98	HE R8 G4	Thomas	Jane	1853 - 1937	
100	HE R8 G9	Thomas	Jessie May Morton	11 Dec 1885 - 1908	
20	H R4 G37	Thomas	John	1858-1930	
97	HE R5 G6	Thomas	John	1827 - 1908	

247	E R6 G35	Thomas	Kathleen (CR) sp James	buried 2025	
77	HE R3 G29	Thomas	Laura Smart	1900 - 1929	
386	HW R12 G35	Thomas	Lavina Feaster	1863-1955	
437	N R9 G17	Thomas	Lieselotte	19 Aug 1926 - 1 Oct 2000	
191	NE R2 G15	Thomas	Mabel Jones	1937-1938	
285	HW R3 G8	Thomas	Mae H	1886-1964	
70	HE R4 G14	Thomas	Margaret E	22 Feb 1857 - 16 Dec 1929	
364	LG R10 G15	Thomas	Margaret E Schnek	1875-1959	
26B	G R10 G15	Thomas	Mary	1920-2020	Wife of Wm. Buried in
97	HE R5 G5	Thomas	Mary A Rowlands	1850-1927	
401	LG R12 G2	Thomas	Mary Anne Jones	1928-2006	
26B	G R9 G15	Thomas	Mary E	1919-2001	
200	NE R19 G2	Thomas	Mary E	1883-1966	
83	HE R1 G26	Thomas	Mary Hillery	1860 - 1947	
26B	G R10 G15	Thomas	Mary Rachel	1926-2021	
304	HW R2 G46	Thomas	Melanie (CR)		
34B	G R24 G9	Thomas	Miriam S	1918-2010	
304	HW R1 G48	Thomas	Monte J	1956-1973	
191	NE R1 G15	Thomas	Nellie F Shaeffer	1897-1972	
437	N R9 G18	Thomas	Nelson L	15 Jul 1931 - 12 Oct 1989	V
304	HW R2 G47	Thomas	Ortola E Eddy	1904-1985	DAR #435164

97	HE R5 G7	Thomas	Paul Aaron (Cr)	1935 - 2012	ARMY
366	LG R10 G18	Thomas	Pauline M Rutherford	1895-1981	
98	HE R7 G7	Thomas	Richard D	1875-1943	
364	LG R10 G16	Thomas	Richard Walter	1872-1954	
366	LG R9 G18	Thomas	Robert A	1920-1988	WWII
70	HE R4 G15	Thomas	Robert M	1857 - 1932	
34B	G R24 G10	Thomas	Robert W	1918-2005	WWII
267	E R4 G63	Thomas	Ronald Elwin	1936-1973	
17	H R1 G34	Thomas	Russell	1838-1915	
100	HE R7 G11	Thomas	Ruth A	1916 - 1978	
304	HW R2 G46	Thomas	Sarah (CR)	1939-2009	
127	HE R5 G66	Thomas	Sarah Coonfare	24 Feb 1832 - 26 Apr 1904	
77	HE R3 G30	Thomas	Steven (CR)	1951 - 2021	
97	HE R6 G7	Thomas	Thomas Paul	22 Aug 1887 - 29 Jul 1959	WWI
267	E R3 G63	Thomas	Verna Crystal Evans	16 May 1895 - 13 Oct 1970	
290	HW R1 G20	Thomas	Walter	1910-1955	
85	HE R1 G28	Thomas	Walter C	1901 - 1981	
386	HW R12 G34	Thomas	Wealthia	1893-1953	
98	HE R8 G5	Thomas	William J	1852 - 1927	
83	HE R1 G27	Thomas	Wm	1856 - 1907	
200	NE R19 G3	Thomas	Wm E	1873-1943	

100	HE R7 G9	Thomas	Helen Ramsey Cox Rouse	1929-2004	
26B	G R10 G13	Thomas	Wm (CR)	1917-2001	
298	HW R2 G33	Thrush	Ava (Clinton (CR)	1880-1948	
118	GW R1 G14	Thrush	Donna Vining	1950-2012	
298	HW R1 G34	Thrush	infant (CR)		
298	HW R1 G35	Thrush	Lois Geneen (CR)	1919-1994	
298	HW R1 G36	Thrush	Robert (CR)	1917-1990	WWII
298	HW R2 G34	Thrush	William R	1887-1962	
419	N R2 G16	Timmons	Geraldean Drake	28 Mar 1934 - 2 Jan 2014	
419	N R2 G14	Timmons	Geraldine "Jerry M"	1911-1999	
392	HW R12 G48	Timmons	James E	1865-1935	
419	N R1 G13	TIMMONS S	LARGE	MONUMENT	
392	HW R12 G47	Timmons	Millard F	1853-1936	
419	N R2 G15	Timmons Jr	John Franklin	20 Oct 1932 - 12 Jul 2022	K
419	N R2 G13	Timmons Sr	John Franklin	1902-1981	
396	HW R11 G54	Timms	Gertrude W Wilson	1883-1955	
396	HW R12 G53	Timms	Helen	1920-2016	
396	HW R11 G55	Timms	James Oscar	1867-1946	
396	HW R12 G56	Timms	John Wilson	1911-1953	
396	HW R12 G54	Timms	Robert E	1916-1999	
396	HW R11 G53	Timms	Sarah Elizabeth	1913-1995	WWII

396	HW R11 G56	Timms Jr	James Oscar	1910-1933	
192	NE R3 G15	Todd	Albert Judson	16 Jul 1848 - 21 Nov 1924	
250	E R5 G38	Tolle	Delbert C	8 Apr 1915-6 Sep 1986	
250	E R5 G37	Tolle	Lillian M	24 oct 1918-22 Oct 1985	
433	N R7 G11	Townsley	Betty "Terry" Aldridge	1929 - 1979	
433	N R7 G11	Townsley	Carl Marker	1929-2015	ARMY
361	LG R7 G9	Tucker	Emma B	1887-1972	
361	LG R7 G10	Tucker	Halbert B	1887-1940	

LOT #	SECTION, ROW, GRAVE	LAST	FIRST	DATES	MILITARY
242	E R1 G34	Utz	John Finley	1838-1921	CW
242	E R1 G33	Utz	Livonia Ann Cone	1841-1930	

LOT #	SECTION, ROW, GRAVE	LAST	FIRST	DATES	MILITARY
284	HW R1 G8	Van Brimmer	Adrianna W	1907-1973	
231	E R3 G18	Van Brimmer	Donald C	1930-2013	K
37	H R5 G10	Van Brimmer	Frank T	1862-1931	
444	N R12 G10	Van Brimmer	George	1904-1985	
37	H R5 G12	Van Brimmer	Helen	1895-1902	
37	H R5 G9	Van Brimmer	Infant Eva	1893-1894	
284	HW R2 G8	Van Brimmer	John	1927-2000	
37	H R5 G11	Van Brimmer	Millie Mary E	1863-1916	
231	E R3 G17	Van Brimmer	Naoma Belle Hawkins	1936-2018	
284	HW R2 G7	Van Brimmer	Pauline	1925-2011	
33	GE R1 G27	Van Brimmer	Sharon Ann Barnes	1948-2018	
284	HW R1 G7	Van Brimmer	Thomas Lee	1906-1956	
444	N R12 G9	Van Brimmer	Wilda	1913-1992	
68B	G R2 G2	Van Brimmer Sr	Walter J	1932-2001	K
5B	G R11 G24	Vigar	Richard V	1923-1999	WWII
5B	G R11 G23	Vigar	Rose M	1985-2001	

LOT #	SECTION, ROW, GRAVE	LAST	FIRST	DATES	MILITARY
12B	G R23 G18	Waddell	Paul	1917-1980	
12B	G R23 G17	Waddell	Roger Lee	1942-1996	
242	E R1 G35	Waggone r	Carrie C Utz	1878-1967	
290	HW R2 G20	Wallace	George	1899-1958	
349	HW R5 G46	Wallace	Gerald L	1910-1976	
349	HW RE5 G47	Wallace	Jessie Elizabeth	1889-1941	
349	HW R5 G48	Wallace	William W	1884-1956	
375	HW R9 G16	Walter	Alice J	1929-2025	
12B	G R24 G18	Walter	Arthur D	29 Mar 1919-16 Jun 1999	
375	HW R9 G15	Walter	Avery	1928-1961	
8	GN R8 G36	Walter	Carl (CR)	1942-2016	
12B	G R24 G17	Walter	Ruth Seitz	3 Jun 1921-21 Mar 2015	
9	H R1 G18	Ward	Ellen L	1854-1930	
103	HE R5 G17	Ward	Emma	11 Oct 1829 - 23 Dec 1909	
9	H R1 G19	Ward	William	1851-1931	Army Natl Guard
285	HW R4 G8	Warnock	Marcus	1912-1992	
285	HW R4 G7	Warnock	Vesta	1914-1980	
350	HW RE8 G47	Warren	Carrie B	1869-1945	
350	HW R8 G48	Warren	Eugene A	1875-1961	
264	E R3 G59	Warren	Maude Pinney	1884-1931	

264	E R3 G60	Warren	Walter W	1796-1883	
27	H R1 G54	Watkins	Benjamin	1849-1909	
28	H R3 G55	Watkins	Charlena Hults	1843-1928	
397	HW R9 G58	Watkins	Charles M	1863-1949	NO Headstone
269	E R1 G72	Watkins	Charles R	1863-1949	
269	E R1 G71	Watkins	Grace	1879-1954	
405	LG R12 G1	Watkins	Charlotte Ann Osborn	1927-2005	
405	LG R11 G9	Watkins	David Dale	1922-1996	WWII
27	H R2 G55	Watkins	David E	1867-1916	
27	H R1 G55	Watkins	Edward	1815-1896	
384	HW R12 G29	Watkins	Edward J	1902-1961	
269	E R2 G71	Watkins	Elizabeth	1905-1936	
393	HW R9 G49	Watkins	Grace	1883-1956	
269	E R1 G71	Watkins	Grace F	1879-1954	
140	HE R12 G21	Watkins	Hannah Gallant	1873-1961	
405	LG R12 G11	Watkins	Harold (infant)		
405	LG R12 G10	Watkins	Harold Vernon	1928-2017	K
405	LG R11 G10	Watkins	Irma Margaret Thomas	1896-1981	
35	H R5 G8	Watkins	Izates	1887-1939	
27	H R1 G57	Watkins	Jane Williams	1821-1866	
12	H R3 G24	Watkins	John D	1906-1907	

35	H R5 G7	Watkins	Loverna M	1891-1982	
27	H R2 G54	Watkins	Margaret J	1873-1927	
12	H R3 G23	Watkins	Mary E	1878-1963	
405	LG R11 G12	Watkins	Mary Louise	1896-1942	
405	LG R11 G11	Watkins	Merald Edward	1895-1970	
384	HW R12 G30	Watkins	Ottie Ilo Reed	1906-1996	
393	HW R9 G50	Watkins	Raymond	1871-1949	
384	HW R11 G29	Watkins	Raymond Lee	1945 - 1945	
384	HW R11 G30	Watkins	Robert C	1932 - 1989	K
52	H R8 G40	Watkins	Rosetta Osborn	1866 - 1889	
27	H R1 G56	Watkins	Sarah Evans	1827-1899	
34	GE R3 G27	Watkins	Teresa		
28	H R3 G56	Watkins	Thomas	1843-1909	CW
28	H R3 G57	Watkins	Thomas	died 11 Mar 1877	
28	H R3 G54	Watkins	William	1869-1896	
34	GE R3 G28	Watkins	William "Mike"	1951-2012	
12	H R3 G22	Watkins	William J	1877-1968	
5	H R1 G11	Weaver	Ida A	1872-1952	
5	H R1 G12	Weaver	Walter S	1866-1941	
83	GE R7 G6	Webb	George W	1923-2009	WWII
83	GE R7 G5	Webb	Lucille White	1927-2007	

74	GW R5 G19	Weber	David K	1965 -	
74	GW R5 G22	Weber	Robert L	1930-2021	
74	GW R5 G21	Weber	Ruby Hedges	1928-2016	
74	GW R5 G20	Weber	Elizabeth Sellers	1965 -	
29	GN R1 G29	Wedemeyer	Sheree L Shuster	1973-2006	
102	HE R8 G12	Weis	Vesta Dix	1828 - 1970	
66	GE R1 G13	Welch	Tammy	1961 -	
95	GW R5 R18	Wells	Dwight	1958 -	
262	E R6 G55	Wells	Earl	died 7 Aug 1939	
95	GW R5 G17	Wells	Pamela	1958 -	
62B	G R12 G1	Welsh	Harold	1923-2003	WWII
62B	G R12 G2	Welsh	Virginia	1922-2008	
248	E R2 G42	West	Patricia A Quillen	1945-2020	
348	HW R8 G44	Wheeland	Albert Eugene	1925-1994	WWII
348	HW R8 G43	Wheeland	Ruth Edna	1926-2019	
57B	G R21 G1	Whelan	Mary Beas (CR)	1925-2008	
57B	G R21 G2	Whelan IV	Martin T	1923-1992	WWII
137	HE R10 G20	White	Anna	1864 - 1952	
137	HE R10 G21	White	Ernest C	1863 - 1925	
59B	G R18 G3	White	Frances Presstari	1939-2020	
59B	G R17 G4	White	Ronald Charles (CR)	1962-2016	

59B	G R18 G4	White Sr	Richard A	1936-1993	
	G R17 G15	Wigg	Milton		V
306	HW R1 G52	Willey	Dale E (CR)	1912-2007	
306	HW R2 G50	Willey	Edna G	1897-1945	
306	HW R2 G52	Willey	Eulacleve (CR)	1913-2001	
306	HW R2 G51	Willey	Frankie May Jones	1874-1943	Under the bush
1	H R1 G1	Williams	Alice	1875-1949	
316	LG R6 G4	Williams	Charles Case	1874-1960	
32B	G R22 G16	Williams	Clarence Lee	1907-2004	
50	H R7 G35	Williams	Daisy Margaret	1878-1912	
21	H R2 G43	Williams	David D	1848-1907	
50	H R7 G36	Williams	David Thomas	1867-1959	
1	H R1 G4	Williams	Edith M	1880-1910	
51	H R5 G38	Williams	Edward D	unknown - 1893	
428	N R6 G4	Williams	Eleanor M	1918-2000	
22	H R4 G42	Williams	Eliza R Lewis	1836-1928	
32B	G R20 G15	Williams	Geneva	1909-2000	
316	LG R6 G3	Williams	Geneva Iola Lehman	1872-1938	
21	H R1 G43	Williams	George P	1876-1960	
51	H R5 G39	Williams	George W	1823-1904	
1	H R2 G4	Williams	Gilbert	1888-1955	

55B	G R23 G7	Williams	Glen E	1922-1989	WWII
51	H R5 G40	Williams	Hannah	1827-1896	
90	HE R4 G53	Williams	Homer Benjamin	1858-1941	
390	HW R12 G42	Williams	Hosea	1884-1955	
51	H R6 G38	Williams	J Mason	1849-1929	
31	H R1 G62	Williams	Jane Davis	1811-1893	
111	GN R3 G2	Williams	Janet L	1950 -	
50	H R8 G37	Williams	Jennie S	1865 - 1895	
21	H R2 G45	Williams	John Ellis	1880-1915	
50	H R8 G34	Williams	John O	15 Mar 1831 - aft 1865	CW
90	HE R4 G52	Williams	Josephine Trembley	1860-1927	
55B	G R24 G5	Williams	Lelah A Scott	1921-2010	
32B	G R19 G15	Williams	Linda	died about 1985	
90	HE R4 G54	Williams	Lydia Coonfare	1822 - 1902	
50	H R8 G35	Williams	Margaret	1836 - 1893	
21	H R2 G44	Williams	Mary A	1852-1926	
1	H R1 G2	Williams	Mary J	1853-1929	
390	HW R12 G41	Williams	Merle Irene	1892-1938	
51	H R5 G41	Williams	Minnie B	1861-1889	
21	H R1 G44	Williams	Nettie	1874-1950	
55B	G R24 G6	Williams	Paul W	1919-2008	

31	H R1 G63	Williams	Richard	1813-1885	
1	H R1 G3	Williams	Robert	1846-1918	CW
55B	G R23 G8	Williams	Sarah E Devore	1925-2022	
22	H R3 G41	Williams	Sarah J Potts	1896-1992	
111	GN R3 G1	Williams	Timothy Alan	1957 - 2018	
1	H R2 G1	Williams	Wesley R	1882-1945	
90	HE R4 G55	Williams	William J	21 Mar 1819 - 15 Oct 1909	CW
22	H R4 G41	Williams	William L	1876-1966	
50	H R8 G36	Williams	William O	1870 - 1891	
21	H R2 G42	Williams	William T	1872-1898	
22	H R4 G43	Williams	William W	1835-1907	
1	H R2 G3	Williams	Hazel Schaeffer	1896 - 1924	
71	HE R10 G14	Williams on	Braden W "Brad" (CR)	1960-2025	
439	N R8 G24	Williams on	James R	1933-1986	
439	N R9 G23	Williams on	Thomas J	1957-1969	
118	GW R2 G13	Wilson	Jack K (CR)	1919-2012	WWII
50	GW R4 G26	Wilson	Laura B	1944-	
118	GW R1 G13	Wilson	Mary Paugh		
49B	G R12 G8	Wilson	Rev Frank H	1920 - 1995	
50	GW R4 G25	Wilson	Rev Robert T (CR)	1936-2016	V
49B	G R12 G7	Wilson	Vivian Clinebell	1922 - 2007	

68B	G R2 G5	Windle	Karen	1941 -	
69B	G R2 G6	Windle	Philip LeRoy	18 Apr 1939-19 Jul 1990	Army
297	HW R3 G29	Winsor	Florence Peters	1918-1963	
99	HE R6 G10	Winston	Myrtle Morris	1890 - 1923	
99	HE R6 G11	Winston	Thomas Leon	3 Sep 1894 - 18 Jan 1923	
215	NE R18 G6	Wittlinger	Cordie S	1889-1964	
61	H R5 G58	Wolfley	Ellen Curren	1848-1922	
57	H R6 G51	Wolfley	George Toot	1837-1927	CW
398	HW R12 G58	Wolfley	George W	1894-1962	WWI
398	HW R11 G60	Wolfley	Harvey W	1862-1933	
398	HW R12 G57	Wolfley	Hazel (CR)	1895-1999	
57	H R6 G52	Wolfley	Hettie Ellen	1880-1921	
61	H R5 G59	Wolfley	John Mac	1848-1881	
61	H R5 G60	WOLFLEY	LARGE	MONUMENT	
57	H R6 G53	Wolfley	Louisa Darst	1839-1916	
398	HW R11 G58	Wolfley	Margaret	1895-1970	
398	HW R11 G59	Wolfley	Mary W	1860-1938	
57	H R5 G53	Wolfley	Nannie Belle	1869-1935	
22B	G R3 G17	Wood	Dale Leon	1926-2015	WWII
88	HE R3 G49	Wood	Ida Smailes	unknown - 1886	
107	GN R7 G2	Wood	Kenneth L	1933-2004	

107	GN R7 G1	Wood	Nancy	1947-2017	
22B	G R3 G18	Wood	Norma Jane	1932-2019	
88	HE R3 G50	Wood	Timothy	1850 - 1936	
362	LG R9 G12	Woyan	Jesse James	1902-1965	
362	LG R10 G12	Woyan	Jesse Jr	1926-1941	
362	LG R9 G11	Woyan	Retha Marie Mayes	1905-2002	
119	GW R2 G11	Wray	Frederika	1944-2016	
119	GW R2 G12	Wray	Glen	1932-2014	
286	HW R1 G10	Wright	Arba	1878-1955	
33B	G R24 G14	Wright	Earl Dane	1907-1985	WWII
33B	G R24 G13	Wright	Ella F Gandee	1914-2007	
33B	G R24 G14	Wright	Ernest F on back of bro Earl Dane	1909-1988	WWII
450	N R10 G21	Wright	Harold David	1938-2020	
286	HW R1 G9	Wright	James F	1876-1959	
286	HW R2 G10	Wright	John O	1917-2007	Navy
450	N R10 G20	Wright	Kenny Wayne (CR)	10 Sep 1993 - 20 Oct 1993	
33B	G R23 G15	Wright	Theodore	1935-2007	
286	HW R2 G9	Wright	Theresa	1918-1987	
96	GW R3 G16	Wyant	Edrafaye Roberts	1922-2004	
96	GW R3 G15	Wyant	James (CR)	1921-2010	WWII

LOT #	SECTION, ROW, GRAVE	LAST	FIRST	DATES	MILITARY
312	LG R2 G7	Zane	Betty	1907 - 1993 same stone as brothers Elwyn & Thomas	
312	LG R2 G6	Zane	Elwyn Jonathan	1900 -1974	
312	LG R2 G8	Zane	Jonathan "John"	1836-1946	
312	LG R2 G5	Zane	Mae	1878-1950	
312	LG R2 G7	Zane	Thomas Arlington	1901-1974	
385	HW R10 G34	Zeigler	Charles	1900-1981	
385	HW R10 G36	Zeigler	Edward	1871-1943	
342	HW R7 G29	Zeigler	Eveleen Grubaugh	1912-2006	
385	HW R10 G35	Zeigler	Fannie	1876-1968	
342	HW R8 G58	Zeigler	Gertrude Carnes	1917-1965	
385	HW R9 G35	Zeigler	Marguerite	1904-1996	
342	HW R8 G29	Zeigler	Paul Edward	1911-2003	
385	HW R9 G36	Zeigler/Ziegler	William	1902-1945	
130	HE R11 G3	Ziegler	Florence Evans	1891-1968	
130	HE R11 G4	Ziegler	Lowell	1892-1951	
3B	G R8 G21	Zimmerman	Edward	1927 -	
3B	G R8 G22	Zimmerman	Suzanne	1951-1986	
25	GW R6 G31	Zivoder	Helen DuBois	1919-2008	

25	GW R6 G32	Zivoder	Matthew	1907-2001	WWII